



Buffers Lane, Leatherhead, KT22

Offers Over £270,000

 2  2  1



****VIRTUAL TOUR**** This contemporary, purpose-built ground floor apartment is ideally located near Leatherhead train station, the town center, and local business parks. Stylishly presented throughout, the property features an open-plan lounge and kitchen area, with patio doors that lead directly to a private patio. The layout includes a master bedroom with an ensuite shower room, a second double bedroom, and an additional bathroom.

The apartment also offers an allocated parking space, extra visitor parking and a secure telephone entry system.

The property is also an excellent investment opportunity, it is estimated to rent for approximately £1,500 per month.

Key Features

- VIRTUAL TOUR AVAILABLE
- Two bedrooms
- Allocated parking
- Close to Leatherhead town centre and main line station
- EPC energy rating C (79)
- Ground floor apartment
- Two bathrooms
- Direct access to private patio area
- Large open plan kitchen-living space
- Hard flooring throughout

Buffers Lane, Leatherhead, KT22

Approximate Gross Internal Area 59 sq m / 635 sq ft

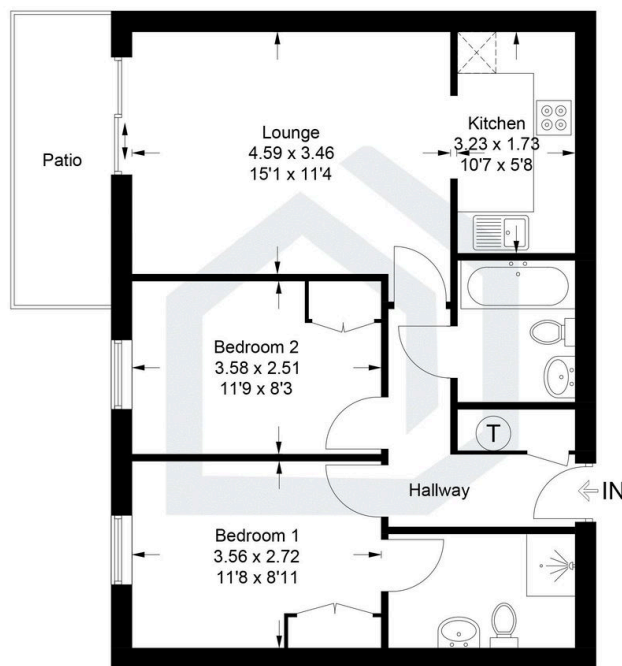

Ground Floor

Illustration for identification purposes only, measurements are approximate, not to scale. floorplansUsketch.com © (ID1145919)