



**Pacey
Wingent
Dickson®**

INDEPENDENT PROPERTY AGENTS

*Helping the perfect property find you...
...time is precious. Let's not waste it!*

Lindfield Gardens, Guildford, GU1

Guide Price £375,000

🛏 2 🚿 1 🛋 1

- Chain free
- 1st Floor
- Balcony
- Close to excellent schools
- Superb location just across from Stoke Park
- Two bedroom apartment
- Spacious rooms and great storage
- Immaculate communal gardens
- Easy access to A3/A31/M25
- Within easy reach of Guildford town centre and train stations



NO ONWARD CHAIN

This beautifully presented two-bedroom apartment offers bright, exceptionally spacious accommodation throughout and is ideally located within a short walk of Guildford's Stoke Park and town centre.

Set on the first floor, the property boasts a generous kitchen with ample storage and space for a breakfast/dining table, alongside a superb reception room that opens through twin doors onto a private L-shaped balcony. Both bedrooms are huge doubles, each benefitting from built-in wardrobes, while additional storage is available throughout the flat. The bathroom is complemented by a separate cloakroom for convenience. The property further enjoys immaculate communal gardens, ample residents' on-street parking, and a bright, airy feel with excellent natural light, making this a rare opportunity to purchase a spacious, well-located apartment



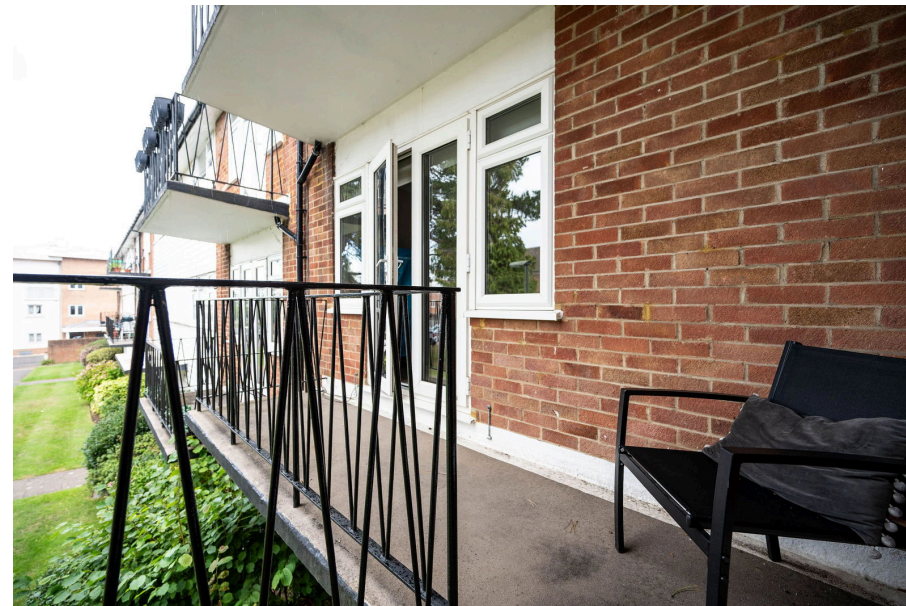

Lindfield Gardens, Guildford, GU1 1TS

Approximate Gross Internal Area = 81.1 sq m / 873 sq ft

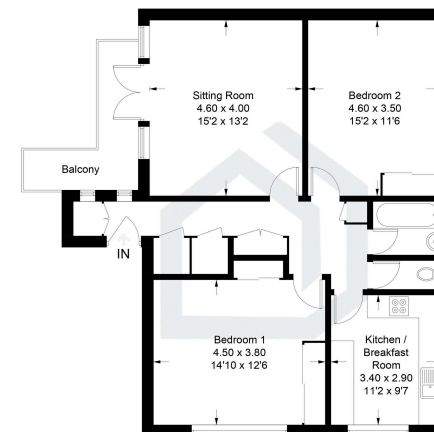

Illustration for identification purposes only, measurements are approximate, not to scale. Fourstate.co.uk (01238644)