

Cannon Hill Lane, London, SW20

£1,600PCM (Deposit: £1,846)

🛏 2 🚿 1 🛋 1

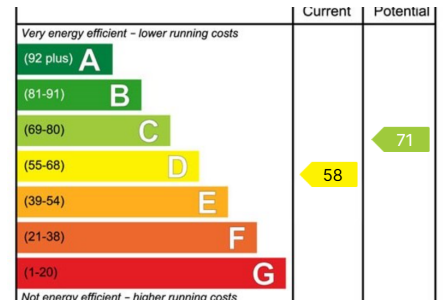

Tax Band: B Furnished: Furnished

A modern two-bedroom first-floor apartment on Cannon Hill Lane in West Wimbledon. This recently redecorated property features two spacious double bedrooms and a well-equipped open-plan kitchen/living area. Conveniently located near Wimbledon Chase and Raynes Park mainline stations, it offers excellent bus links and easy access to local amenities.

Key Features

- Two double bedrooms
- 1st floor flat
- Furnished
- Bright and spacious
- Open-plan kitchen/living room with dual aspect
- Gas central heating
- Double glazing
- Moments from South Merton, Wimbledon Chase and Raynes Park mainline stations
- Close to Local Amenities of Morden and Raynes Park
- On road parking available nearby

Cannon Hill Lane, London, SW20 9BZ

Approximate Gross Internal Area = 56.0 sq m / 603 sq ft

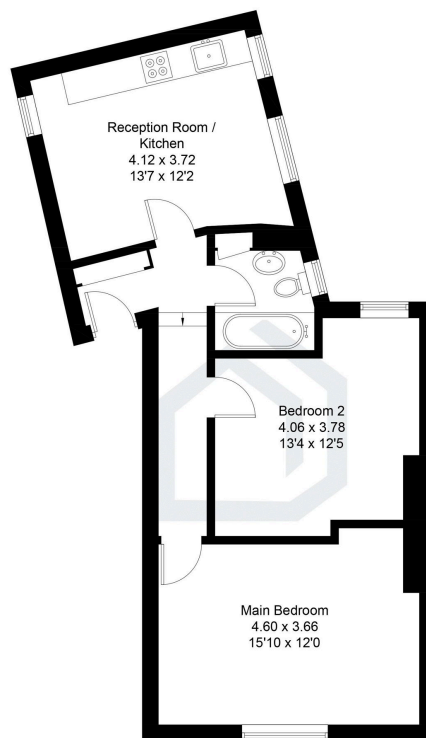

First Floor

Illustration for identification purposes only, measurements are approximate, not to scale. floorplansUsketch.com © (ID1110052)