

BRUNTON

RESIDENTIAL

T. 0191 236 8347
E. info@bruntonresidential.com
A. 125 St George's Terrace, NE2
W. 2DN
bruntonresidential.com



Foster Drive

St James Village Gateshead, NE8 3JG

Available - 9th December 2025- £850pcm - immaculate 2 double bedroom first-floor apartment with easy access to the A1 and local transport links. the property comes with gas central heating and double glazing, external off-street parking is available. Call today to arrange a viewing

£850 PCM

14 Foster Drive

St James Village Gateshead, NE8 3JG



[Full description](#)

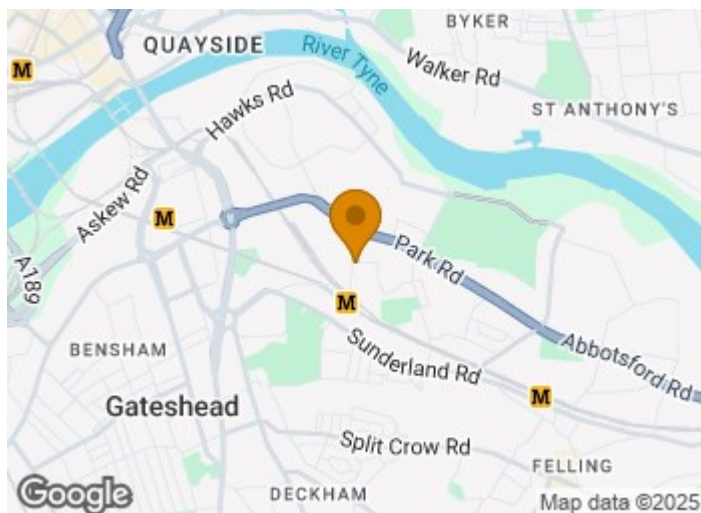

- Available 9th December 2025
- Opposite Gateshead Stadium
- Open plan living/kitchen
- EPC rating B
- Rent £850pcm
- Popular Location of St. James Village
- Allocated Parking
- 2 bed apartment
- Modern decor throughout
- Easy Access to Transport & Road Links



Floor Plan

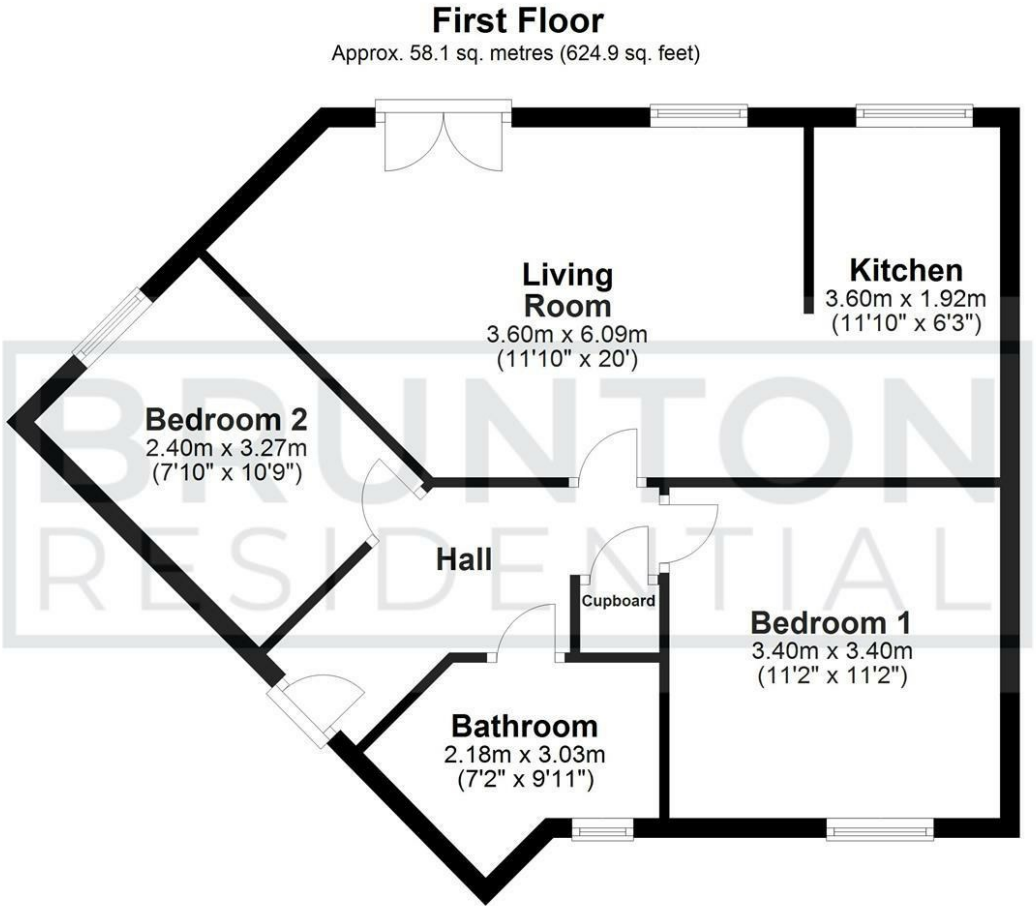

Total area: approx. 58.1 sq. metres (624.9 sq. feet)

All measurements are approximate and are for illustration only.
Plan produced using PlanUp.

These particulars, whilst believed to be accurate are set out as a general outline only for guidance and do not constitute any part of an offer or contract. Intending purchasers should not rely on them as statements of representation of fact, but must satisfy themselves by inspection or otherwise as to their accuracy. No person in this firms employment has the authority to make or give any representation or warranty in respect of the property.

Energy Efficiency Rating				Environmental Impact (CO ₂) Rating			
Very energy efficient - lower running costs		Current	Potential	Very environmentally friendly - lower CO ₂ emissions		Current	Potential
(82 plus) A				(82 plus) A			
(61-81) B				(61-81) B			
(49-60) C				(49-60) C			
(35-48) D				(35-48) D			
(29-34) E				(29-34) E			
(21-28) F				(21-28) F			
(1-20) G				(1-20) G			
Not energy efficient - higher running costs				Not environmentally friendly - higher CO ₂ emissions			
England & Wales		EU Directive 2002/91/EC		England & Wales		EU Directive 2002/91/EC	