



Elmwood Mews, North Gosforth, NE13 6PW

Offers Over £190,000

TWO BEDROOM BUNGALOW - QUIET LOCATION - EXTENDED TO REAR

Brunton Residential are delighted to offer this two bedroom bungalow located on Elmwood Mews in the quiet North Gosforth estate which is situated in between Wideopen and Gosforth. This home has been extended to the rear and is available without forward chain.

Brunton Residential are delighted to offer this two bedroom bungalow located on Elmwood Mews in the quiet North Gosforth estate which is situated in between Wideopen and Gosforth. This home has been extended to the rear and is available without forward chain. The property is situated to the Southern end of Wideopen providing easy access to the A1 and A19 link roads. Lots of local shops, pubs & cafes are located in the immediate area with central Gosforth and Newcastle City Centre a short distance away. Accommodation briefly comprises; Entrance hallway with access to an open plan lounge area with windows to front, there is a door leading to a conservatory which has rear access to the garden. situated at the front of the property is a double width kitchen which is fully fitted and has a dining area with views over the front gardens. There is a master bedroom with space for wardrobes, a second bedroom and a bathroom WC with four piece suite including walk in shower and bathtub.

Externally there is private gardens everywhere you look! To the front is a gate which leads from the front street and drive area, it passes by the garage which has an up and over door and side door, beyond the garage is the front garden which is laid mainly to lawn and has pathway access to the front door. To the rear is another lawned garden with planted areas and fenced boundaries. A driveway offers off street parking.

Hallway

Lounge

12'3" x 9'4" (3.73m x 2.84m)

Kitchen/Dining Room

8'10" x 13'10" (2.70m x 4.22m)

Sun Room

16'9" x 6'7" (5.11m x 2.00m)

Bedroom

13'8" x 6'5" (4.16m x 1.95m)

Bedroom

9'10" x 9'10" (3.00m x 3.00m)

Bathroom

Garage

Disclaimer.

The information provided about this property does not constitute or form part of an offer or contract, nor may it be regarded as representations. All interested parties must verify accuracy and your solicitor must verify tenure/lease information, fixtures & fittings and, where the property has been extended/converted, planning/building regulation consents. All dimensions are approximate and quoted for guidance only as are floor plans which are not to scale and their accuracy cannot be confirmed. Reference to appliances and/or services does not imply that they are necessarily in working order or fit for the purpose.

Floor Plan

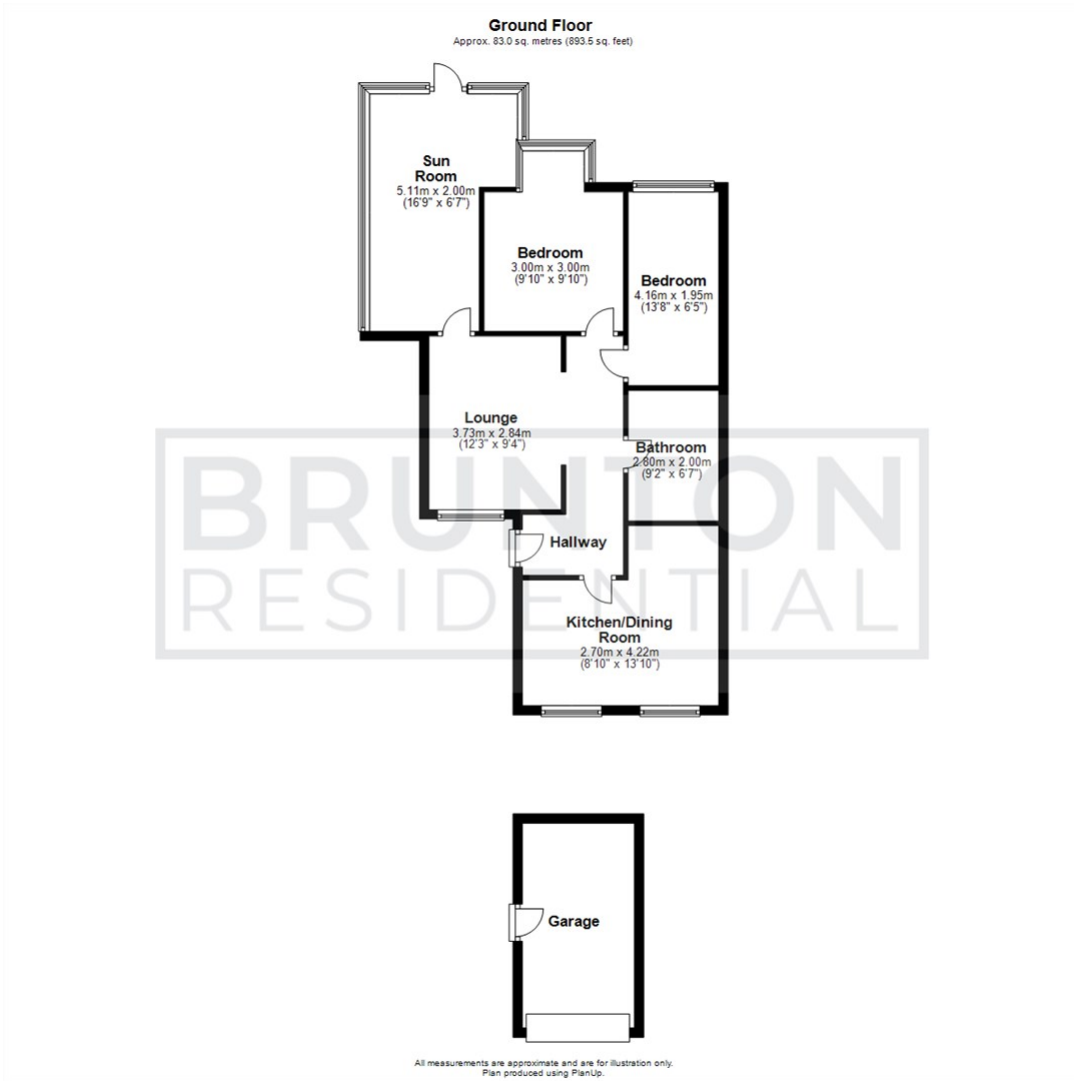

Area Map



Energy Efficiency Graph

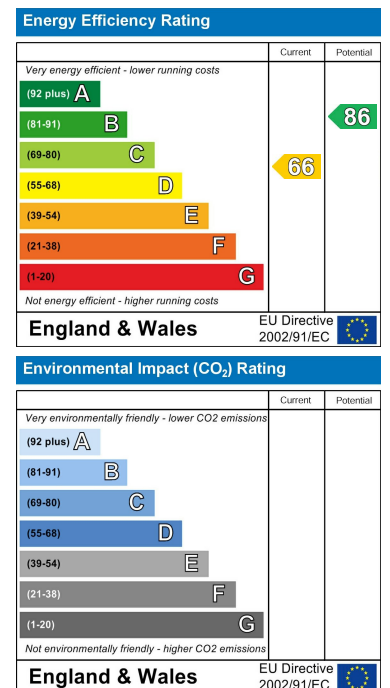

These particulars, whilst believed to be accurate are set out as a general outline only for guidance and do not constitute any part of an offer or contract. Intending purchasers should not rely on them as statements of representation of fact, but must satisfy themselves by inspection or otherwise as to their accuracy. No person in this firm's employment has the authority to make or give any representation or warranty in respect of the property.