

T. 01912368347  
E. info@bruntonresidential.com  
A. Brunton Residential Middleton  
W. South, Wagonway Drive, NE13  
9RT



## Greville Gardens

Great Park, NE13 9DN

PERSIMMON SWALE - THREE BEDROOMS - END TERRACE

Brunton residential are delighted to offer for sale this three bedroom townhouse located on Greville Gardens in Great Park. This popular build is positioned to the end of a terrace which provides the benefit of a wider garden and a top floor Dormer style window.

# 60 Greville Gardens

Great Park, NE13 9DN



Brunton residential are delighted to offer for sale this three bedroom townhouse located on Greville Gardens in Great Park. This popular build is positioned to the end of a terrace which provides the benefit of a wider garden and a top floor Dorma style window.

The accommodation briefly comprises of; entrance hall, lounge, breakfasting kitchen with access to rear gardens & a WC. The first floor consists of two bedrooms and a modern family bathroom while the top floor boasts a large master bedroom with ample storage.

Externally there are gardens to the rear are mainly lawned with a paved area and have fenced boundaries. A driveway to the front provides off-street parking.

Great Park is situated to the North of Newcastle Centre and offers easy access North and south via the A1, Newcastle City Centre, Newcastle Airport and Newcastle Racecourse.

For more info and to book viewings, please call our Great Park team on 0191 2368347.

## ON THE GROUND FLOOR

Hall

Lounge

15'0" x 9'1" (4.57m x 2.77m)

Kitchen

8'11" x 12'0" (2.72m x 3.67m)

WC

3'9" x 4'4" (1.15m x 1.32m)

Bedroom

7'9" x 12'0" (2.36m x 3.67m)

Bathroom

## ON THE FIRST FLOOR

Bedroom

25'11" x 8'7" (7.90m x 2.61m)

Disclaimer.

## ON THE FIRST FLOOR

Bedroom

8'11" x 12'0" (2.72m x 3.67m)



- THREE BEDROOMS
- GREAT LOCATION
- DRIVEWAY
- END TERRACE
- FRONT & REAR GARDENS
- PERFECT FIRST TIME BUY





## Floor Plan

**Ground Floor**  
Approx. 33.4 sq. metres (359.2 sq. feet)

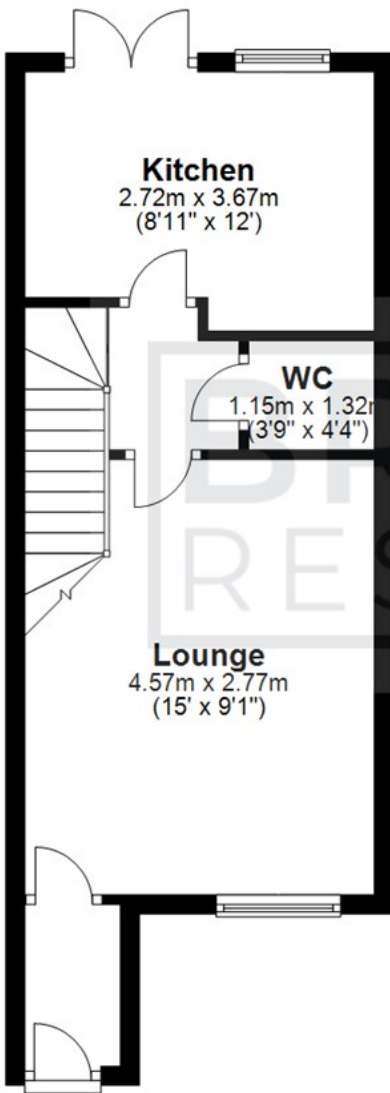

**First Floor**  
Approx. 30.9 sq. metres (332.8 sq. feet)

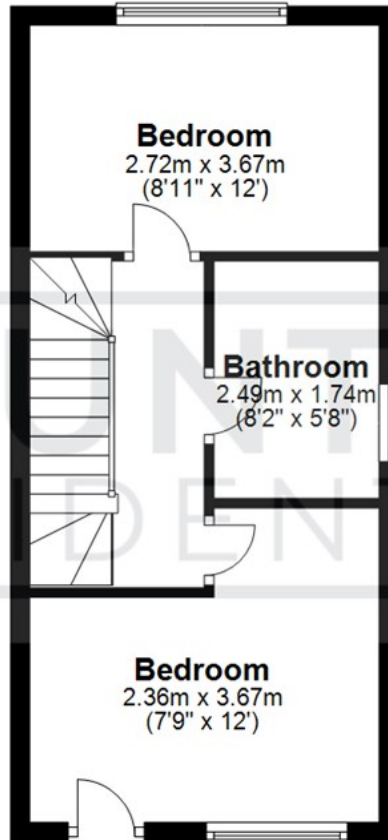

**Second Floor**  
Approx. 29.0 sq. metres (312.0 sq. feet)



All measurements are approximate and are for illustration only.  
Plan produced using PlanUp.

These particulars, whilst believed to be accurate are set out as a general outline only for guidance and do not constitute any part of an offer or contract. Intending purchasers should not rely on them as statements of representation of fact, but must satisfy themselves by inspection or otherwise as to their accuracy. No person in this firm's employment has the authority to make or give any representation or warranty in respect of the property.

