

# BRUNTON

---

## RESIDENTIAL

T. 01912368347  
E. info@bruntonresidential.com  
A. Brunton Residential Middleton  
W. South, Wagonway Drive, NE13 9BJ



## Dataller Drive

### Havannah Park Hazlerigg, NE13 7FY

SEMI DETACHED HOME - THREE BEDROOMS - FANTASTIC CONDITION

Brunton Residential are delighted to offer for sale this Bellway home located on Dataller Drive within the popular Havannah Park development. Havannah Park is nearing its completion and this property type is now sold out, this home offers three bedrooms with two bathrooms and is available for immediate viewing.

**£250,000**

# 57 Dattler Drive

Havannah Park Hazlerigg, NE13 7FY



The property is in an excellent condition and has accommodation which briefly comprises; Entrance porch with access to the lounge, the lounge has a window to the front and a door to the rear leading to the rest of the property. An inner hallway provides a separate WC along with a staircase to the first floor. The kitchen is positioned to the rear of the property and spans the properties full width, it offers windows and French doors over the rear gardens. The kitchen offers a range of wall and floor units with coordinated work surfaces and some fitted appliances.

The first floor offers an impressive master suite positioned to the rear, the bedroom has a fitted wardrobe to one side while to the other is a stylish ensuite shower room with walk in shower. There are two further well sized bedrooms along with a family bathroom WC.

Externally there is a lawned garden to the front with pathway access to the property while the driveway provides off street parking and access to the garage.

The rear garden is also laid mainly to lawn, it has planted and gravelled areas with raised beds and fenced boundaries.

## ON THE GROUND FLOOR

Hall

WC

Lounge

13'9" x 12'2" (4.20m x 3.70m)

Kitchen/Dining Room

9'10" x 20'0" (3.00m x 6.10m)

Garage

## Master Bedroom

9'11" x 15'5" (3.03m x 4.70m)

En-suite

9'11" x 4'3" (3.03m x 1.30m)

Bedroom

11'4" x 10'4" (3.45m x 3.15m)

Bedroom

7'5" x 9'4" (2.26m x 2.85m)

Bathroom

6'7" x 6'7" (2.00m x 2.00m)

## ON THE FIRST FLOOR

Landing

Disclaimer

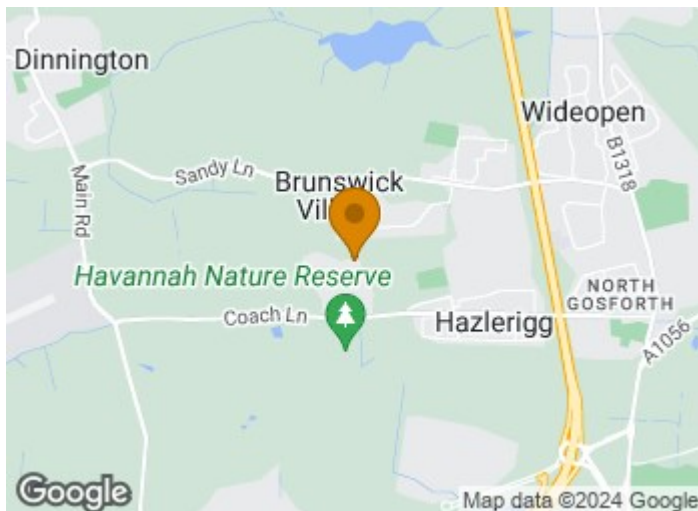

- SEMI DETACHED
- THREE BEDROOMS
- FRONT & REAR GARDENS
- GARAGE & DRIVEWAY
- GREAT LOCATION
- FAMILY BATHROOM & ENSUITE



## Floor Plan

### Ground Floor

Approx. 53.1 sq. metres (571.3 sq. feet)

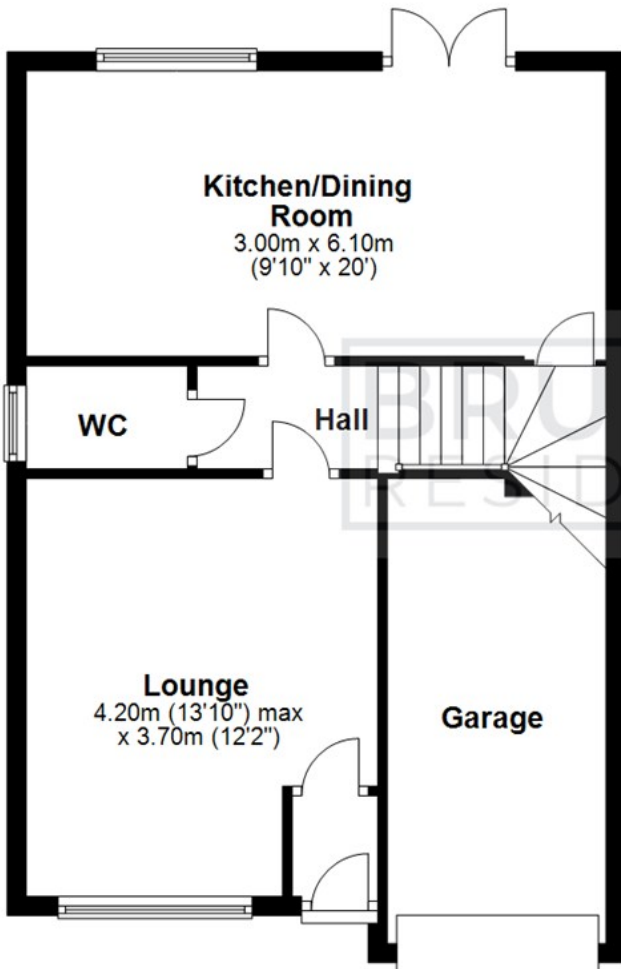

### First Floor

Approx. 50.0 sq. metres (538.7 sq. feet)

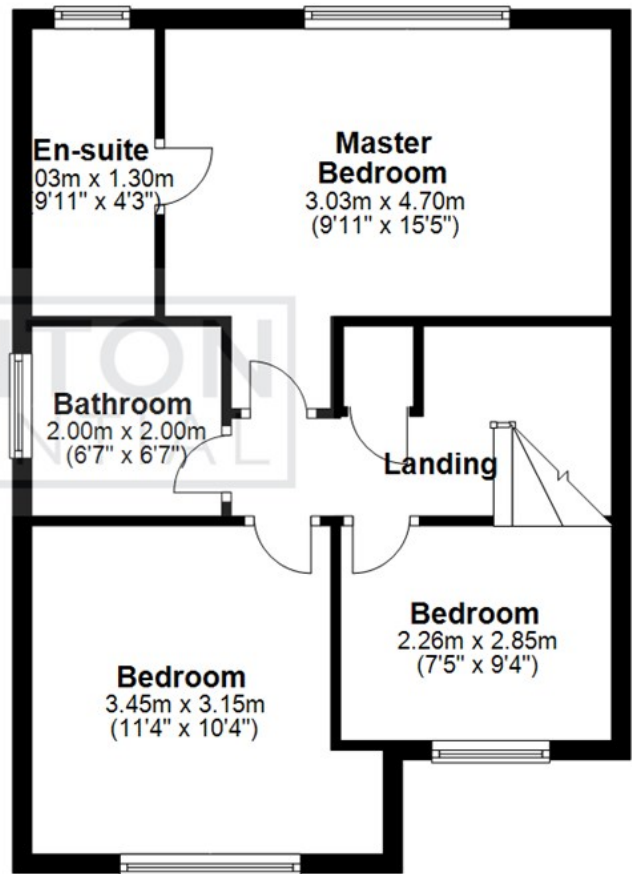

Total area: approx. 103.1 sq. metres (1110.0 sq. feet)

All measurements are approximate and are for illustration only.  
Plan produced using PlanUp.

These particulars, whilst believed to be accurate are set out as a general outline only for guidance and do not constitute any part of an offer or contract. Intending purchasers should not rely on them as statements of representation of fact, but must satisfy themselves by inspection or otherwise as to their accuracy. No person in this firm's employment has the authority to make or give any representation or warranty in respect of the property.

