

# BRUNTON

---

RESIDENTIAL



**HUNTERS LODGE, FAIRMOOR, MORPETH NE61**

**£850,000**



# BRUNTON

---

## RESIDENTIAL









# BRUNTON

---

## RESIDENTIAL





# BRUNTON

---

## RESIDENTIAL



Substantial, Stone Built Detached Family Home Boasting Three Excellent Reception Rooms, Stylish Open Plan Kitchen/Diner, Four Double Bedrooms Suites, Ground Floor Study/Snug, Wonderful Open Aspect Views, Private Landscaped Gardens, Large Multicar Driveway with Detached Annex.

Hunters Lodge, is a superb and detached stone-built residence was designed and constructed by the current owner in 2013 and is perfectly placed within Fairmoor, Morpeth. The property is perfectly tucked away, offering a great deal of privacy and seclusion.

Fairmoor itself, is situated in a semi-rural location and is placed towards the outskirts of the desirable market town of Morpeth with its excellent shops, restaurants and amenities. The property is also well placed to provide access to outstanding local state schooling with independent schooling located only 20 minutes away.

The property benefits from well-maintained mature gardens, and is nestled in Fairmoor, which is a quiet hamlet situated just to the northwest of Morpeth. The location provides all the benefits of immediate access to magnificent Northumberland countryside along with quick and easy links to the A1 for commuting and travel into Newcastle City Centre and throughout the region.

Set within the boundary of the Morpeth Green Belt, Hunters Lodge offers you a rare opportunity to purchase an individually designed home of the highest quality, boasting wonderful views over lovely open fields and mature woodland.



# BRUNTON

---

## RESIDENTIAL





# BRUNTON

---

## RESIDENTIAL

Boasting nearly 4,000 Sq ft of internal living space, the internal accommodation comprises: A stunning contemporary entrance door opens to a lobby with bespoke fitted storage and double doors leading to the central reception hall.

The reception hall offers access to all reception rooms with a central staircase leading to the first floor and access to a ground floor guest cloakroom/WC.

Double doors then lead into the first of three reception rooms, which is laid out as a formal sitting with tri-aspect windows and dual French doors opening to the terrace and gardens. The sitting room also enjoys a beautiful stone fire surround with stone flooring.

To the rear of the hallway is a generous and lovely lounge/family room, again with dual French doors leading to the gardens and stone fire surround. This room also offers double doors connecting into the dining room.

Good sized dining room, which again enjoys dual French doors leading out onto the rear gardens, with stone flooring and double doors leading back to the central entrance hall.

The ground floor also provides access to a beautiful, modern open plan kitchen/diner with contemporary high gloss cabinetry, integrated 'De Dietrich' appliances with a large central island, dual dishwashers and Corian worktops. The kitchen/diner also offers dual French doors opening out onto both the rear gardens and front driveway.

Doors from the rear of the kitchen/diner lead into both a ground floor study with French doors and into a utility room with plant room cupboard and door to rear.

The stairs then lead up to the first-floor landing with Velux window and onto four double bedroom suites, all with access to en-suite facilities. The principal suite is generous in size and offers a large double bedroom with vaulted ceiling and a door leading into a dressing room and a substantial en-suite bathroom with five-piece suite, including a free-standing bathtub and his and hers sinks.

The landing then leads into three further double bedrooms. Bedroom two enjoys a private, en-suite shower room with bedrooms three and four both sharing an en-suite shower room with Jack and Jill doors.

Externally, the property enjoys a 0.35 Acre plot, which is accessed via a long private driveway that leads to a large, block paved multi-car driveway. The driveway gives access to a detached, stone built garage/annex with dual garage doors and glazed window. This space is extremely versatile and offers space for a home studio/office or potentially could offer accommodation for visiting relatives.

The side and rear gardens offer a mixture of lawned and paved entertaining areas, with a mixture of stone walled and fenced boundaries with high hedging and a lovely, water feature to the rear.

Well-presented throughout, with double glazed windows and underfloor heating to both the ground and first floor, this excellent home simply demands an early inspection, and viewings are strongly advised.





# BRUNTON

## RESIDENTIAL

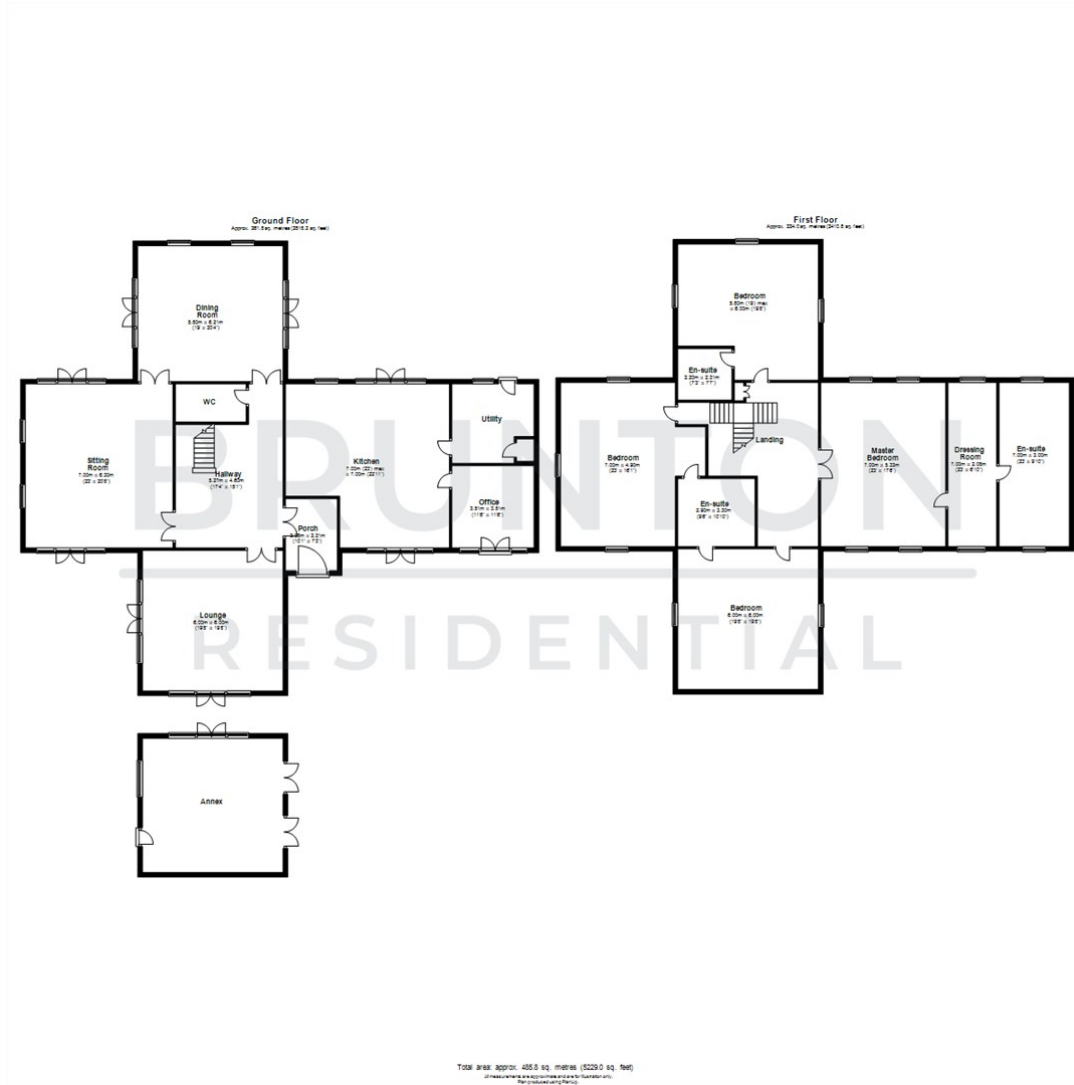

Total area approx. 453 sq. metres (5220 sq. feet)  
(This area includes the area occupied by the main house and the garage.)

TENURE : Freehold

LOCAL AUTHORITY :

COUNCIL TAX BAND :

EPC RATING :

SERVICES :



Energy Efficiency Rating		Current	Potential
Very energy efficient - lower running costs			
(92 plus) <b>A</b>			
(81-91) <b>B</b>			
(69-80) <b>C</b>			
(55-68) <b>D</b>			
(39-54) <b>E</b>			
(21-38) <b>F</b>			
(1-20) <b>G</b>			
Not energy efficient - higher running costs			
England & Wales		EU Directive 2002/91/EC	

Environmental Impact (CO <sub>2</sub> ) Rating		Current	Potential
Very environmentally friendly - lower CO <sub>2</sub> emissions			
(92 plus) <b>A</b>			
(81-91) <b>B</b>			
(69-80) <b>C</b>			
(55-68) <b>D</b>			
(39-54) <b>E</b>			
(21-38) <b>F</b>			
(1-20) <b>G</b>			
Not environmentally friendly - higher CO <sub>2</sub> emissions			
England & Wales		EU Directive 2002/91/EC	