

T. 01912368347
E. info@bruntonresidential.com
A. Brunton Residential Middleton
W. South, Wagonway Drive, NE13
9RT



Akenshaw Drive

Seaton Delaval, NE25 0FN

FOUR BEDROOM - PERFECT FAMILY HOME - GREAT LOCATION

Brunton Residential are delighted to offer this Semi-Detached home located on Akenshaw Drive within Seaton Delaval. This four bed, three bathroom property would make a great family home.

Offers Over £220,000

24 Akenshaw Drive

Seaton Delaval, NE25 0FN



This spacious property briefly comprises: entrance hall with a separate WC. There is a lounge with window to front and a dining room through the walk way with French doors leading to a large, spacious back garden, a kitchen space to the left of the dining room offers a range of wall and floor units with coordinated work surfaces with additional units.

The top floor master bedroom features a window overlooking the front garden and an en-suite shower room, there are built in wardrobes for storage space. The landing also features a storage cupboard. On the first floor, bedroom two features a tiled en-suite. Bedrooms three and four have use of the family bathroom WC. To the front is a small garden with pathway access to the property and garage access which has a gate leading to the back garden, also to the rear is a large space which offers a range of lawned and paved areas with fenced boundaries.

On the ground floor

Hallway

WC

Living Room

15'1" x 10'10" (4.60m x 3.30m)

Dining Room

10'10" x 10'10" (3.30m x 3.30m)

Kitchen

10'10" x 9'0" (3.30m x 2.75m)

On the first floor

Landing

Storage

Bedroom 1

9'6" x 11'3" (2.90m x 3.42m)

En-suite

6'7" x 8'4" (2.00m x 2.55m)

Bedroom 2

10'10" x 8'8" (3.30m x 2.65m)

Bathroom

Bedroom 3

8'4" x 11'3" (2.54m x 3.42m)

On the third floor

Main Bedroom

12'4" x 11'5" (3.75m x 3.48m)

Storage

En-suite

3'8" x 7'8" (1.11m x 2.33m)

Disclaimer

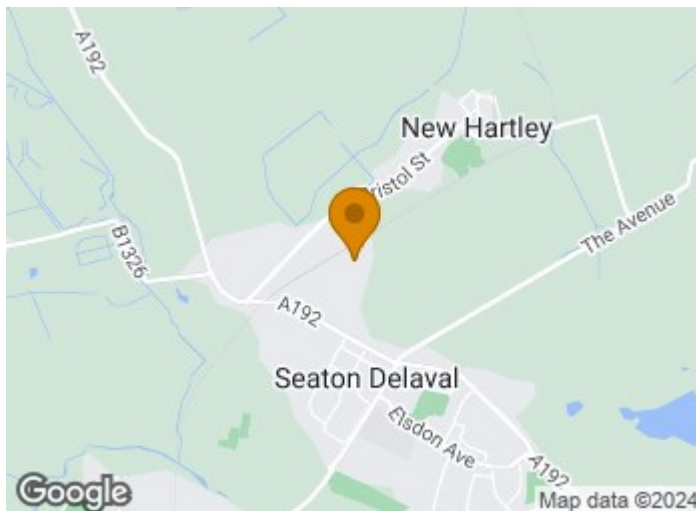

- FOUR BEDROOMS
- GREAT LOCATION
- 360 VIRTUAL TOUR
- GARAGE
- DINING AREA
- SEMI-DETACHED
- THREE BATHROOM

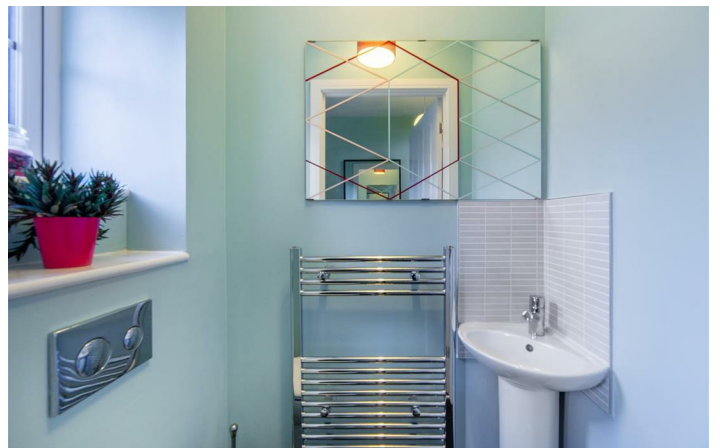

Floor Plan

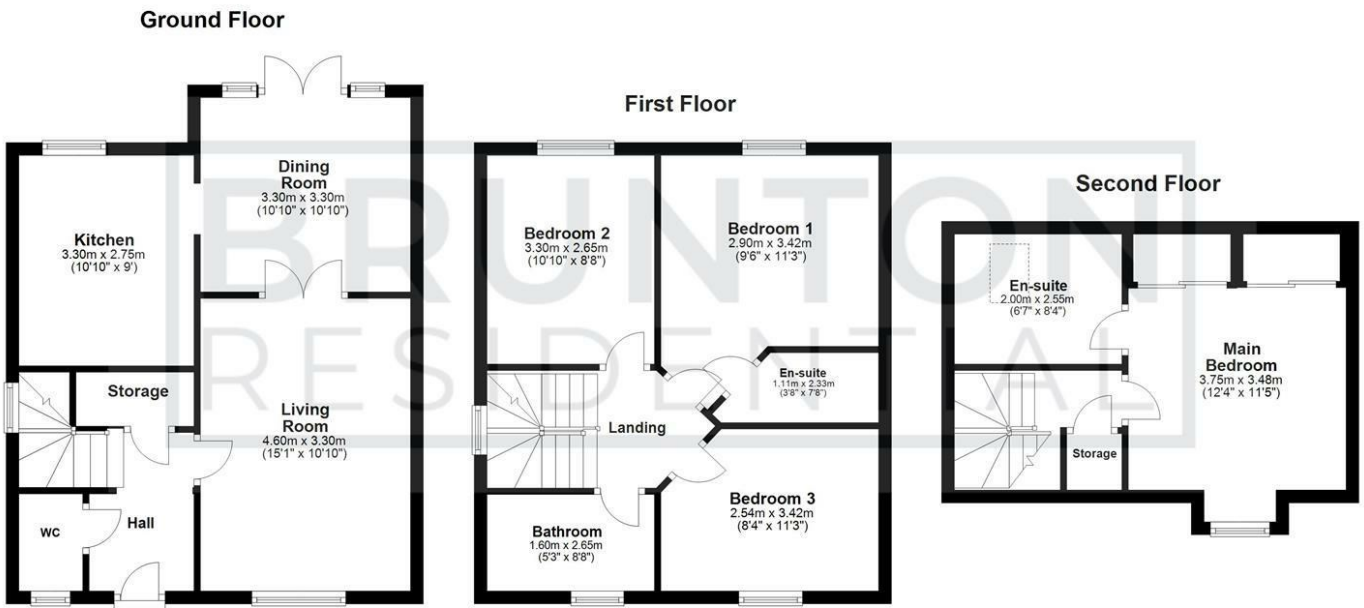

All measurements are approximate and are for illustration only.
Plan produced using PlanUp.

These particulars, whilst believed to be accurate are set out as a general outline only for guidance and do not constitute any part of an offer or contract. Intending purchasers should not rely on them as statements of representation of fact, but must satisfy themselves by inspection or otherwise as to their accuracy. No person in this firm's employment has the authority to make or give any representation or warranty in respect of the property.

