

T. 01912368347
E. info@bruntonresidential.com
A. Brunton Residential Middleton
W. South, Wagonway Drive, NE13
9RT



Deuchar Street

Jesmond, NE2 1JX

SOUGHT AFTER LOCATION - THREE BEDROOM - GROUND FLOOR APARTMENT

Brunton Residential are delighted to offer this stunning three bedroom apartment located in Jesmond. This well presented home offers a newly fitted kitchen with built in appliances, a large lounge and back yard to the rear. Situated in a popular location 1.6 miles from the City Centre of Newcastle.

Offers Over £220,000

27 Deuchar Street

Jesmond, NE2 1JX



Accommodation briefly comprises; entrance, porch & hallway, a lounge & kitchen area. The lounge offers expansive living spaces, balancing sophistication with comfort. A thoughtfully crafted floor plan ensures versatility, providing an ideal canvas for both leisure and social engagements. Spacious sitting area leading to the kitchen which has been recently renovated and offers a range of fitted wall and floor units, coordinated work surfaces and some fitted appliances. Further accommodation includes a large double bedroom with bay window to the front. The second bedroom is also large enough to accommodate a double bed and towards the rear of the property is The third bedroom, though slightly smaller, is thoughtfully designed to maximize space efficiency without compromising on comfort. Ideal for guest rooms, a home office, or a cozy retreat, these rooms add versatility to the residence. The modern bathroom features a bath/shower and toilet, the property further benefits with a private yard to the rear.

ON THE GROUND FLOOR

Porch

Hall

Living Room

15'3" x 14'5" (4.65m x 4.40m)

Kitchen

12'0" x 9'6" (3.65m x 2.90m)

Bedroom 1

10'10" x 15'7" (3.30m x 4.75m)

Bedroom 2

15'3" x 8'4" (4.65m x 2.55m)

Bedroom 3

7'9" x 10'8" (2.35m x 3.25m)

Bathroom

5'1" x 12'2" (1.55m x 3.70m)

Disclaimer

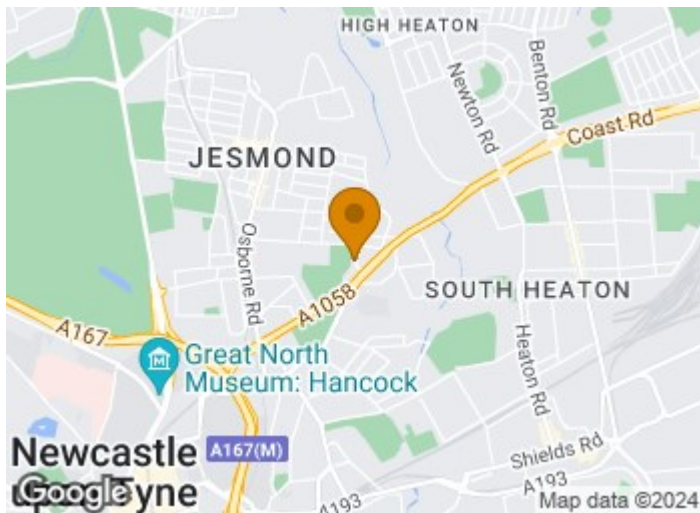

- GROUND FLOOR APARTMENT
- 360 VIRTUAL TOUR
- FANTASTIC CONDITION
- JESMOND
- SOUGHT AFTER LOCATION
- THREE BEDROOM
- COUNCIL TAX BAND B



Floor Plan

Ground Floor

Approx. 80.3 sq. metres (864.1 sq. feet)

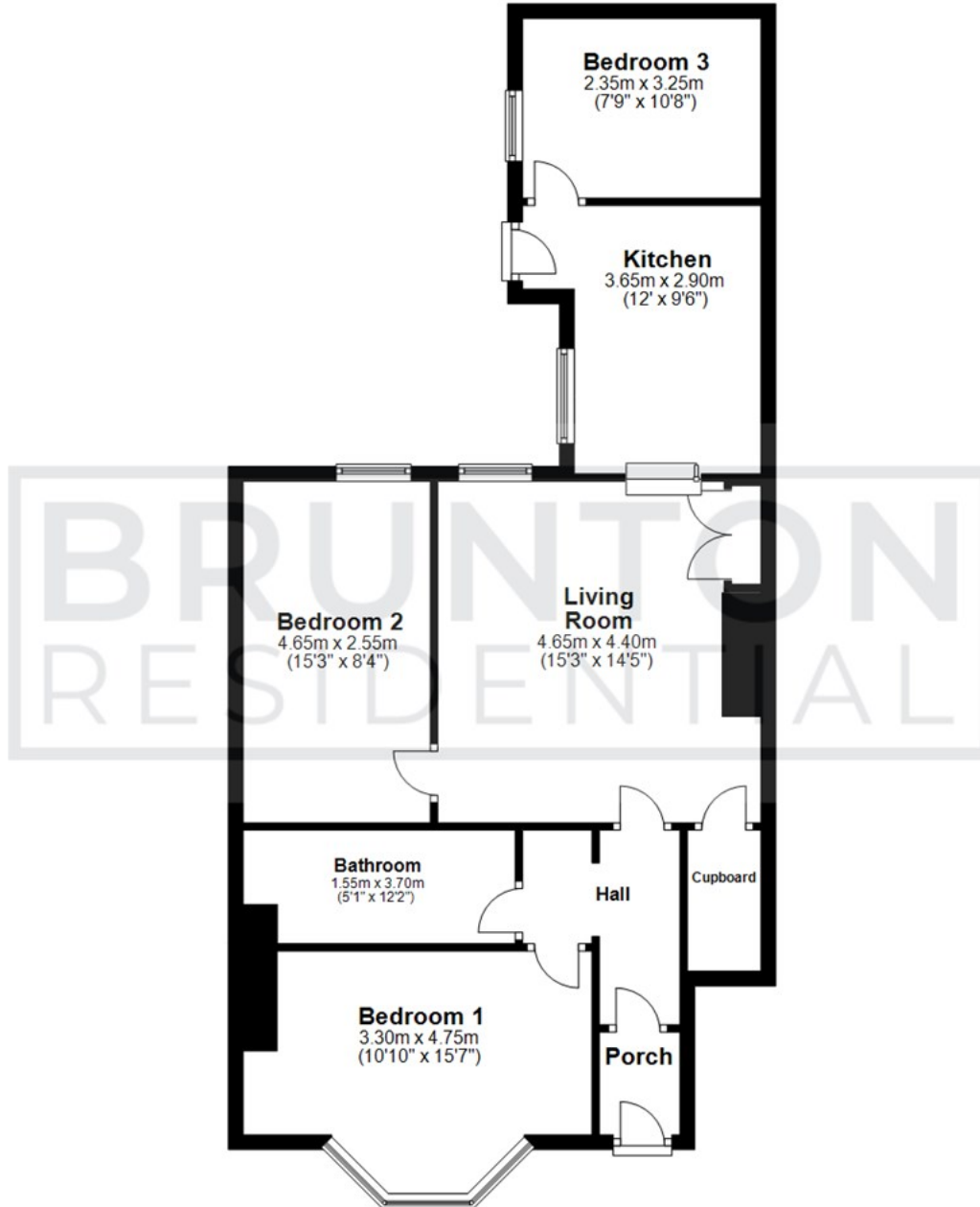

Total area: approx. 80.3 sq. metres (864.1 sq. feet)

All measurements are approximate and are for illustration only.
Plan produced using PlanUp.

These particulars, whilst believed to be accurate are set out as a general outline only for guidance and do not constitute any part of an offer or contract. Intending purchasers should not rely on them as statements of representation of fact, but must satisfy themselves by inspection or otherwise as to their accuracy. No person in this firm's employment has the authority to make or give any representation or warranty in respect of the property.

