

T. 01912368347
E. info@bruntonresidential.com
A. Brunton Residential Middleton
W. South, Wagonway Drive, NE13
9RT



Greenside Avenue

Brunswick Village Wideopen, NE13 7DY

POPULAR LOCATION - THREE BEDROOMS - OFF-STREET PARKING

Brunton Residential are delighted to offer this semi-detached house located on Greenside Avenue in Brunswick Village, Wideopen. This property consists of three bedrooms, a south-facing rear garden and off-street parking. The property is presented with no onward chain.

£140,000

9 Greenside Avenue

Brunswick Village Wideopen, NE13 7DY



Accommodation briefly comprises; bright entrance hallway with windows on two sides and stairs to the first floor. To the front of the property is a spacious lounge and dining room which leads to the kitchen at the rear. The kitchen offers a range of wall and floor units with coordinated work surfaces and some fitted appliances and access to a utility room. To the first floor are two double bedrooms, one with fitted wardrobes and a third bedroom which would make an excellent nursery or home office. The internal accommodation is completed by a large family bathroom with WC, basin and walk-in shower.

Externally, to the front is a low maintenance, graveled garden with some mature shrubs and a driveway providing off-street parking. To the rear is a well-sized, south-facing garden laid mainly to lawn with patio area and fenced boundaries.

ON THE GROUND FLOOR

Hallway

Lounge

11'6" x 11'1" (3.50m x 3.38m)

Dining Room

9'1" x 11'1" (2.78m x 3.38m)

Kitchen

15'10" x 7'1" (4.82m x 2.15m)

Utility

4'7" x 11'1" (1.40m x 3.38m)

Landing

Bedroom

13'11" x 11'5" (4.23m x 3.48m)

Bedroom

11'8" x 11'5" (3.55m x 3.48m)

Bedroom

8'5" x 8'11" (2.56m x 2.73m)

Bathroom

9'10" x 6'9" (3.02m x 2.06m)

Disclaimer

ON THE FIRST FLOOR



- POPULAR LOCATION
- SEMI-DETACHED
- NO ONWARD CHAIN
- OFF-STREET PARKING
- THREE BEDROOMS
- SOUTH FACING REAR GARDEN



Floor Plan

Ground Floor

Approx. 43.9 sq. metres (472.9 sq. feet)

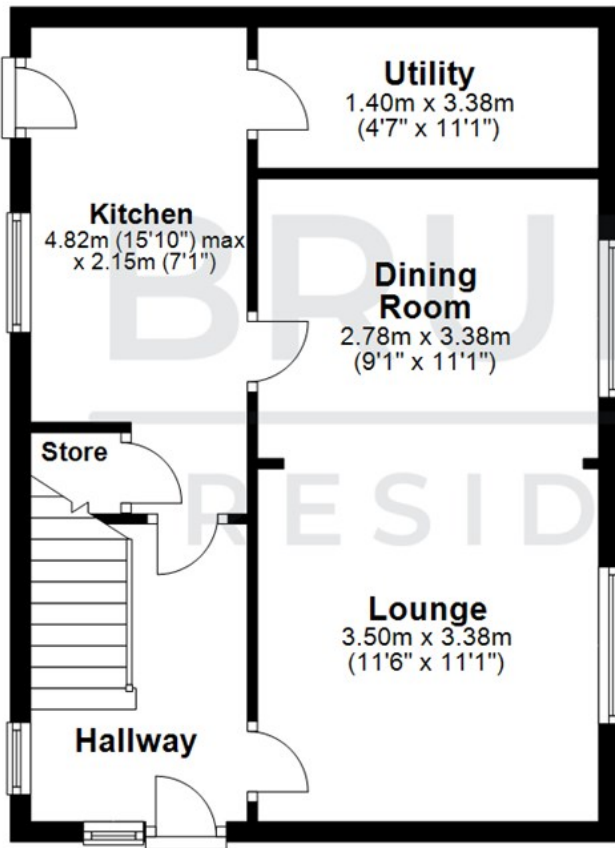

First Floor

Approx. 44.3 sq. metres (477.2 sq. feet)

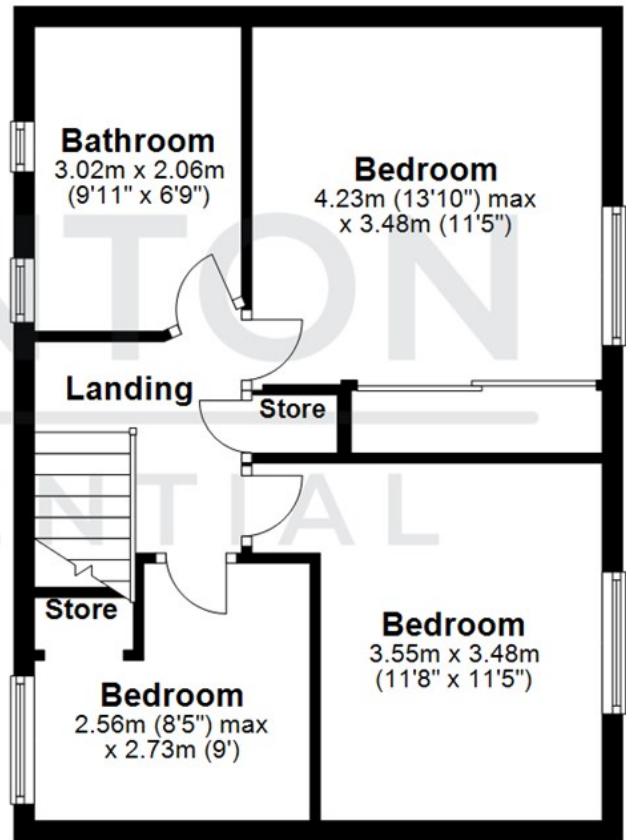

Total area: approx. 88.3 sq. metres (950.1 sq. feet)

All measurements are approximate and are for illustration only.
Plan produced using PlanUp.

These particulars, whilst believed to be accurate are set out as a general outline only for guidance and do not constitute any part of an offer or contract. Intending purchasers should not rely on them as statements of representation of fact, but must satisfy themselves by inspection or otherwise as to their accuracy. No person in this firm's employment has the authority to make or give any representation or warranty in respect of the property.

