

T. 01912368347  
E. info@bruntonresidential.com  
A. Brunton Residential Middleton  
W. South, Wagonway Drive, NE13  
9RT



## Thistle Way

Callerton, NE5 1FB

IMMACULATLEY PRESENTED - TWO BEDROOM - SOUGHT AFTER LOCATION

Brunton Residential is delighted to bring to market this fantastic two-bedroom semi-detached property in Callerton. This home boasts an immaculate interior throughout and would be perfect for first time buyers. Situated close to local amenities, schools, and transport links.

**£220,000**

# 18 Thistle Way

Callerton, NE5 1FB



Accommodation briefly comprises of; an open hallway that leads into a light-filled lounge, with the toilet conveniently located to the right and the kitchen to the left. The lounge impresses with its generous space, highlighted by large double doors that open to the garden at the rear of the property. The kitchen offers sleek matte doors, black accent handles and co-ordinated work surfaces. Integrated appliances, including a dishwasher, fridge freezer, and induction hob, enhance the kitchen's modern functionality. The WC is across the hall from the kitchen which is excellent for practicality. White tiled flooring is used throughout entire ground floor, allowing a polished finish.

Ascending to the first floor reveals two generously sized bedrooms, strategically positioned at the front and rear of the property. The master bedroom offers a well-equipped en suite that is complete with a shower and toilet. The second bedroom allows for bedroom furniture however is currently used as a spacious dressing room. The family bathroom and landing area complete this level.

At the front of the property, a driveway accommodates parking for two cars, while the rear garden has a combination of turf, graveled and porcelain tiled areas.

## ON THE GROUND FLOOR

Hallway

WC

Lounge/Diner

17'10" x 13'5" (5.44m x 4.08m)

Kitchen

12'8" x 5'11" (3.85m x 1.80m)

En-suite

Bedroom

8'4" x 13'5" (2.54m x 4.08m)

Bathroom

Disclaimer

## ON THE FIRST FLOOR

Landing

Bedroom

13'5" x 13'5" (4.10m x 4.08m)

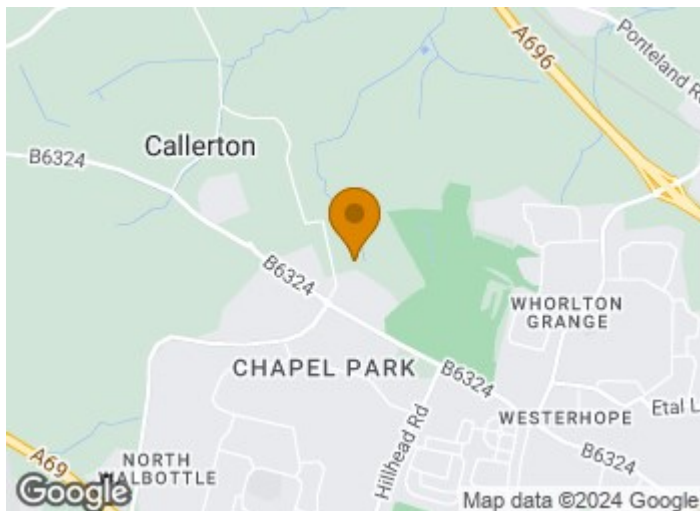

- TWO BEDROOM
- SOUGHT AFTER LOCATION
- 360 VIRTUAL TOUR
- BELLWAY
- DRIVEWAY
- UPGRADED EXTRAS
- IMMACULATE
- EN-SUITE





## Floor Plan

### Ground Floor

Approx. 36.7 sq. metres (395.3 sq. feet)

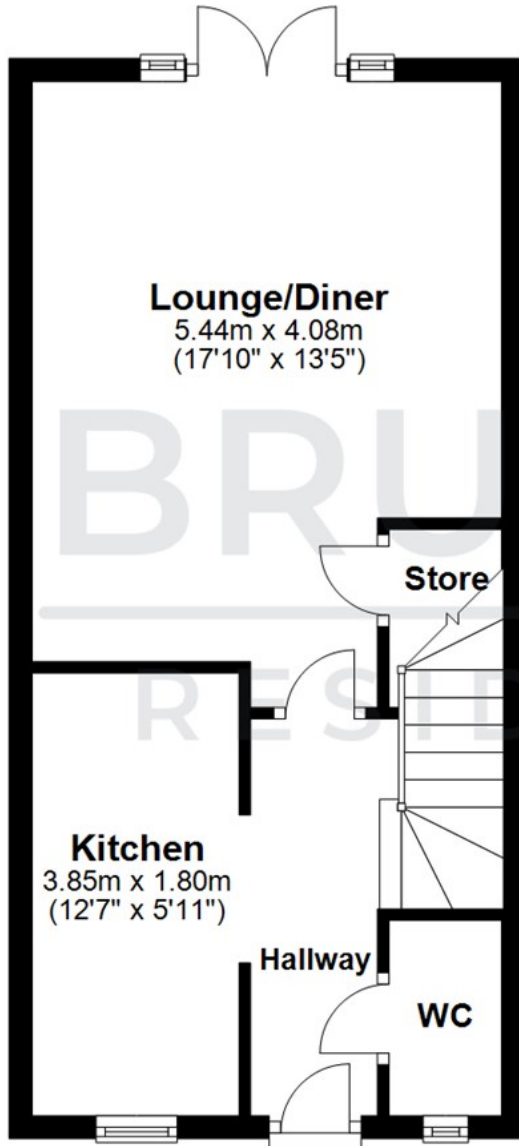

### First Floor

Approx. 36.7 sq. metres (395.3 sq. feet)

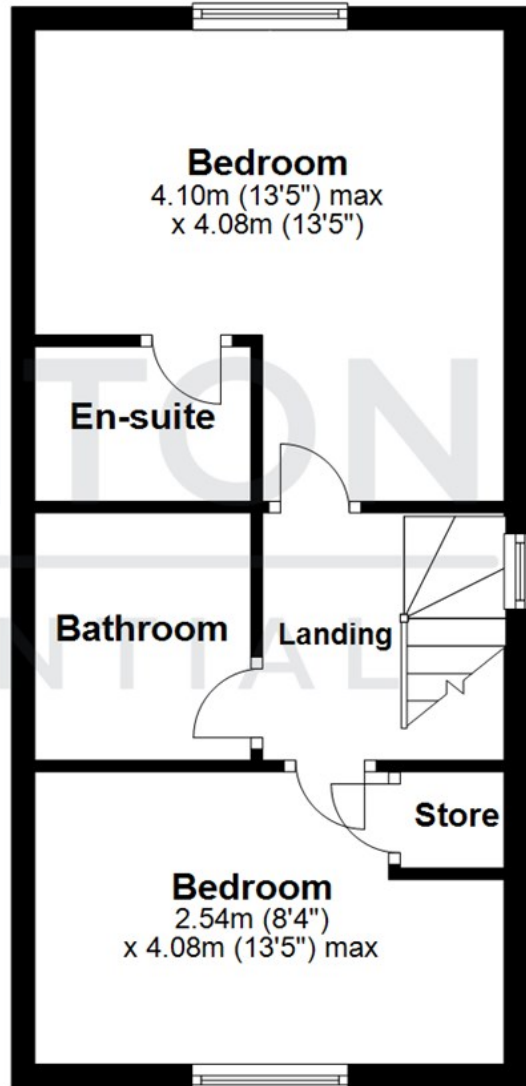

Total area: approx. 73.4 sq. metres (790.6 sq. feet)

All measurements are approximate and are for illustration only.  
Plan produced using PlanUp.

These particulars, whilst believed to be accurate are set out as a general outline only for guidance and do not constitute any part of an offer or contract. Intending purchasers should not rely on them as statements of representation of fact, but must satisfy themselves by inspection or otherwise as to their accuracy. No person in this firm's employment has the authority to make or give any representation or warranty in respect of the property.

