

T. 01912368347
E. info@bruntonresidential.com
A. Brunton Residential Middleton
W. South, Wagonway Drive, NE13 9RT



Simon Place

Wideopen, NE13 7HT

FIVE BEDROOMS - SOUGHT AFTER LOCATION - QUIET CUL-DE-SAC

Brunton Residential are delighted to offer this extended, five bedroom semi-detached home located on Simon Place in Wideopen. This home is located in a quiet cul-de-sac, offers front and rear gardens and would make an excellent family home.

Offers Over £240,000

27 Simon Place

Wideopen, NE13 7HT



Accommodation briefly comprises; entrance porch with store cupboard which leads to a spacious lounge with staircase to the first floor and large window to the front which leads to the dining room with door to rear garden.. To the rear of the property is the kitchen and utility area which provides a range of wall and floor units with coordinated work surfaces and some fitted appliances. To the first floor are two double bedrooms with fitted wardrobes, there are two single bedrooms which would make excellent nursery or home office whilst the fifth bedroom could also accommodate a double bed and furniture. Externally, the property has a lawned garden to the front with driveway providing off-street parking and there is pathway access to the property and garage. To the rear is another lawned garden with patio area and fenced boundaries.

ON THE GROUND FLOOR

- Porch
- Lounge
13'0" x 20'6" (3.95m x 6.25m)
- Dining Room
8'10" x 10'3" (2.70m x 3.12m)
- Kitchen
8'10" x 9'11" (2.70m x 3.02m)
- Utility
8'10" x 7'9" (2.70m x 2.36m)
- Garage

ON THE FIRST FLOOR

- Landing
- Bedroom
10'11" x 13'5" (3.33m x 4.08m)
- Bedroom
8'10" x 13'5" (2.70m x 4.08m)
- Bedroom
6'9" x 8'11" (2.06m x 2.71m)
- Bedroom
9'3" x 7'9" (2.83m x 2.36m)

- Bedroom
15'8" x 7'9" (4.77m x 2.36m)
- Bathroom
5'9" x 9'2" (1.77m x 2.81m)
- Disclaimer



- SOUGHT AFTER LOCATION
- EXTENDED
- GARAGE & DRIVEWAY
- QUIET CUL-DE-SAC
- FIVE BEDROOMS
- FRONT & REAR GARDENS
- EXCELLENT FAMILY HOME
- SEMI-DETACHED



Floor Plan

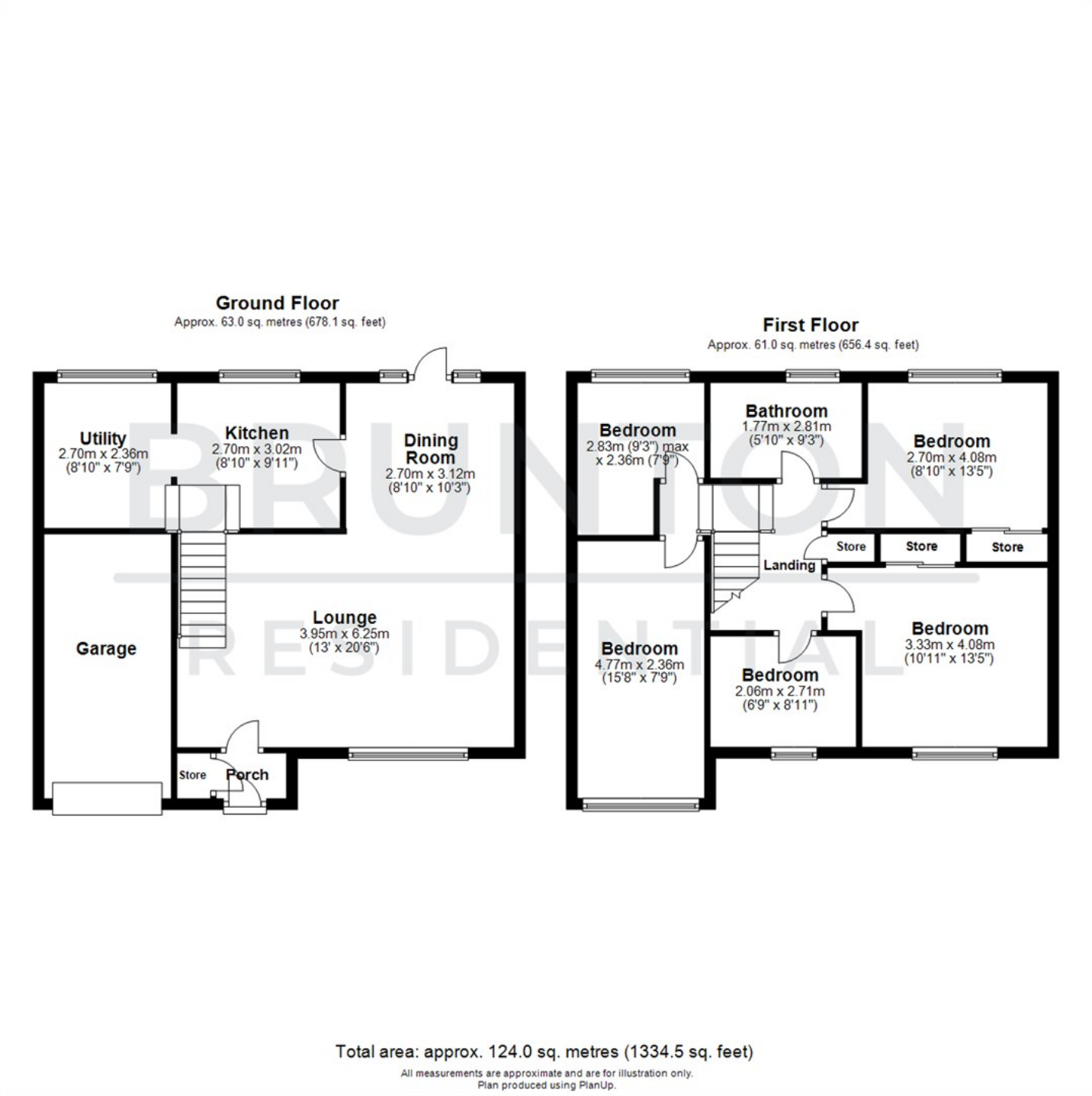

These particulars, whilst believed to be accurate are set out as a general outline only for guidance and do not constitute any part of an offer or contract. Intending purchasers should not rely on them as statements of representation of fact, but must satisfy themselves by inspection or otherwise as to their accuracy. No person in this firm's employment has the authority to make or give any representation or warranty in respect of the property.

