

BRUNTON

RESIDENTIAL



WATERSIDE, MORPETH, NE61

Offers Over £300,000

BRUNTON

RESIDENTIAL





BRUNTON

RESIDENTIAL



BRUNTON

RESIDENTIAL



STUNNING RIVER VIEWS - WELL PRESENTED - SOUGHT AFTER TOWN CENTRE LOCATION

Brunton Residential are delighted to offer for sale this three bedroom, terraced home located on Waterside, on the banks of the River Wansbeck in Morpeth. This well-presented home offers generous living accommodation close to local schools and amenities and offers superb river views.

BRUNTON

RESIDENTIAL



BRUNTON

RESIDENTIAL

Accommodation briefly comprises; entrance hallway with access to recently renovated downstairs WC and store cupboard. There is a well-equipped kitchen with ample space for dining, wall and floor units, coordinated work surfaces and fitted appliances. The bright, spacious, full-width lounge is south-facing and benefits from natural light flooding the space. This leads to a wonderfully versatile sunroom which can also be used as a dining room, with views of the town garden and River Wansbeck. To the first floor are two double bedrooms, one to the front and one to the rear with a third bedroom at the front which would also make a perfect home office or nursery. The internal accommodation is completed by the modern, recently renovated, family bathroom with WC, basin and walk-in shower. Externally, the property benefits from a town garden to the front with pathway access to the property, flower beds and fenced boundaries whilst to the rear, main entrance, there is a carport and driveway providing off-street parking for up to two cars.



BRUNTON

RESIDENTIAL

TENURE : Freehold

LOCAL AUTHORITY :

COUNCIL TAX BAND : D

EPC RATING : C

SERVICES :

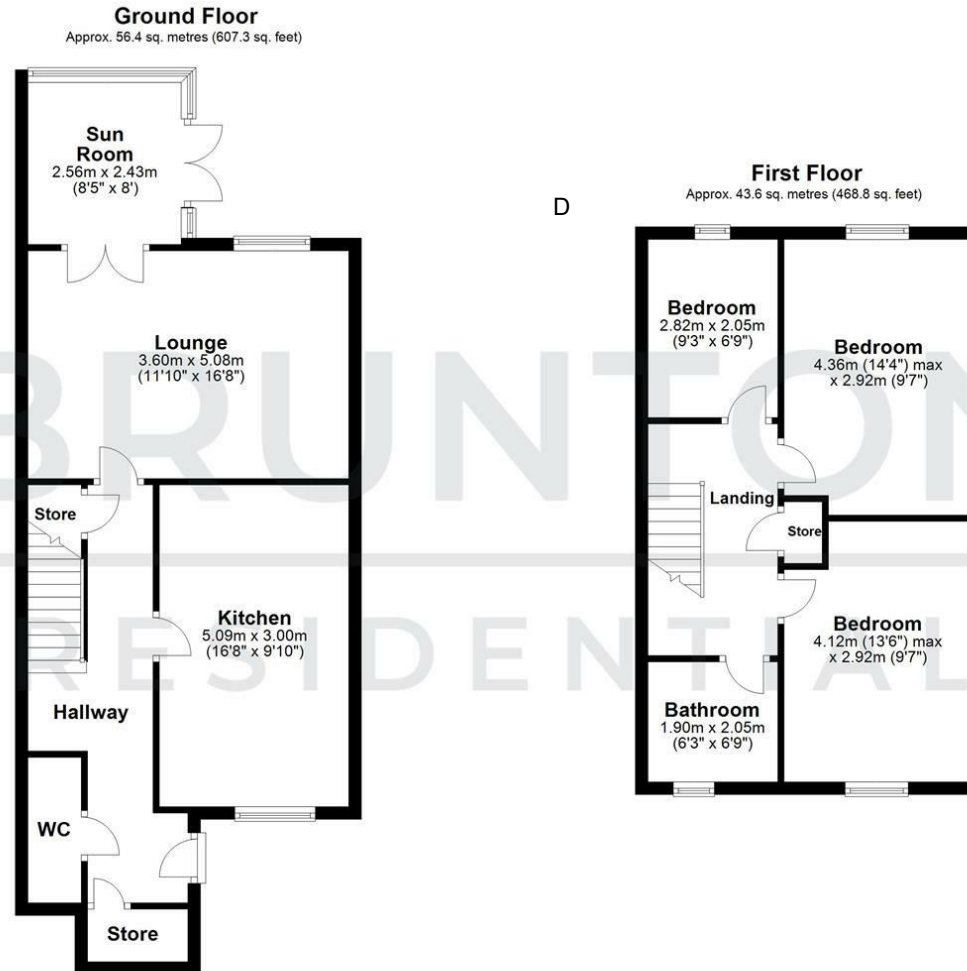

Total area: approx. 100.0 sq. metres (1076.1 sq. feet)

All measurements are approximate and are for illustration only.
Plan produced using PlanUp.

