

BRUNTON

RESIDENTIAL



DATALLER DRIVE, HANNANAH PARK, NE13

Offers Over £400,000

BRUNTON

RESIDENTIAL





BRUNTON

RESIDENTIAL





DETACHED HOME - FANTASTIC LOCATION - FRONT & REAR GARDENS

Brunton Residential are delighted to offer this four bedroom detached 'Acacia' by Bellway, located on Dataller Drive located in the popular Havannah Park development. This property is also presented with no onward chain.

Located in a popular residential area, the home benefits from excellent access to local schools, parks, and amenities, along with convenient transport links into the city centre.

BRUNTON

RESIDENTIAL



BRUNTON

RESIDENTIAL

accommodation which briefly comprise of; entrance hallway with access to downstairs WC, garage & store cupboard. There is a bright, spacious lounge and a full length kitchen, dining/family room. The kitchen offers a range of wall and floor units with coordinated work surfaces and fitted appliances with an ample space for formal dining.

The first floor consists of a master suite with ensuite shower room a second ensuite bedroom with shower room and a further two double bedrooms as well as the tiled family bathroom.

Externally there is a garden to the front which is laid mainly to lawn with pathway access to the property and a driveway which provides parking for multiple cars and access to the garage. The west facing rear garden has been landscaped with a combination of lawned and patio areas and raised planted boundaries and there is a fantastic outdoor space for al fresco dining.



BRUNTON

RESIDENTIAL

TENURE : Freehold

LOCAL AUTHORITY :

COUNCIL TAX BAND : E

EPC RATING : B

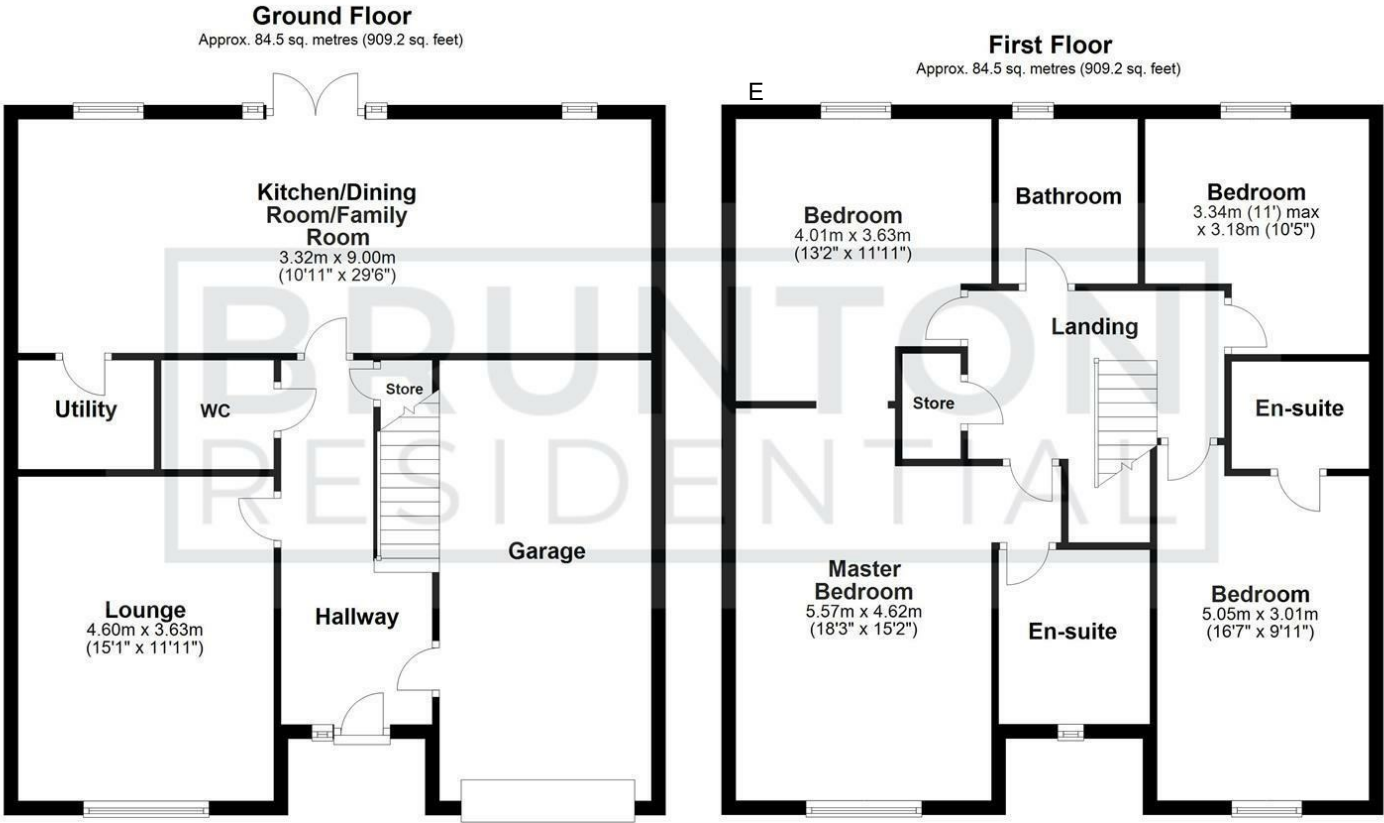

Total area: approx. 168.9 sq. metres (1818.5 sq. feet)

All measurements are approximate and are for illustration only.
Plan produced using PlanUp.

