



— Guide Price £375,000



— Third (Top) Floor Apartment



— 1 Bedroom



— 1 Bathroom



— Circa 450 sqft

Newark Street, Whitechapel, E1

A bright and well-presented 1-bedroom apartment set within a small purpose-built block on the third (top) floor, quietly positioned on a peaceful street in the heart of bustling Whitechapel. Just moments from Whitechapel Station, the property is offered chain free.



Easthaus



The south-facing reception room benefits from excellent natural light throughout the day featuring wood flooring throughout and charming sash windows. The modern fitted kitchen, which is both stylish and practical, sits neatly to one side of the living area.

The bedroom is a comfortable double with built-in wardrobes, and the bathroom is fully tiled with a vaulted skylight positioned directly above the bath, featuring an overhead shower and contemporary fixtures. Additional built-in storage can be found in the hallway.

There is the added benefit of a generous loft (undemised), ideal for additional storage, and no direct neighbours.

Area

The property is ideally located for the amenities of Mile End Road including the famous Genesis Cinema and the Whitechapel Gallery with Bethnal Green, Spitalfields and Brick Lane all within easy reach.

Nearby transport links include Whitechapel Overground and Underground station (District and H&C lines), Bethnal Green Stations (both overground and underground) as well as the A11 and A13. A number of well-connected bus routes also run along Mile End Road and Whitechapel Road providing easy access to the City, Central London and Stratford if heading east.

The green open spaces of Weaver's Fields, Bethnal Green Gardens, Stepney Green Park and Mile End Park are all within walking distance.

Details

Tenure: Leasehold circa 107 years remaining
Service Charges circa £1,040 pa
Ground Rent £450 pa
EPC: C
Local council: Tower Hamlets
Council Tax band: C



Easthaus

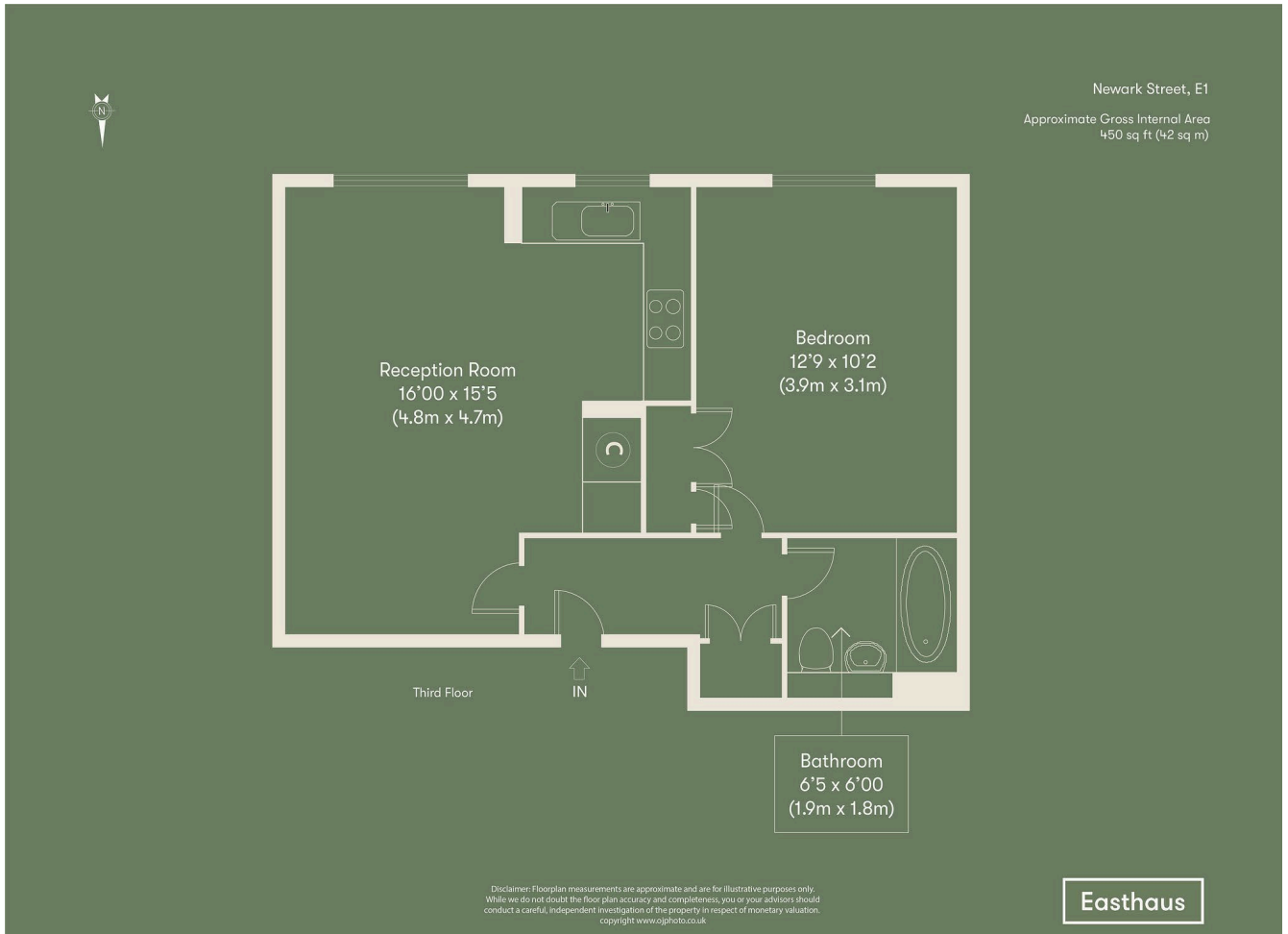

Important notice:

1. Particulars: These particulars are not an offer or contract, nor part of one. You should not rely on statements by Easthaus Limited in the particulars or by word of mouth or in writing ("information") as being factually accurate about the property, its condition or its value. Neither Easthaus Limited nor any joint agent has any authority to make any representations about the property, and accordingly any information given is entirely without responsibility on the part of the agent(s), seller(s) or lessor(s). 2. Photos and floorplans: The photographs show only certain parts of the property as they appeared at the time they were taken. Areas, measurements and distances given are approximate only. 3. Regulations, etc.: Any reference to alterations to, or use of, any part of the property does not mean that any necessary planning, building regulations or other consent has been obtained. A buyer or lessee must find out by inspection or in other ways that these matters have been properly dealt with and that all information is correct. 4. VAT: The VAT position relating to the property may change without notice. 5. Particulars dated 9th July 2025. EastHaus Limited is registered in England with registered number 10275389. Our registered office is The Oast, New Road, East Malling, Kent, ME19 6BJ.

