



## Courthill Road, Lewisham, London SE13 6HA

Asking Price TBA

- Semi Detached
- Victorian House
- Halls Adjoining
- Two bedrooms

For sale is this halls adjoining semi-detached house. This Victorian building is actually a lot bigger than it looks in its photo, being dwarfed by the tall building next door, makes it look small - it isn't. Downstairs there are two separate reception rooms a kitchen, which opens onto the garden. On the first floor there are two big bedrooms and a big bathroom. The owner is in the process of refurbishing the kitchen and bathroom as well as obtaining planning permission for a loft conversion to comprise of an additional bedroom and bathroom. There is a small patio garden to the rear. Located between, Hither Green, Lewisham and Ladywell and thus completely spoilt for transport. Viewing by appointment.

### GROUND FLOOR

APPROX. 41.2 SQ. METRES (443.8 SQ. FEET)

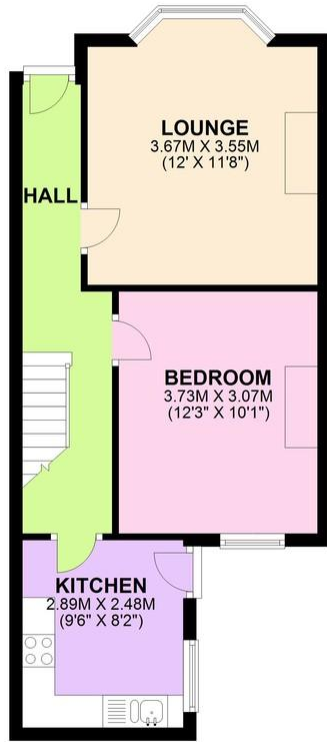

### FIRST FLOOR

APPROX. 40.6 SQ. METRES (436.6 SQ. FEET)



TOTAL AREA: APPROX. 81.8 SQ. METRES (880.4 SQ. FEET)

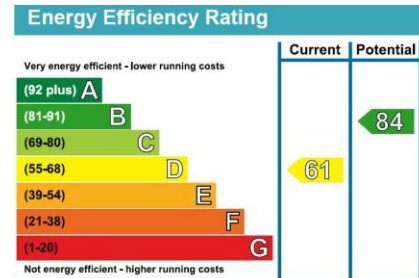

South London Branch, 197  
Lewisham High Street, London,  
SE13 6AA

[www.markbeaumont.com](http://www.markbeaumont.com)  
020 8852 5000  
[sales@markbeaumont.com](mailto:sales@markbeaumont.com)

Agents Note: Whilst every care has been taken to prepare these particulars, they are for guidance purposes only. All measurements are approximate and for general guidance purposes only and whilst every care has been taken to ensure their accuracy, they should not be relied upon and potential buyers are advised to recheck the measurements.