



Swallands Road, London, SE6 3HG

Asking Price Of £280,000

- TWO DOUBLE BEDROOMS
- GARDEN
- GROUND FLOOR FLAT
- LIVING ROOM 15'5 x 12

MarkBeaumont.com Estate Agents offer For sale this ground floor garden flat. The flat benefits from direct access to a private rear garden with a summer house. There are two double bedrooms and a good sized living room of 15'5 x 12. There is a separate kitchen with utility area. The bathroom and cloakroom are separate. The flat is in good condition. Located in a quiet street 0.3 mile from Bellingham Station.

Whatsapp us: <https://wa.me/447832685596>

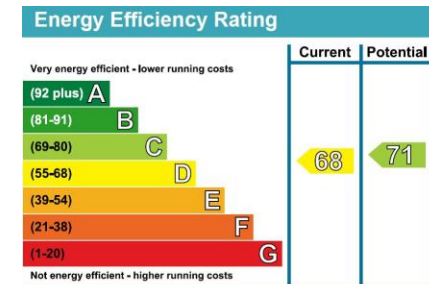
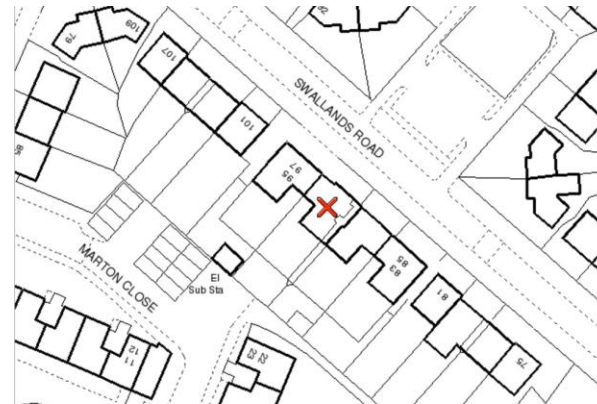

South London Branch, 197
Lewisham High Street, London,
SE13 6AA

www.markbeaumont.com
020 8852 5000
sales@markbeaumont.com

Agents Note: Whilst every care has been taken to prepare these particulars, they are for guidance purposes only. All measurements are approximate are for general guidance purposes only and whilst every care has been taken to ensure their accuracy, they should not be relied upon and potential buyers are advised to recheck the measurements