



- 2 Bedrooms
- Big Lounge
- Balcony
- 2 Bathrooms

### Curness Street, Lewisham, London SE13 6JY

£1,325 pcm

Set within a smart & modern gated development in the heart of Lewisham is this recently built two bedroom purpose built flat. The property is in a perfect location for access to Lewisham town centre and also Ladywell Village. You'll be spoilt with the best transport in SE London on your doorstep. With the DLR to Canary Wharf & Bank and quick trains to London Bridge, Canon Street, Charing Cross & Victoria. Benefits include a modern fitted kitchen with integrated fridge/freezer, dishwasher, washing machine and oven & hob. Modern white bathroom suite and en-suite shower room. There are two bedrooms with wardrobes, the master bedroom has an en-suite shower room. The reception room has an access to a balcony. Whatsapp us: 07832 685 596. Available now.



557 sq. ft

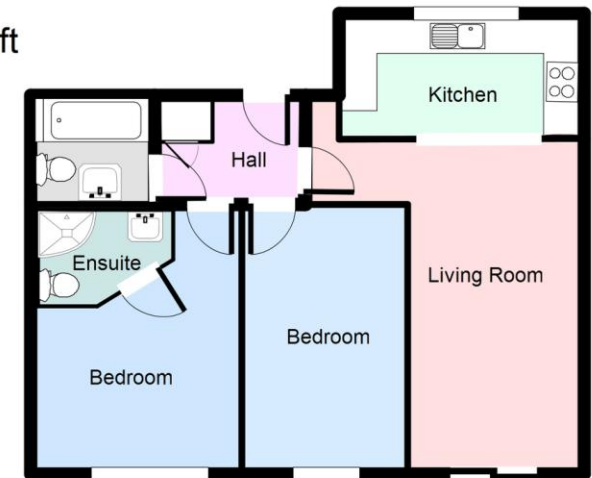

Copyright Mark Beaumont Estate Agents



Energy Efficiency Rating		
	Current	Potential
Very energy efficient - lower running costs		
(92 plus) <b>A</b>		
(81-91) <b>B</b>	84	87
(69-80) <b>C</b>		
(55-68) <b>D</b>		
(39-54) <b>E</b>		
(21-38) <b>F</b>		
(1-20) <b>G</b>		
Not energy efficient - higher running costs		
<b>England &amp; Wales</b>	EU Directive 2002/91/EC	

South London Branch, 197  
Lewisham High Street, London,  
SE13 6AA

[www.markbeaumont.com](http://www.markbeaumont.com)  
[lettings@markbeaumont.com](mailto:lettings@markbeaumont.com)  
020 8852 5000

Agents Note: Whilst every care has been taken to prepare these particulars, they are for guidance purposes only. All measurements are approximate and for general guidance purposes only and whilst every care has been taken to ensure their accuracy, they should not be relied upon and we advise to recheck the measurements.