



Mark Beaumont
markbeaumont.com

LIMES GROVE, LONDON, SE13 6DD
ASKING PRICE OF £290,000





DESCRIPTION

Mark Beaumont estate agents are pleased to offer for sale this Hall Floor Victorian Conversion flat. Located just off of the High Street and yet close enough to Hither Green and Ladywell for when you are feeling social. Limes Grove is a popular tree lined road, which benefits from closed roads, making it fairly quiet for such a central location. This is a smart and cosy one bedroom flat in good condition. There is an entrance hall, with storage and surprisingly, a loft for extra storage. Then there is a charming living room and bay window. The living room opens onto the modern kitchen which makes everything feel light. The bedroom is at the back away from the street overlooking gardens. There is a shower room with a bigger shower. You are quite near to '3' train stations and spoilt for choice for parks and open space nearby. 'Nest controlled heating'. This property is 'share of freehold'.

COMMUNAL ENTRANCE

ENTRANCE HALL

LIVING ROOM

13' 7" x 13' 5" (4.14m x 4.09m)

KITCHEN

8' 4" x 5' 2" (2.54m x 1.57m)

BEDROOM

12' x 10' 1" (3.66m x 3.07m)

SHOWER ROOM

AGENTS NOTE

Limes Grove SE13 6DD

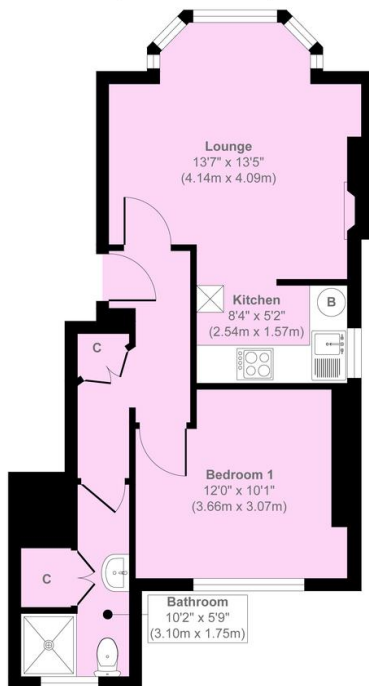

Floor Plan
Approximate Floor Area
423 sq. ft
(39.29 sq. m)

Score	Energy rating	Current	Potential
92+	A		
81-91	B		
69-80	C		
55-68	D	58 D	76 C
39-54	E		
21-38	F		
1-20	G		