

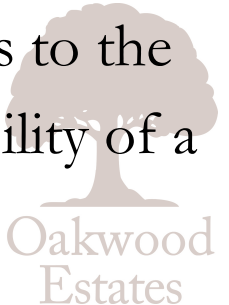







Offered to the market since the first time it was built in 1938, a two bedroom semi-detached home in need of modernisation throughout. Situated in Datchet village just a short walk from Datchet Village and Train Station (Waterloo Line). The property benefits from a front and rear garden with driveway parking for 3 cars and has scope to extend STPP. This property would make for an ideal first time purchase or investment property and comes to the market with no onward chain allowing the possibility of a quick sale.



-  TWO BEDROOM SEMI DETACHED HOUSE
-  SCOPE FOR FURTHER EXTENSION (STPP)
-  DRIVEWAY PARKING
-  GARDEN
-  NO ONWARD CHAIN
-  IDEAL FOR FIRST TIME BUYERS/INVESTMENT BUYERS
-  COUNCIL TAX BAND - D
-  EPC - PENDING



Total Approximate Floor Area
796 Square feet
74 Square metres

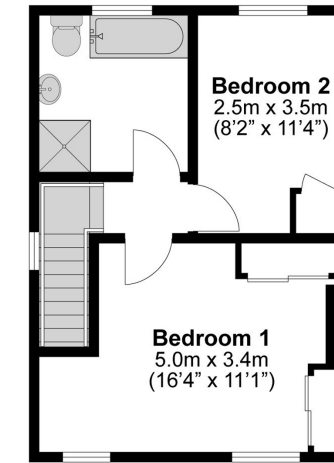
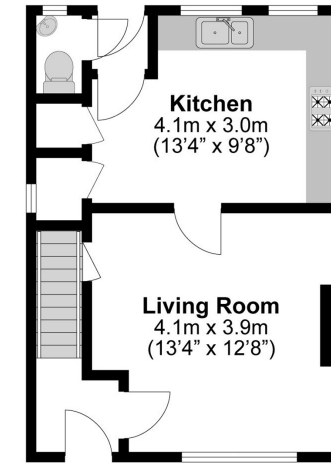

Illustrations are for identification purposes only, measurements are approximate, not to scale.

Prospective purchasers should be aware that these sales particulars are intended as a general guide only and room sizes should not be relied upon for carpets or furnishing. We have not carried out any form of survey nor have we tested any appliance or services, mechanical or electrical. All maps are supplied by Goview.co.uk from Ordnance Survey mapping. Care has been taken in the preparation of these sales particulars, which are thought to be materially correct, although their accuracy is not guaranteed and they do not form part of any contract.

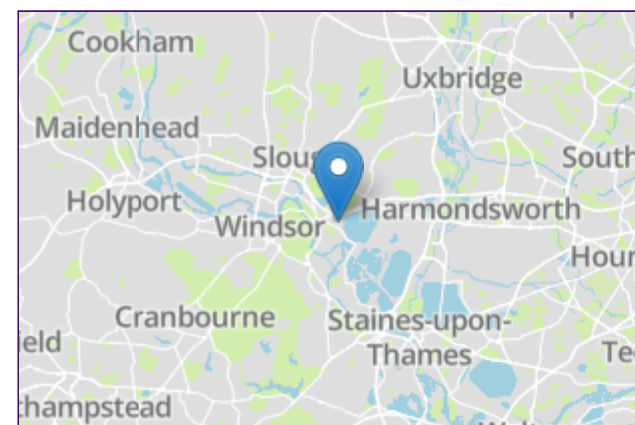

					
x2	x1	x1	x3	Y	N
Bedrooms	Reception Rooms	Bathrooms	Parking Spaces	Garden	Garage

External

Driveway parking for 3 cars, front and rear garden.

Transport Links

Nearest stations:

- Datchet (0.6 mi)
- Sunnymeads (0.9 mi)
- Windsor & Eton Riverside (1.7 mi)

Schools

PRIMARY SCHOOLS:

- Datchet St Mary's CoFE Primary School
0.5 miles away
State school
- Eton End School Trust (Datchet) Limited
1 mile away
Independent school
- Castleview Primary School
1.1 miles away
State school
- Holy Family Catholic Primary School
1.2 miles away
State school

Foxborough Primary School
1.5 miles away
State school

SECONDARY SCHOOLS:

- Churchmead Church of England (VA) School
0.6 miles away
State school
- Ditton Park Academy
1.1 miles away
State school
- Langley Grammar School
1.3 miles away
State school
- The Langley Academy
1.5 miles away
State school
- Long Close School
1.6 miles away
Independent school
- Council Tax**
Band D