

Occupying a desirable plot on one of Langley's most sought after residential roads, this four bedroom detached property is offered to the market for the first time since the turn of the century, within a short walking distance of some of the best local schools including St Bernard's, Upton Court and Langley Grammar schools.

The property stretches a fantastic 2613 square ft. and offers spacious living accommodation suitable for a large family. The ground floor consists of a large entrance hall leading to family room on the left and a study on the right. An additional 24ft living room is positioned at the back of the house whilst a large open plan kitchen/diner offers views of an impressive rear garden, with access to a separate utility room, downstairs cloakroom, and both the lean-to/workshop and further storage areas.

Rising to the first floor a spacious landing area lends itself well to the possibility of a loft conversion. Four well-proportioned bedrooms offer a great range of fitted wardrobes, and an ultra-modern fully tiled family bathroom offers bath & shower facilities.

Externally the driveway provides ample off-street parking for 5-6 cars whilst to the rear of the property is a beautifully maintained garden, enjoying shrubbery borders that provide a high degree of privacy. There is also a 35ft outbuilding, currently utilised as a gym/office, but also features built-in wardrobes.

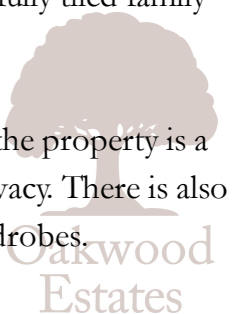

Property Information

Floor Plan

-  HIGHLY SOUGHT-AFTER LOCATION
-  THREE RECEPTION ROOMS AND SEPARATE UTILITY ROOM
-  OVER 2600 SQUARE FEET
-  35FT OUTBUILDING SUITABLE FOR OFFICE OR GYM USE
-  1 MILE FROM LANGLEY CROSSRAIL STATION
-  SPACIOUS FOUR BEDROOM DETACHED HOUSE
-  WALKING DISTANCE TO 3 NEARBY GRAMMAR SCHOOLS
-  EXCEPTIONAL REAR GARDEN AND PARKING FOR 5-6 CARS
-  MODERN FULLY-TILED BATHROOM WITH SHOWER



					
x4	x3	x2	x6	Y	N
Bedrooms	Reception Rooms	Bathrooms	Parking Spaces	Garden	Garage

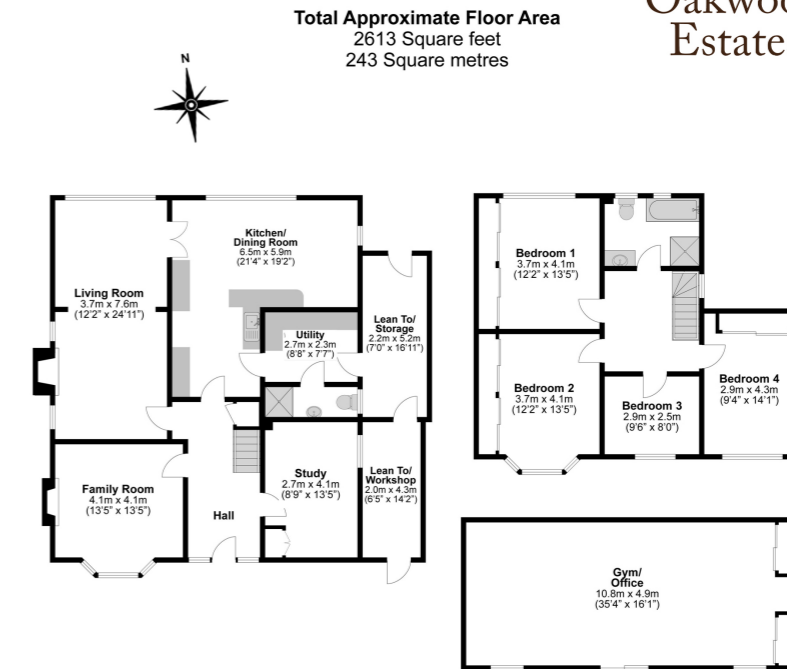

Illustrations are for identification purposes only, measurements are approximate, not to scale.

Transport Links

NEAREST STATIONS:

Langley - 1.1 miles

Slough - 1.1 miles

Datchet - 1.7 miles

Local Schools

PRIMARY SCHOOLS

St Bernard's Preparatory School

0.3 miles away

Ryvers School

0.4 miles away

Castleview Primary School

0.7 miles away

The Langley Academy Primary

0.7 miles away

Marish Primary School

1.0 mile away

SECONDARY SCHOOLS

St Bernards Catholic Grammar School

0.2 miles away

Upton Court Grammar School

0.4 miles away

Ditton Park Academy

0.7 miles away

The Langley Academy

0.7 miles away

Langley Grammar School

0.9 miles away

Council Tax

Band F

Prospective purchasers should be aware that these sales particulars are intended as a general guide only and room sizes should not be relied upon for carpets or furnishing. We have not carried out any form of survey nor have we tested any appliance or services, mechanical or electrical. All maps are supplied by Goview.co.uk from Ordnance Survey mapping. Care has been taken in the preparation of these sales particulars, which are thought to be materially correct, although their accuracy is not guaranteed and they do not form part of any contract.

