

Oakwood
Estates

-  GREAT SCHOOL CATCHMENT AREA
-  THREE BEDROOMS
-  CLOSE TO AMERSHAM STATION
-  OFF STREET PARKING
-  GENEROUS GARDEN
-  AVAILABLE 11TH APRIL 2024.
-  COUNCIL TAX BAND - E
-  EPC - D

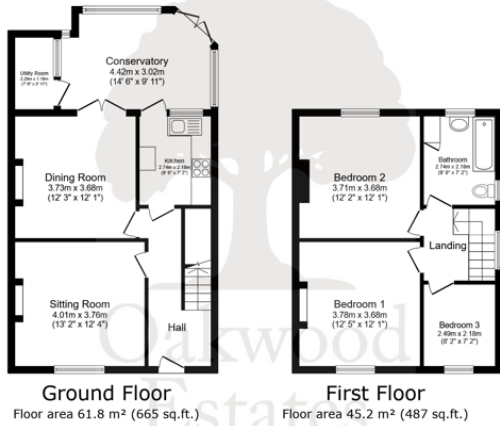

TOTAL: 107.0 m² (1,152 sq.ft.)

This floor plan is for illustrative purposes only. It is not drawn to scale. Any measurements, floor areas (including any total floor area), openings and orientations are approximate. No details are guaranteed, they cannot be relied upon for any purpose and do not form any part of any agreement. No liability is taken for any error, omission or misstatement. A party must rely upon its own inspections. Powered by www.ProperlyHome.co.uk