

## Milliers Court, Worthing Road, East Preston

### Leasehold

Bright and airy first-floor home with views over landscaped communal gardens. • Excellent location just moments from Angmering train station, local bus routes, shops, and a doctor's surgery (150 metres away). • Age-exclusive living for occupants aged 60+ (or 55+ for a partner), offering a quiet and supportive community. • Peace of Mind Living – 24-hour emergency care-line and live-in house manager on site. • Great communal facilities with residents enjoy a lounge, laundry room, guest suite, and well-maintained gardens. • Offered chain-free – ready for immediate occupation.

*Cooper Adams*



**Chain-Free & Ready to Move In!** Welcome to this beautifully maintained south-facing first-floor retirement apartment, perfectly positioned to enjoy tranquil views over the landscaped communal gardens. Light-filled and inviting, the generous lounge is a standout feature—ideal for relaxing or entertaining guests. The kitchen features a built-in fridge freezer, and oven and hob. The property also benefits from upgraded hot water cylinder enhancing energy efficiency. A lift is conveniently located close by, making access easy and effortless. The apartment also offers a fitted bathroom and a spacious double bedroom and a general well-appointed layout. Located in a sought-after retirement development, residents enjoy access to a 24-hour emergency care-line, a live-in house manager, communal lounge, laundry facilities, and a guest suite for visiting friends or family. Just minutes from Angmering train station, local shops, and bus stops, the convenience is exceptional—with a doctor's surgery only 150 metres away, peace of mind is part of everyday living. Age restriction applies: Occupants must be 60+ (or 55+ for a partner in a couple). This is low-maintenance, community-focused living at its best—offered chain-free and ready for its next chapter.



East Preston, a charming seaside village in West Sussex, is nestled just south of the South Downs National Park. It exudes a strong sense of community, often described as 'Living in the country by the sea.



*Cooper Adams*

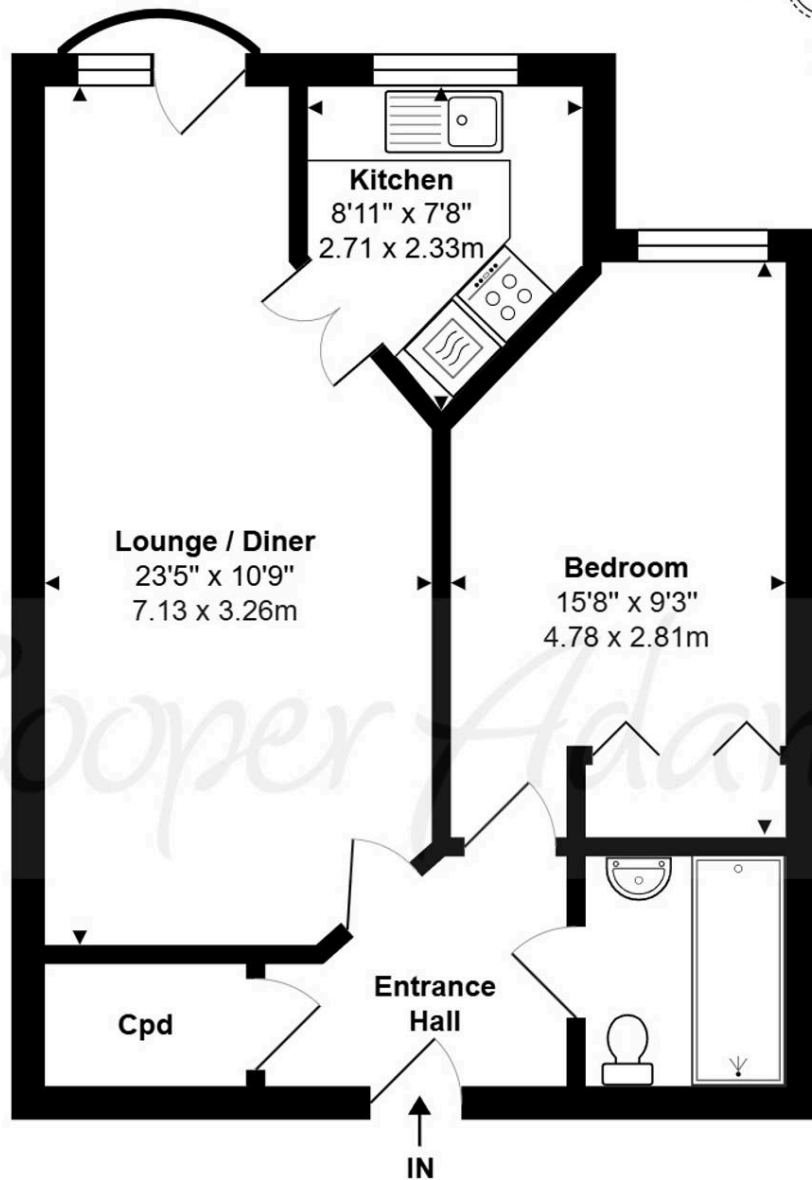

**First Floor**

**Milliers Court, Worthing Road, East Preston, BN16 1AR**

**Total Area: 528 ft<sup>2</sup> ... 49.0 m<sup>2</sup>**

Whilst every attempt has been made to ensure the accuracy of the floor plan contained here, measurements are approximate and no responsibility is taken for error, omission or mis-statement.

This plan is for illustrative purposes only and should be used as such by any prospective purchaser.

Created by 1st Image 2025



Material Information includes important facts that may affect a buyer's decision to view or buy, such as tenure, restrictions, utilities, construction, and other key details. Full information for this property is available at [www.cooper-adams.com](http://www.cooper-adams.com). We may offer buyer services and receive referral benefits - details on request. All content is copyright Cooper Adams. Details and floor plans are for guidance only and don't form part of any contract. Measurements are maximums including bays and alcoves. Floor plan sizes are approximate. Images, maps and plans are not to scale. Appliances/services not tested. Cooper Adams Estates Ltd, Bishopstone. Reg No: 07127482. VAT No: 982847172.

Lettings | Sales | Free valuations | Land & New Homes | Mortgages

FULL DETAILS OF THE MATERIAL INFORMATION ARE ON OUR WEBSITE - VIEWING STRICTLY BY APPOINTMENT WITH COOPER ADAMS

FOR MORE PHOTOS AND TO BOOK A VIEWING VISIT OUR WEBSITE - Tel: 01903 791 792 - [www.cooper-adams.com](http://www.cooper-adams.com)