



Palmer Road, Angmering, BN16 4LJ

Freehold

Two double bedroom semi detached bungalow • Partly converted garage • Office/workshop in the garden • Fantastic sized private garden • Garage and off street parking for three cars • Walking distance to shops and amenities • For more information, please visit the Cooper Adams website

*Cooper Adams*



Presenting a rare opportunity to purchase this two bedroom semi-detached bungalow in a sought-after quiet location. The property boasts two double bedrooms, a sitting room and sunroom but currently the sitting room is being used as a bedroom. The kitchen and sunroom offers access to the sunny fantastic sized garden, providing a perfect spot for outdoor gardening, entertaining or private relaxation.

The property offers great potential with a partly converted garage with storage at the front and an additional office/workshop in the garden. In addition, the property includes off-street parking for two cars, and an electric car charging point, ensuring convenience for residents and visitors alike.

Situated within walking distance to local shops, schools and amenities, this property offers a convenient and practical lifestyle for its future owners. Don't miss out on this incredible opportunity – for more information and to schedule a viewing, please visit the Cooper Adams website.



Angmering, a charming village near the South Downs, offers shops, schools, a health club, and a golf course. Beaches are within 2 miles, and nearby shopping is available in Rustington and Worthing. Angmering station connects to London, Brighton, and more, with Gatwick 40 miles away and easy access to the A27 and A24 roads.

This property is "Legally Prepared." Cooper Adams has gathered key documents, including the title, plans, property forms, warranties, and EPC. Buyers must request these before offering.



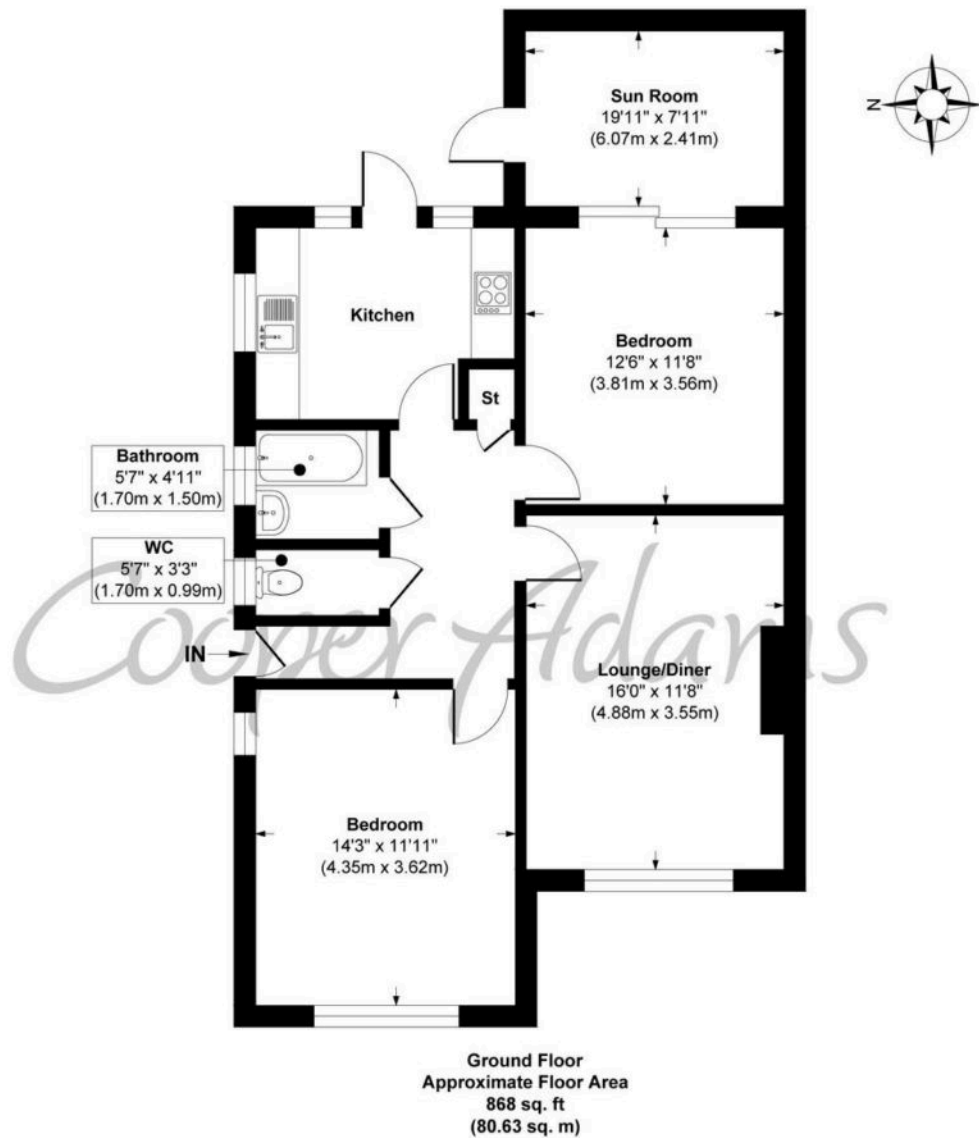

**Palmer Road, Angmering, BN16 4LJ**

**Approx. Gross Internal Floor Area 868 sq. ft / 80.63 sq. m**

Illustration for identification purposes only, measurements are approximate, not to scale

Copyright © Cooper Adams



This material is protected by laws of copyright which is owned by Cooper Adams. Whilst every attempt has been made to ensure the accuracy of these details and floor plan contained here, they do not constitute any offer or contract or part thereof. All measurements are always maximum measurements into bay windows, alcoves and for L shaped rooms. No guarantee is given on total square footage taken from the floor plan. The details, pictures, maps and floor plans are for illustration purposes only and not to scale. Any appliances and/or services have not been tested. Cooper Adams is a trading name of Cooper Adams Estates Limited registered at Bishopstone. Registered in England and Wales. Our registered number is 07127482. Our VAT Number is 982847172.

Lettings | Sales | Free valuations | Land & New Homes | Mortgages

FULL DETAILS OF THE MATERIAL INFORMATION ARE ON OUR WEBSITE - VIEWING STRICTLY BY APPOINTMENT WITH COOPER ADAMS

FOR MORE PHOTOS AND TO BOOK A VIEWING VISIT OUR WEBSITE - Tel: 01903 791 792 - [www.cooper-adams.com](http://www.cooper-adams.com)