



Rope Walk, Littlehampton, BN17 5DE

Freehold

A Characterful Detached House • Three Double Bedrooms • South-Westerly Garden • Garage and Driveway • Exposed Wood Beams • Feature Brick Fireplace • 1920's Tudor Style Property • Close to Littlehampton Golf Course and Yacht Club • Approx. 2022 sq. ft (187.9 sq. m)

Cooper Adams

This charming 1920s Tudor-style detached home is situated just moments from Littlehampton Golf Course and Yacht Club. Boasting three double bedrooms, this characterful property is perfect for growing families or those in need of extra space. The kitchen, complemented by a separate utility room, leads seamlessly into a spacious dining room, perfect for family meals or entertaining guests. The living room, with its feature brick open fireplace, offers a cosy focal point as-well-as direct access to the south-westerly garden. Upstairs, you'll find three double bedrooms and a spacious family bathroom, featuring a separate bath, walk-in shower, sink, and a separate WC. Additional features include a large garage and driveway, providing ample parking and storage. Blending period charm with modern conveniences, this unique home offers a rare opportunity to enjoy a touch of history with contemporary living. Don't miss your chance to make it your own!

The seller requires a 'Reservation Agreement' to protect serious buyers as they proceed to exchange of contracts.



Littlehampton, a vibrant seaside town at the mouth of the River Arun, offers great shopping, entertainment, and day-to-day amenities. With two award-winning beaches, scenic river views, and captivating architecture like the Stage by the Sea, it's a popular destination for all. Leisure options include golf, cycling, and the Littlehampton WAVE Swimming and Sports Centre for indoor fun.





First Floor

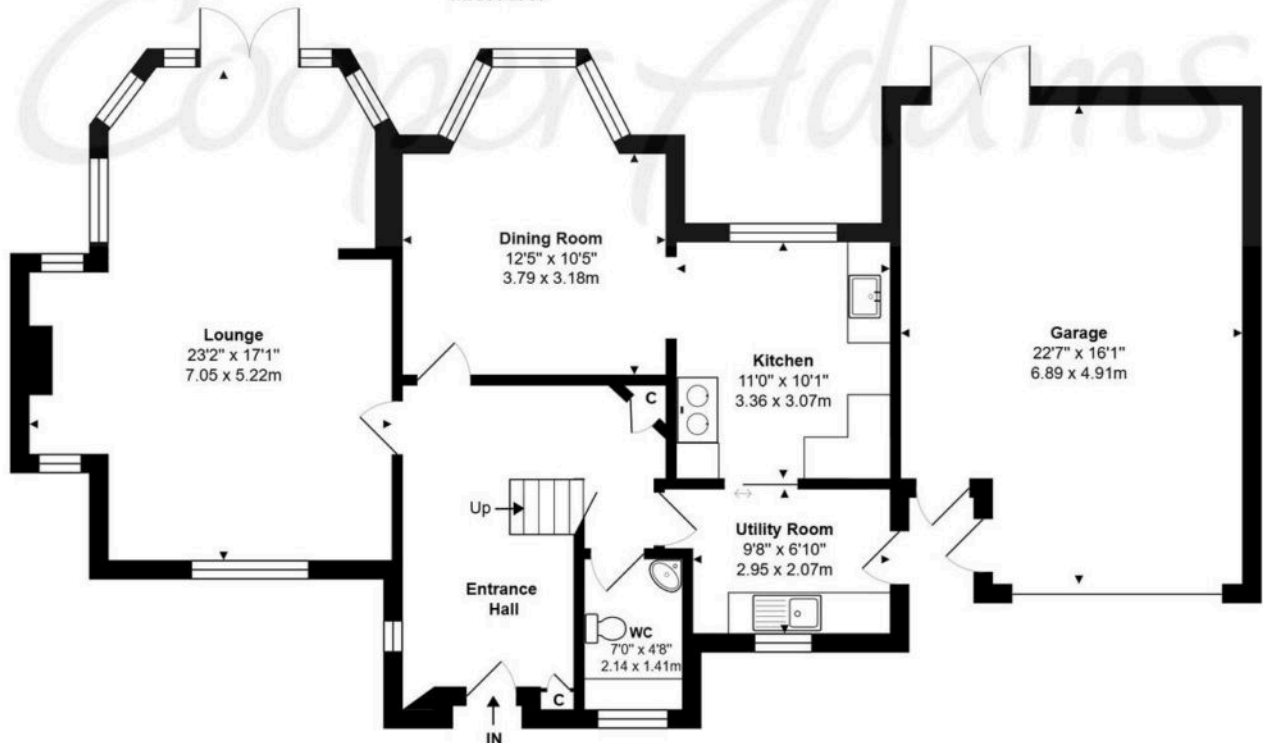

Ground Floor

Rope Walk, Littlehampton, BN17 5DE

Total Approx. Floor Area 2022 ft² ... 187.9 m² (Includes Garage)

Whilst every attempt has been made to ensure the accuracy of the floor plan contained here, measurements are approximate and no responsibility is taken for any error, omission or mis-statement.
This plan is for illustrative purposes only and should be used as such by any prospective purchaser.
Prepared by 1st Image 2025

Council Tax band: D, Energy Efficiency Rating: E

This material is protected by laws of copyright which is owned by Cooper Adams. Whilst every attempt has been made to ensure the accuracy of these details and floor plan contained here, they do not constitute any offer or contract or part thereof. All measurements are always maximum measurements into bay windows, alcoves and for L shaped rooms. No guarantee is given on total square footage taken from the floor plan. The details, pictures, maps and floor plans are for illustration purposes only and not to scale. Any appliances and/or services have not been tested. Cooper Adams is a trading name of Cooper Adams Estates Limited registered at Bishopstone, Registered in England and Wales. Our registered number is 07127482. Our VAT Number is 982847172.

Lettings | Sales | Free valuations | Land & New Homes | Mortgages

FULL DETAILS OF THE MATERIAL INFORMATION ARE ON OUR WEBSITE - VIEWING STRICTLY BY APPOINTMENT WITH COOPER ADAMS

FOR MORE PHOTOS AND TO BOOK A VIEWING VISIT OUR WEBSITE - Tel: 01903 791 792 - www.cooper-adams.com