



171 Buryfield Road, Solihull, B91 2BB

VIEWINGS ARE ESSENTIAL at this EXTENDED AND TASTEFULLY PRESENTED detached family home. The property is ideally located for the borough's excellent local schools, is within walking distance to Solihull town centre and its fantastic amenities to include the renowned Touchwood Shopping Centre, the Midlands motorway network and Birmingham International Airport.

- Thoughtfully Extended
- Convenient Location
- Viewings Essential
- Four Double Bedrooms



PROPERTY DESCRIPTION

This stunning family home simply must be viewed to appreciate the spacious accommodation on offer which in brief affords porch, entrance hallway, lounge with bay window overlooking the front elevation and stunning re-fitted open plan kitchen/diner with two bi-fold doors, and a guest cloakroom.

To the first floor there is the re-fitted family bathroom, four double bedrooms and a re-fitted Jack & Jill en-suite shower room.

OUTSIDE

The property benefits from an extensive drive offering the parking of numerous vehicles and a single garage with side store room. Whilst to the outside there is a private mainly laid to lawn rear garden with patio area.





VIEWINGS

At short notice with DM & Co. Homes on 0121 775 0101 or by email sales@dmandcohomes.co.uk.

GENERAL INFORMATION

Tenure: We are advised by the vendor that the property is Freehold with vacant possession upon completion.

However, we would advise that you check this with your legal advisor before exchanging contracts.

Services: All mains services are connected to the property. However, it is advised that you confirm this at point of offer.

Local Authority: Solihull Metropolitan Borough Council.

OTHER SERVICES

DM & Co are pleased to offer the following services:-

Residential Lettings: If you are considering renting a property or letting your property, please contact the office on 0121 775 0101.

Mortgage Services: If you would like advice on the best mortgages available, please contact us on 0121 775 0101.

WANT TO SELL YOUR PROPERTY?

Call DM & Co. Homes on 0121 775 0101 to arrange your FREE no obligation market appraisal and find out why we are Solihull's fastest growing Estate Agency.

Agents Note: Whilst every care has been taken to prepare these sales particulars, they are for guidance purposes only. All measurements are approximate and for general guidance purposes only and whilst every care has been taken to ensure their accuracy, they should not be relied upon and potential buyers are advised to recheck the measurements.

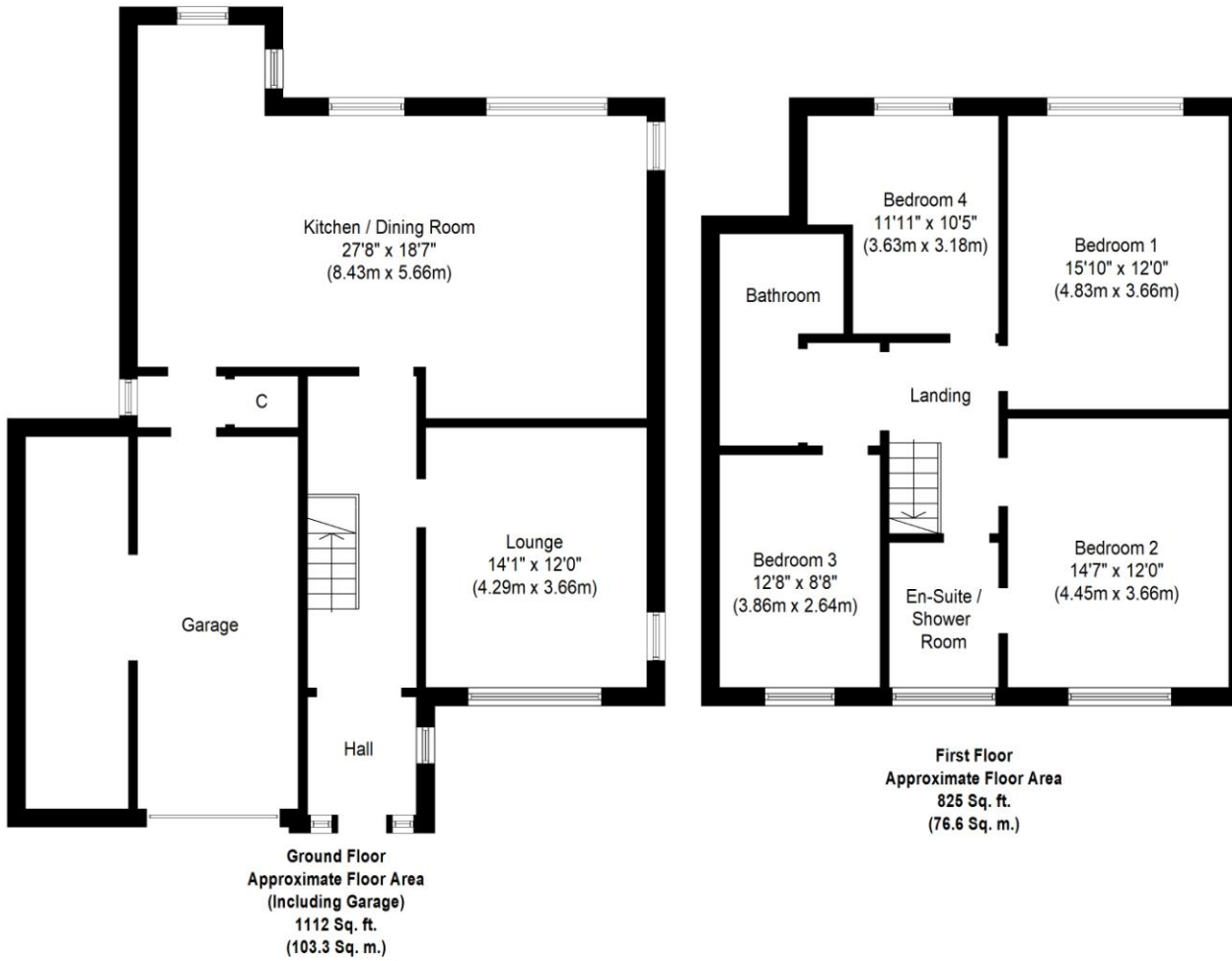

Whilst every attempt has been made to ensure the accuracy of the floor plan contained here, measurements of doors, windows, rooms and any other items are approximate and no responsibility is taken for any error, omission, or mis-statement. This plan is for illustrative purposes only and should be used as such by any prospective purchaser or tenant. The services, systems and appliances shown have not been tested and no guarantee as to their operability or efficiency can be given.
Copyright V360 Ltd 2020 | www.houseviz.com

