

Need a Mortgage in principle to make offers? Call us now for quick assistance!  
0121 775 0101



Do you need to sell? Start your journey now! Call us we can help.  
0121 775 0101



**SCAN FOR MORE INFO**  
**SIZE** - 834 Sq Ft  
**TENURE** - Freehold  
**COUNCIL TAX** - Solihull MBC - B  
**BROADBAND** - Upload Max 1000 Mbps  
 Download Max 1000 Mbps  
**MOBILE** - O2  
**EPC** - D - 62  
**PARKING** - Off Road Parking  
**FLOODRISK** - Very Low  
**SERVICES** - Mains  
**COVENANTS** - N/A

Are you an investor interested in expanding your portfolio?

Call 0121 775 0101 to provide your investment criteria for alerts.

## BERWOOD GROVE

Asking Price of £195,000

Presenting a charming three-bedroom terraced home in Berwood Grove, perfect for growing families or first time buyers. Offering a living room with an electric fire, a kitchen/diner and a landscaped south east facing garden. Within close proximity to local amenities and travel links and no upward chain, this is an opportunity not to be missed.

### FEATURES

- Three Bedroom Terrace
- Living Room
- Kitchen/Diner
- Principal Bedroom with Built-In Wardrobes
- Two Further Bedrooms
- Family Bathroom
- South East Facing Garden
- Close to Local Amenities and Travel Links
- Off Road Parking
- None-Standard Construction - Concrete LPS Build



### Sneak Peeks

Every week, we unveil "Sneak Peeks," a feature showcasing exclusive properties before they hit Rightmove and other platforms.

### The Landlord Club

Join our Landlord Club for weekly updates on legislation, market trends, and our Letting Director's 'Investment Pick of the Week' for optimal ROI.

### HTSPMD

Tune into 'How's The Solihull Property Market Dom' weekly for a quick, insightful snapshot of the market.

### The Mortgage Update

Get weekly insights and the best deals with our Mortgage Update, your shortcut to navigating the complex mortgage landscape confidently.

SCAN TO VIEW OUR WEEKLY FILMS & SUBSCRIBE

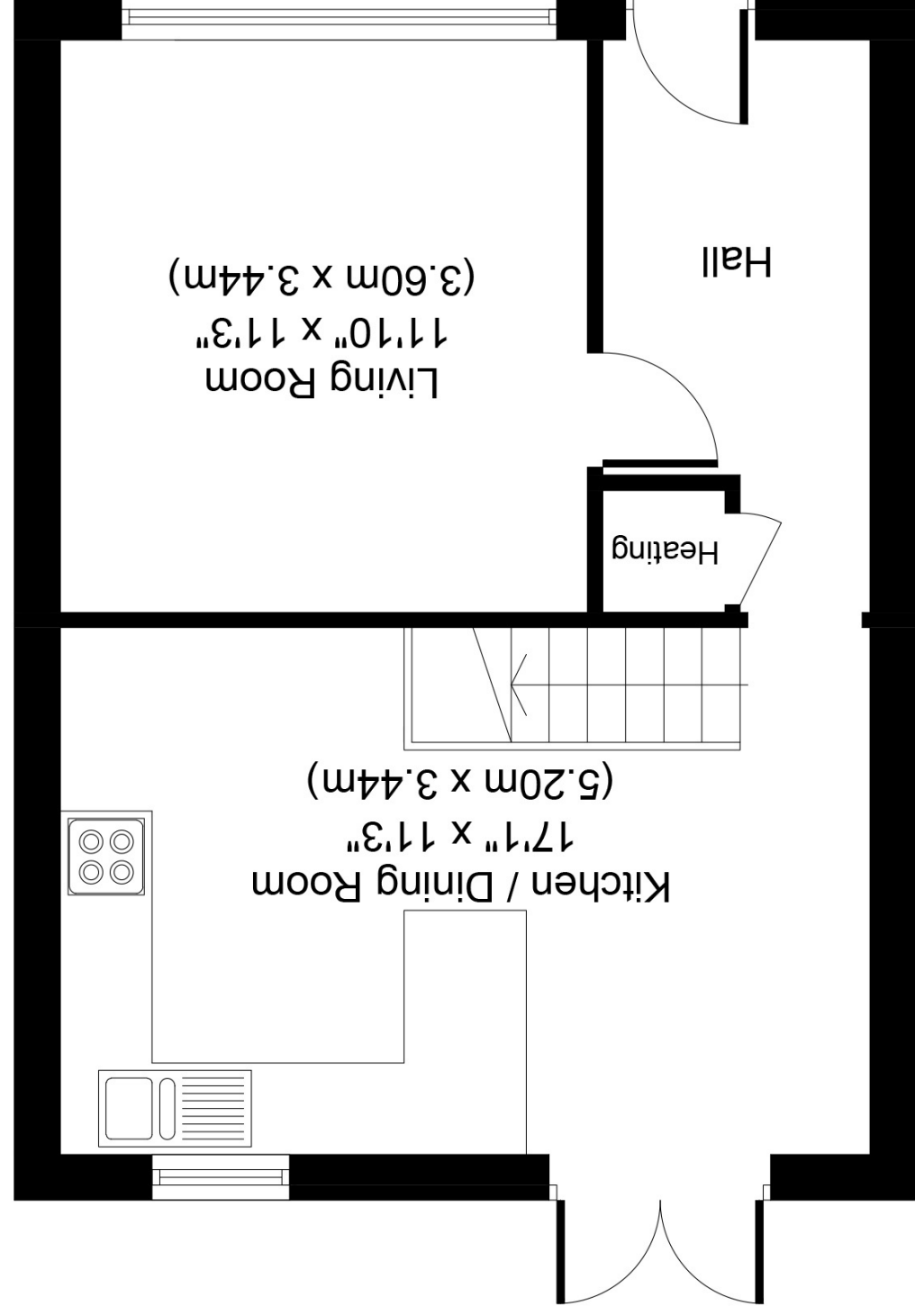

**Ground Floor**  
**417 Sq. ft.**  
**Approximate Floor Area**  
**(38.7 Sq. m.)**

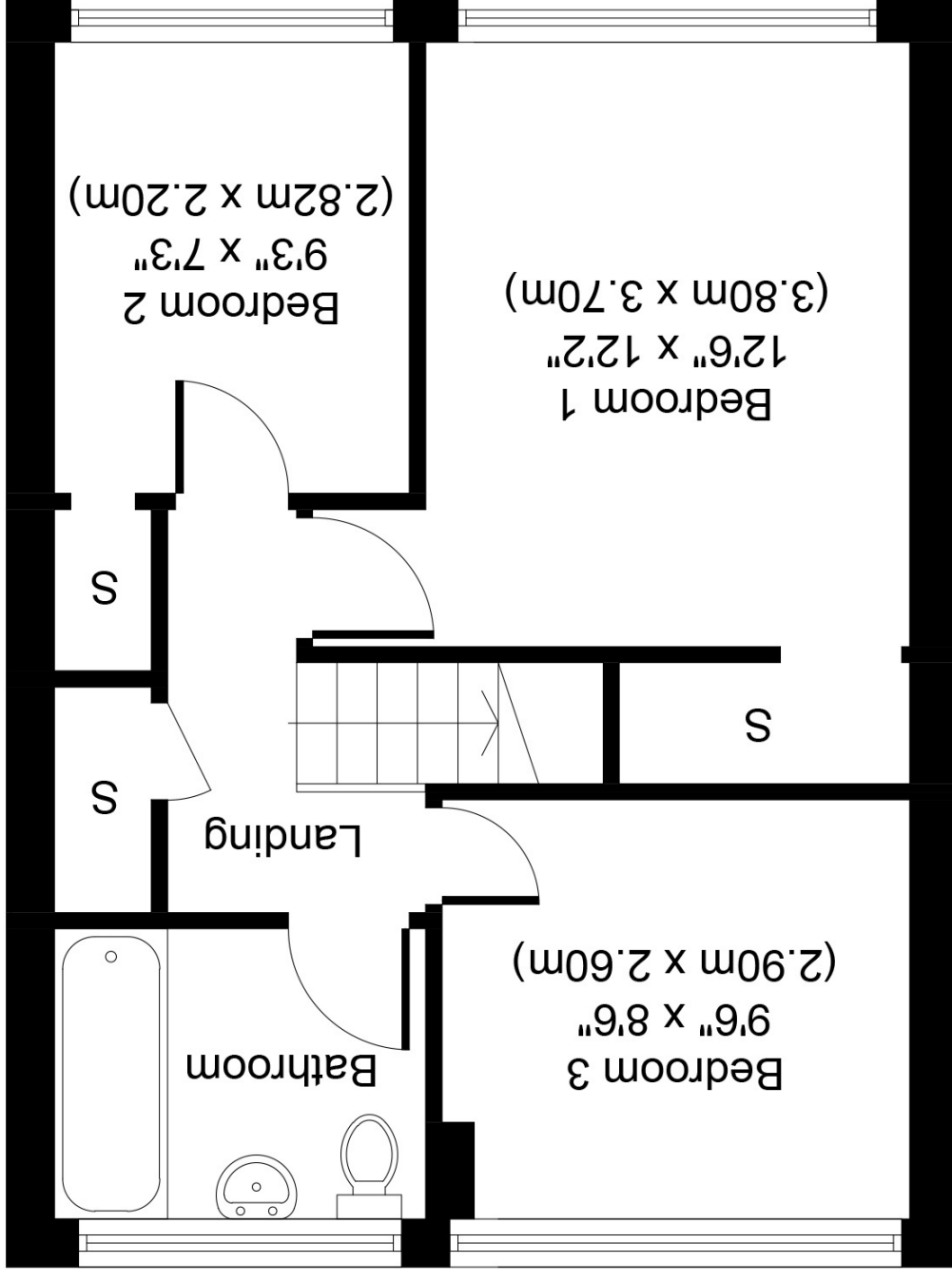

**First Floor**  
**417 Sq. ft.**  
**Approximate Floor Area**  
**(38.7 Sq. m.)**

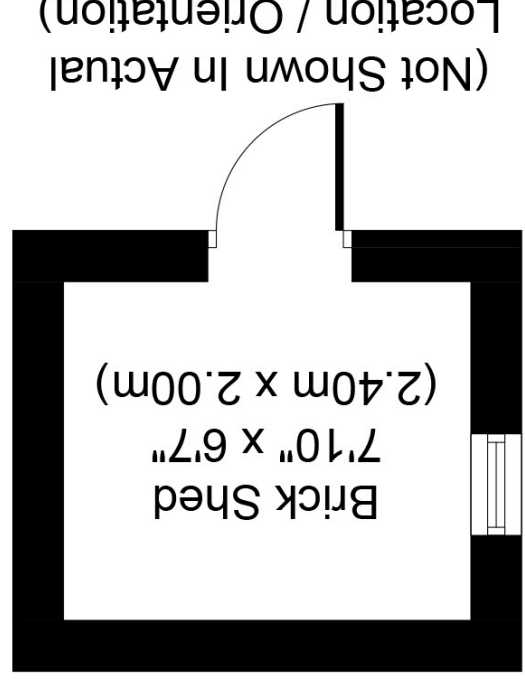

**Approximate Floor Area**  
**52 Sq. ft.**  
**Approximate Floor Area**  
**(4.8 Sq. m.)**

(Not Shown In Actual  
 Location / Orientation)

Whilst every attempt has been made to ensure the accuracy of the floor plan contained here, measurements of doors, windows, rooms and any other items are approximate and no responsibility is taken for any error, omission, or mis-statement. The measurements should not be relied upon for valuation, transaction and/or funding purposes. This plan is for illustrative purposes only and should be used as such by any prospective purchaser or tenant. The services, systems and appliances shown have not been tested and no guarantee as to their operability or efficiency can be given.  
 Copyright V360 Ltd 2023 | www.houseviz.com