

Need a Mortgage in principle to make offers? Call us now for quick assistance!  
0121 775 0101



Do you need to sell? Start your journey now! Call us we can help.  
0121 775 0101



## BROWNSOVER CLOSE

Offers Over £175,000



### SCAN FOR MORE INFO

**SIZE** - 721 Sq Ft  
**TENURE** - Freehold  
**COUNCIL TAX** - Solihull MBC - B  
**BROADBAND** - Upload Max 100 Mbps  
 Download Max 1000 Mbps  
**MOBILE** - TBC  
**EPC** - C - 74  
**PARKING** - Off Road Parking  
**FLOODRISK** - Very Low  
**SERVICES** - Mains  
**COVENANTS** - N/A

Discover this delightful terraced house, a perfect buy-to-let opportunity in a sought-after location. Boasting a solid 5.5% rental yield with a tenant already in place, this property is an ideal choice for both new and seasoned landlords. Its proximity to essential amenities and transport links adds to its appeal.

### FEATURES

- First Time Buyer Opportunity
- Potential Yield 5.5%
- Two Double Bedrooms
- Lounge
- Dining Kitchen
- Family Bathroom
- Enclosed Rear Garden
- Off Road Parking in Designated Area
- Close to Amenities

Are you an investor interested in expanding your portfolio?

Call 0121 775 0101 to provide your investment criteria for alerts.

### Sneak Peeks

Every week, we unveil "Sneak Peeks," a feature showcasing exclusive properties before they hit Rightmove and other platforms.

### HTSPMD

Tune into 'How's The Solihull Property Market Dom' weekly for a quick, insightful snapshot of the market.

### The Landlord Club

Join our Landlord Club for weekly updates on legislation, market trends, and our Letting Director's 'Investment Pick of the Week' for optimal ROI.

### The Mortgage Update

Get weekly insights and the best deals with our Mortgage Update, your shortcut to navigating the complex mortgage landscape confidently.



SCAN TO VIEW OUR WEEKLY FILMS & SUBSCRIBE

**Ground Floor**  
Approx. 35.1 sq. metres (378.3 sq. feet)

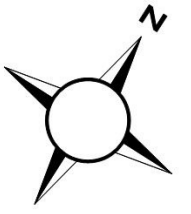
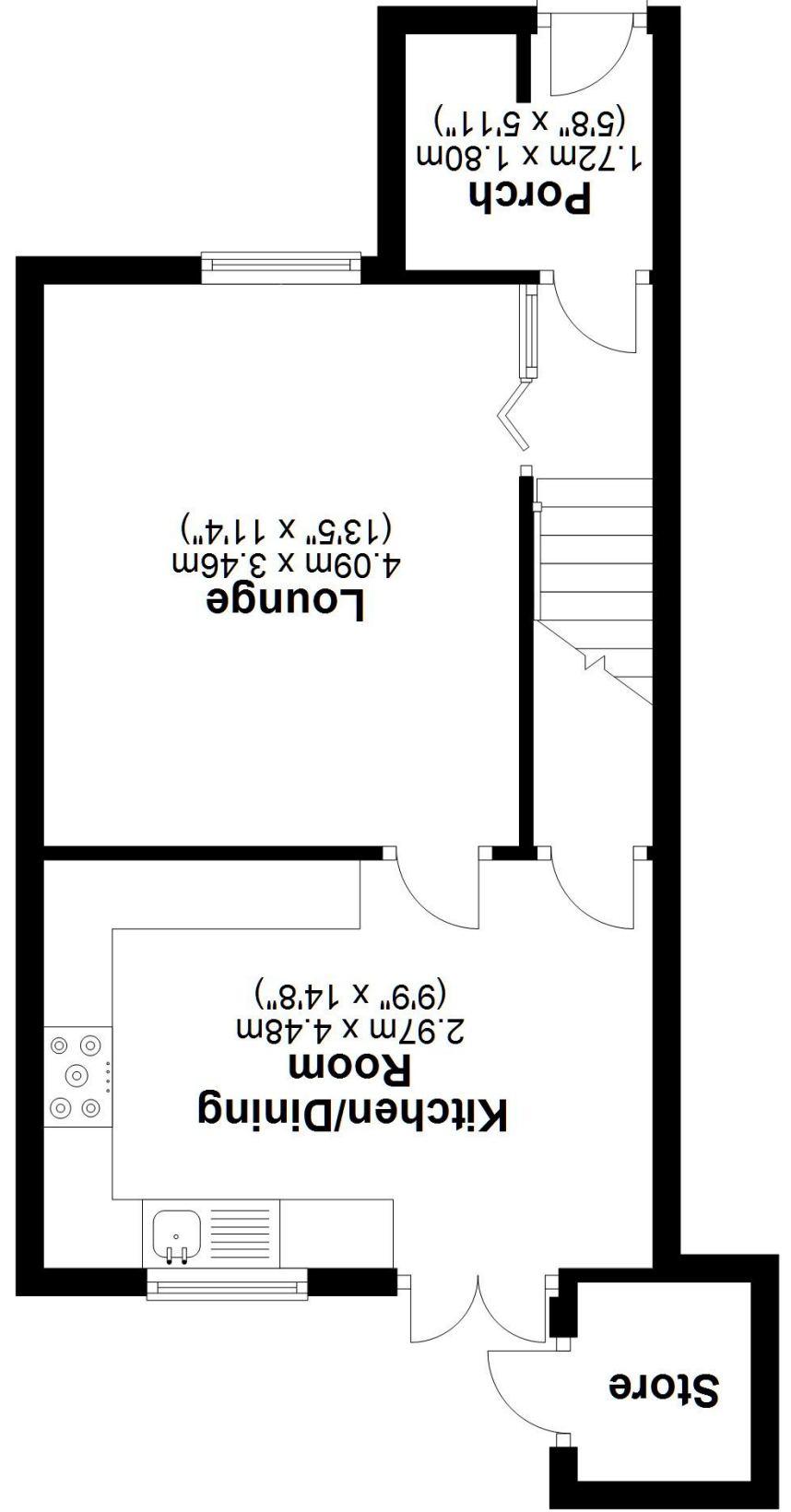

**First Floor**  
Approx. 31.9 sq. metres (343.4 sq. feet)

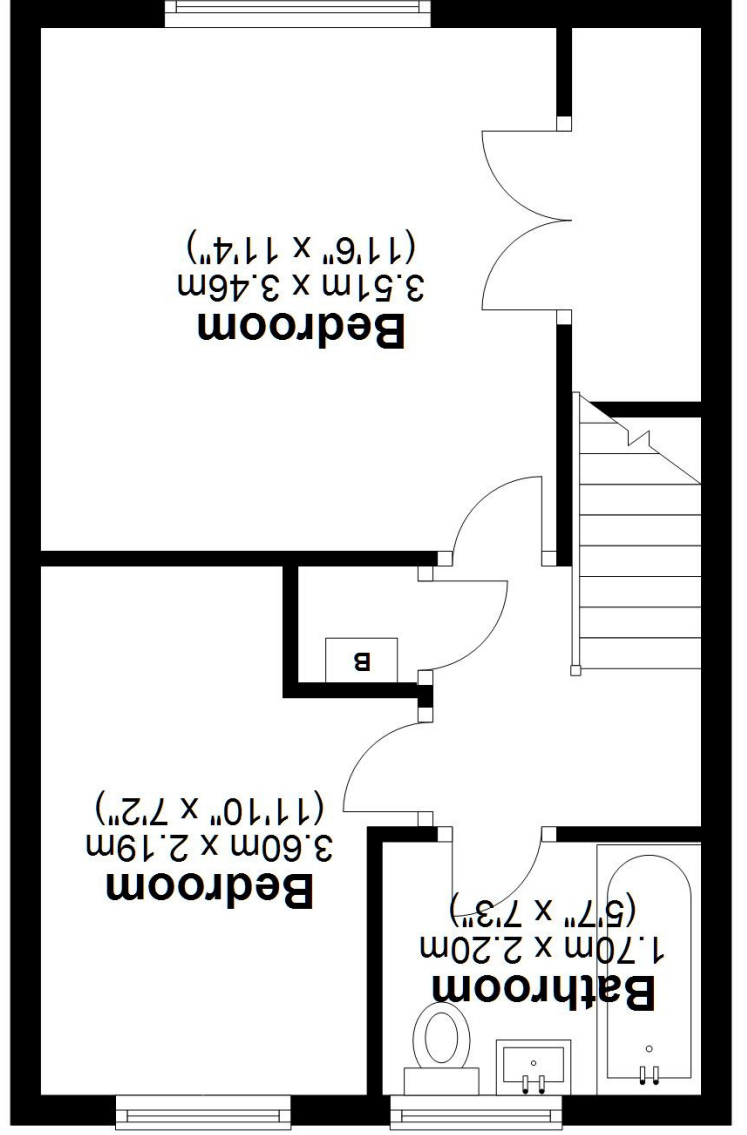

**Total area: approx. 67.0 sq. metres (721.7 sq. feet)**

This floor plan is for illustration purposes only, this is not intended to be a measured/scaled survey or comply with RICS guidelines. All measurements (including total floor area) openings, orientation and floor area are approximate. No details are guaranteed, they cannot be relied upon for any purpose and do not form part of any agreement. A party must rely upon its own inspection(s). No responsibility is taken for any error, omission, or mis-statement.  
Plan produced using PlanUp.