

Need a Mortgage in principle
to make offers? Call us now
for quick assistance!
0121 775 0101



Do you need to sell?
Start your journey now!
Call us we can help.
0121 775 0101



SCAN FOR MORE INFO
SIZE - 1686 Sq Ft
TENURE - Freehold
COUNCIL TAX - Solihull Metropolitan Borough Council - E
BROADBAND - Upload Max 1000Mbps
Download Max 1800Mbps
MOBILE - 02
EPC - C - 74
PARKING - For at least 5 Cars
FLOODRISK - Very Low
SERVICES - Mains
COVENANTS - N/A

Are you an investor
interested in expanding your
portfolio?

**Call 0121 775 0101 to provide your
investment criteria for alerts.**

PROSPECT LANE

Solihull, B91

This impressive five-bedroom detached house has been thoughtfully extended and fully renovated to provide a perfect blend of classic charm and modern convenience. This property is not just a house; it is a wonderful family home that offers comfort, style and a prime location in the sought-after area of Solihull. Whether you are looking to settle down or invest, this residence is sure to impress.

FEATURES

- Extended & Fully Renovated Detached Property
- Kitchen/Family/Dining Room
- Spacious Living Room
- Further Reception Room/Home Office/Ground Floor Bedroom
- Luxurious Ground Floor Shower Room with Walk In Shower
- Principal Bedroom with En-Suite Bathroom & Fitted Wardrobes
- Four Further Good Sized Bedrooms
- Family Bathroom
- Private Rear Garden
- Large Driveway for up to Five Vehicles



SCAN TO **VIEW OUR
WEEKLY FILMS &
SUBSCRIBE**

Sneak Peeks

Every week, we unveil "Sneak Peeks," a feature showcasing exclusive properties before they hit Rightmove and other platforms.

The Landlord Club

Join our Landlord Club for weekly updates on legislation, market trends, and our Letting Director's 'Investment Pick of the Week' for optimal ROI.

HTSPMD

Tune into 'How's The Solihull Property Market Dom' weekly for a quick, insightful snapshot of the market.

The Mortgage Update

Get weekly insights and the best deals with our Mortgage Update, your shortcut to navigating the complex mortgage landscape confidently.

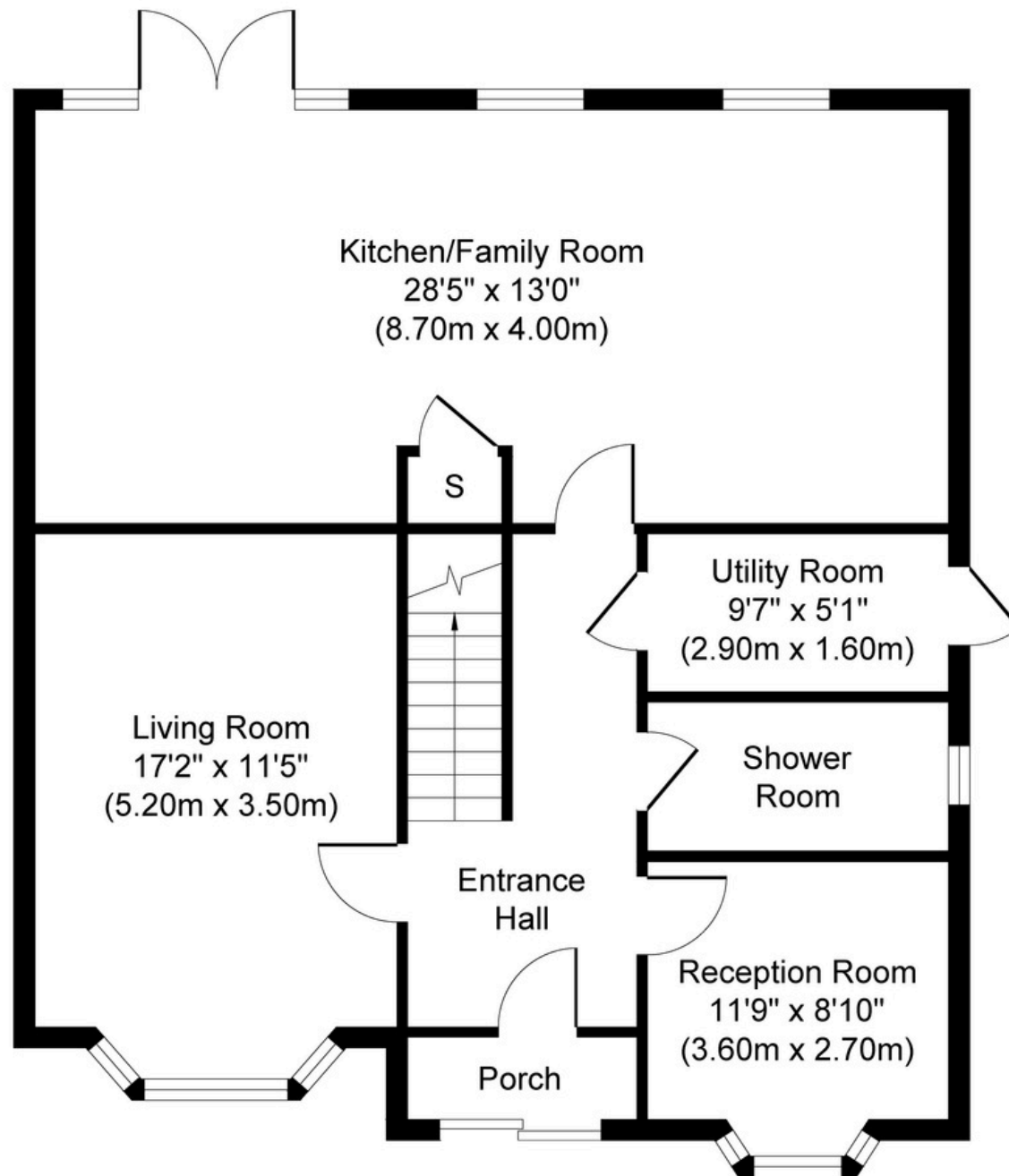

Ground Floor
Approximate Floor Area
874 sq. ft
(81.20 sq. m)

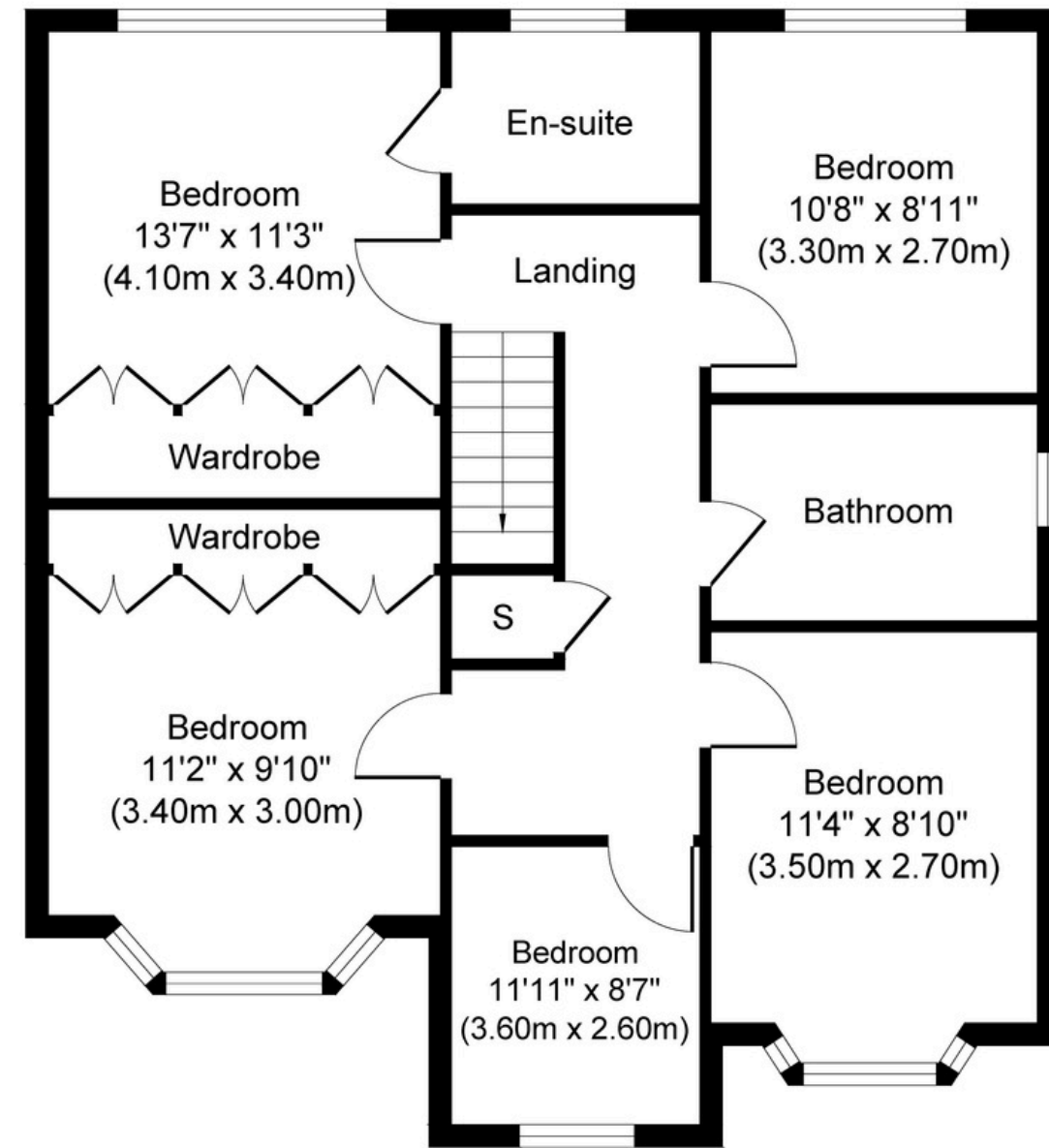

First Floor
Approximate Floor Area
812 sq. ft
(75.40 sq. m)

Whilst every attempt has been made to ensure the accuracy of the floor plan contained here, measurements of doors, windows, rooms and any other items are approximate and no responsibility is taken for any error, omission, or mis-statement. The measurements should not be relied upon for valuation, transaction and/or funding purposes. This plan is for illustrative purposes only and should be used as such by any prospective purchaser or tenant.

The services, systems and appliances shown have not been tested and no guarantee as to their operability or efficiency can be given.

Copyright V360 Ltd 2025 | www.houseviz.com