



**DM&Co.**  
— SALES & LETTINGS —

53 Lillington Road  
Shirley B90 2RY

This Well-Presented 2-Bedroom First Floor  
Maisonette In A Quiet Location Is Offered  
Unfurnished And Available To Move Into At  
The Mid Of September.





## DETAILS

This well presented first floor maisonette is offered unfurnished and is available end of August.

Access to the property is via a private entrance & has stairs leading to the main floor.

The property compromises of a spacious living area, sperate kitchen with gas hob, electric oven, fridge/freezer & washing machine.

Furthermore, there are two double bedrooms & a modern shower room.

Solihull Council - Tax Band B



## OUTSIDE

Parking is provided in a communal area and there is further parking on road.

This maisonette also boasts the use of a private garage.

## VIEWINGS

At short notice with DM & Co. Homes on  
0121 775 0101 or by email  
[lettings@dmandcohomes.co.uk](mailto:lettings@dmandcohomes.co.uk)



## GENERAL INFORMATION

The location offers a quiet surrounding & is within walking distance to local amenities & great schools.

Mobile Coverage In Your Area - EE, O2, Vodafone, Three

Broadband Coverage In Your Area - Openreach, Virgin Media

## OTHER SERVICES

DM & Co are pleased to offer the following services:-

**Residential Lettings:** If you are considering letting your property, please contact the office on 0121 775 0101.

**Mortgage Services:** If you would like advice on the best mortgages available, please contact us on 0121 775 0101.

Agents Note: Whilst every care has been taken to prepare these sales particulars, they are for guidance purposes only. All measurements are approximate and are for general guidance purposes only and whilst every care has been taken to ensure their accuracy, they should not be relied upon and potential buyers are advised to recheck the measurements.



FEATURES

- Well-Presented First Floor Maisonette
- Spacious Living Area
- Separate Kitchen With Appliances
- Two Double Bedrooms
- Modern Shower Room
- Communal Parking
- Peaceful Location
- Holding Deposit - £219.00
- Security Deposit - £1096.15
- Available Mid September On An Unfurnished Basis

VIEWING

Book a viewing with Sole Agents DM & Co.  
Premium by phone or email:

📞 0121 775 0101

@ lettings@dmandcohomes.co.uk

Agents Note: Whilst every care has been taken to prepare these salesparticulars, they are for guidance purposes only. All measurements are approximate and are for general guidance purposes only and whilst every care has been taken to ensure their accuracy, they should not be relied upon and potential buyers are advised to recheck the measurements

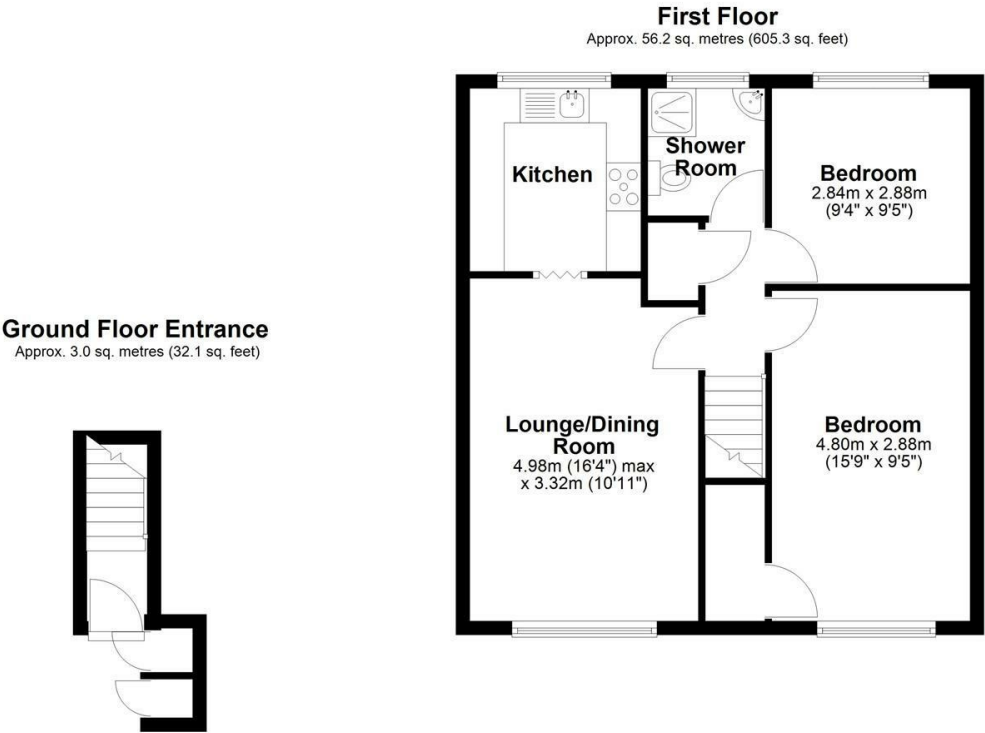

Total area: approx. 59.2 sq. metres (637.3 sq. feet)

This floor plan is for illustration purposes only, this is not intended to be a measured/scaled survey or comply with RICS guidelines. All measurements (including total floor area) openings, orientation and floor area are approximate. No details are guaranteed, they cannot be relied upon for any purpose and do not form part of any agreement. A party must rely upon its own inspection(s). No responsibility is taken for any error, omission, or mis-statement.  
Plan produced using PlanUp.

