

Need a Mortgage in principle
to make offers? Call us now
for quick assistance!
0121 775 0101

DM&Co.
SALES & LETTINGS



Do you need to sell?
Start your journey now!
Call us we can help.
0121 775 0101

DM&Co.
SALES & LETTINGS



SCAN FOR MORE INFO
SIZE - 790 Sq Ft
TENURE - Freehold
COUNCIL TAX - Solihull MBC - E
BROADBAND - Upload Max 1000Mbps
Download Max 1800Mbs
MOBILE - Vodaphone
EPC - C - 71
PARKING - For at least 2 Cars
FLOODRISK - Very Low
SERVICES - Mains
COVENANTS - N/A

Are you an investor
interested in expanding your
portfolio?

Call **0121 775 0101** to provide your
investment criteria for alerts.

BARFORD ROAD
Shirley, B90

A tastefully presented mid-terraced house offering a perfect blend of comfort and convenience. The property presents a wonderful opportunity for those seeking a comfortable home in a desirable area. With its spacious living areas, modern amenities and convenient location, it is sure to attract interest from a variety of buyers.

FEATURES

- Tastefully Presented Mid Terraced Property
- Dual Aspect Lounge/Dining Room
- Modern Fitted Kitchen
- Two Good Sized Double Bedrooms
- Third Single/Nursery/Home Office
- Modern Family Bathroom
- Mature Long Rear Garden
- Driveway Parking
- Excellent School Catchment
- Convenient Location



SCAN TO **VIEW OUR**
WEEKLY FILMS &
SUBSCRIBE

Sneak Peeks

Every week, we unveil "Sneak Peeks," a feature showcasing exclusive properties before they hit Rightmove and other platforms.

The Landlord Club

Join our Landlord Club for weekly updates on legislation, market trends, and our Letting Director's 'Investment Pick of the Week' for optimal ROI.

HTSPMD

Tune into 'How's The Solihull Property Market Dom' weekly for a quick, insightful snapshot of the market.

The Mortgage Update

Get weekly insights and the best deals with our Mortgage Update, your shortcut to navigating the complex mortgage landscape confidently.

Ground Floor

Approx. 34.1 sq. metres (367.6 sq. feet)

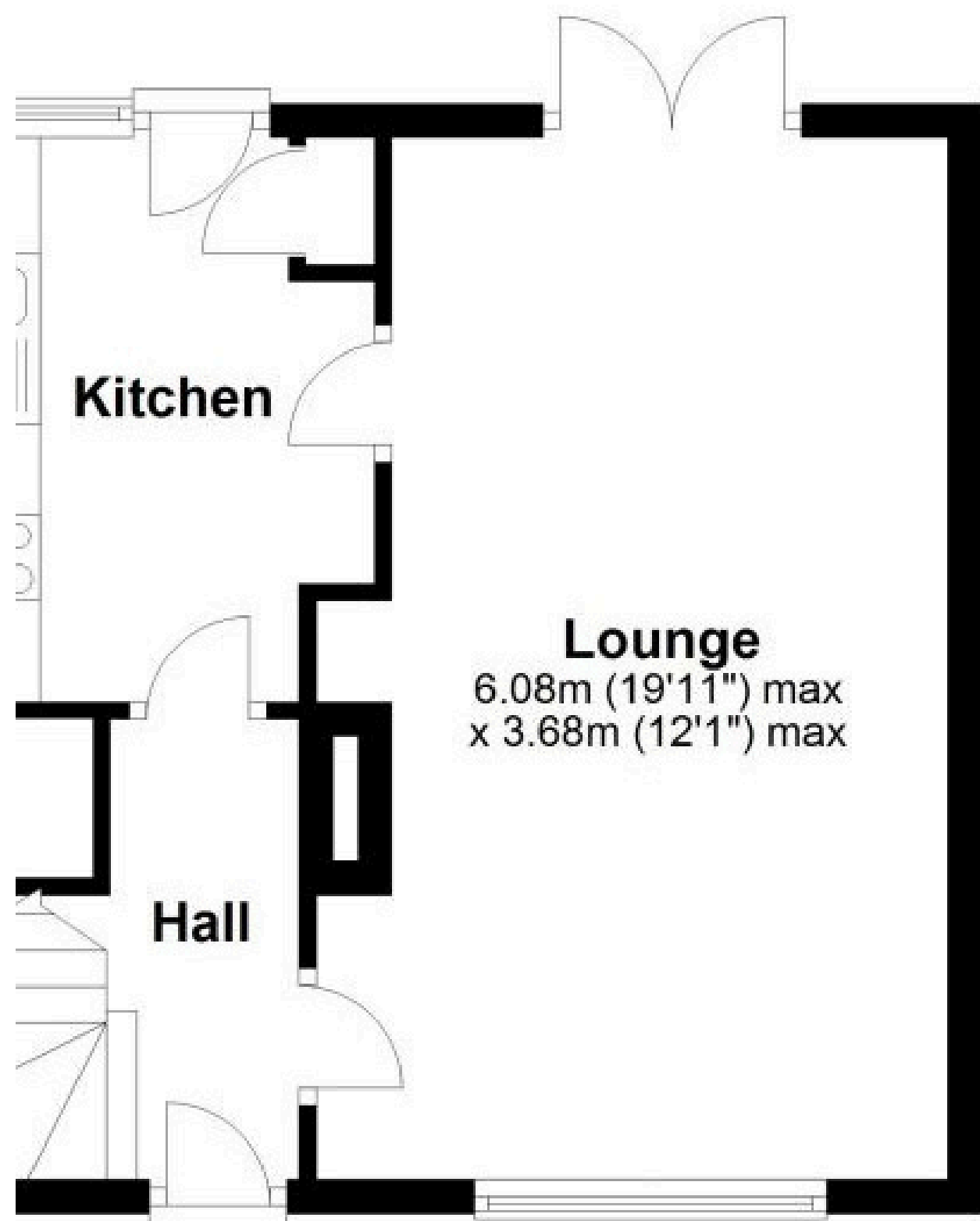

First Floor

Approx. 39.3 sq. metres (423.3 sq. feet)



Total area: approx. 73.5 sq. metres (790.9 sq. feet)

Please note this plan is for illustration purposes only. All measurements are approximate and should be checked by prospective buyers/tenants. No responsibility is taken for any error, omission, or mis-statement.

Plan produced using PlanUp.