

Need a Mortgage in principle
to make offers? Call us now
for quick assistance!
0121 775 0101

DM&Co.
SALES & LETTINGS



Do you need to sell?
Start your journey now!
Call us we can help.
0121 775 0101

DM&Co.
SALES & LETTINGS



SCAN FOR MORE INFO
SIZE - 862 Sq Ft
TENURE - Freehold
COUNCIL TAX - Solihull Metropolitan Borough Council - C
BROADBAND - Upload Max 1000Mbps
Download Max 1800Mbps
MOBILE - Three O2
EPC - D - 64
PARKING - For at least 4 Cars
FLOODRISK - Very Low
SERVICES - Mains
COVENANTS - N/A

LIGHTORNE ROAD

Solihull, B91

Situated in a quiet cul-de-sac, is this charming semi-detached house, built in 1930, offering a delightful blend of modern living and classic appeal. The property has been thoughtfully updated throughout, making it an ideal family home. With no upward chain, this home is ready for you to move in and enjoy.

FEATURES

- No Upward Chain
- Neutrally & Tastefully Presented Throughout
- Lounge with Bay Window to Front
- Modern Fitted Kitchen/Diner
- Two Double Bedrooms
- Third Single/Nursery/Home Office
- Family Bathroom
- Private South Facing Garden
- Four Car Driveway
- Convenient Location

Are you an investor
interested in expanding your
portfolio?

Call **0121 775 0101** to provide your
investment criteria for alerts.



SCAN TO **VIEW OUR**
WEEKLY FILMS &
SUBSCRIBE

Sneak Peeks

Every week, we unveil "Sneak Peeks," a feature showcasing exclusive properties before they hit Rightmove and other platforms.

The Landlord Club

Join our Landlord Club for weekly updates on legislation, market trends, and our Letting Director's 'Investment Pick of the Week' for optimal ROI.

HTSPMD

Tune into 'How's The Solihull Property Market Dom' weekly for a quick, insightful snapshot of the market.

The Mortgage Update

Get weekly insights and the best deals with our Mortgage Update, your shortcut to navigating the complex mortgage landscape confidently.

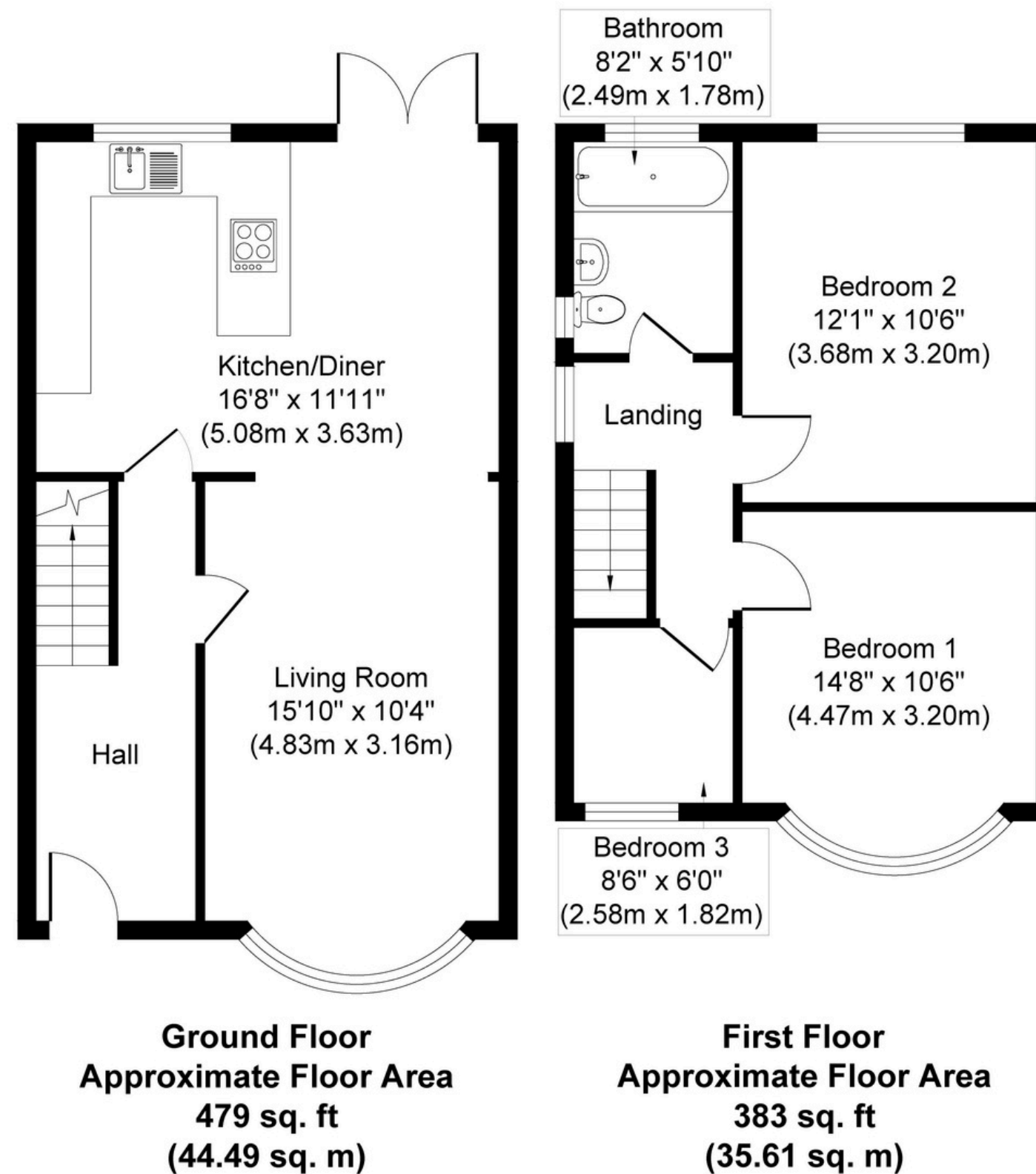

Whilst every attempt has been made to ensure the accuracy of the floor plan contained here, measurements of doors, windows, rooms and any other items are approximate and no responsibility is taken for any error, omission, or mis-statement. The measurements should not be relied upon for valuation, transaction and/or funding purposes. This plan is for illustrative purposes only and should be used as such by any prospective purchaser or tenant.

The services, systems and appliances shown have not been tested and no guarantee as to their operability or efficiency can be given.

Copyright V360 Ltd 2025 | www.houseviz.com