

Need a Mortgage in principle  
to make offers? Call us now  
for quick assistance!  
**0121 775 0101**



Do you need to sell?  
Start your journey now!  
Call us we can help.  
**0121 775 0101**



**SCAN FOR MORE INFO**  
**SIZE** - 820 Sq Ft  
**TENURE** - Leasehold with 126 years remaining  
**SERVICE CHARGE** - £2,000 per annum approx.  
**COUNCIL TAX** - Solihull Metropolitan Borough Council - C  
**BROADBAND** - Upload Max 220Mbps  
Download Max 1800Mbps  
**MOBILE** - EE Three O2  
**EPC** - D - 67  
**PARKING** - For 1 Car Plus Single Garage  
**FLOODRISK** - Very Low  
**SERVICES** - Mains  
**COVENANTS** - N/A

## 6 KERESLEY CLOSE

Solihull, B91 2AD  
Offers in the region of £190,000

Situated in Keresley Close, this charming second-floor apartment presents an excellent opportunity for first-time buyers and investors alike. Offered with no upward chain, this property is part of a select development comprising just 29 apartments, ensuring a sense of community and tranquillity.

### FEATURES

- Ideal Opportunity for First Time Buyers or Investors
- Second Floor Apartment Offered with No Upward Chain
- Breakfast Kitchen
- Spacious Lounge/Dining Room
- Principal Double Bedroom with Wardrobes
- Second Good Sized Double Bedroom with Wardrobes
- Four Piece Bathroom
- Allocated Permit Parking Space & Single Garage
- Well Tended Communal Grounds
- Walking Distance to Solihull Town Centre

Are you an investor  
interested in expanding your  
portfolio?

**Call 0121 775 0101 to provide your investment criteria for alerts.**



SCAN TO **VIEW OUR**  
**WEEKLY FILMS &**  
**SUBSCRIBE**

### Sneak Peeks

Every week, we unveil "Sneak Peeks," a feature showcasing exclusive properties before they hit Rightmove and other platforms.

### The Landlord Club

Join our Landlord Club for weekly updates on legislation, market trends, and our Letting Director's 'Investment Pick of the Week' for optimal ROI.

### HTSPMD

Tune into 'How's The Solihull Property Market Dom' weekly for a quick, insightful snapshot of the market.

### The Mortgage Update

Get weekly insights and the best deals with our Mortgage Update, your shortcut to navigating the complex mortgage landscape confidently.



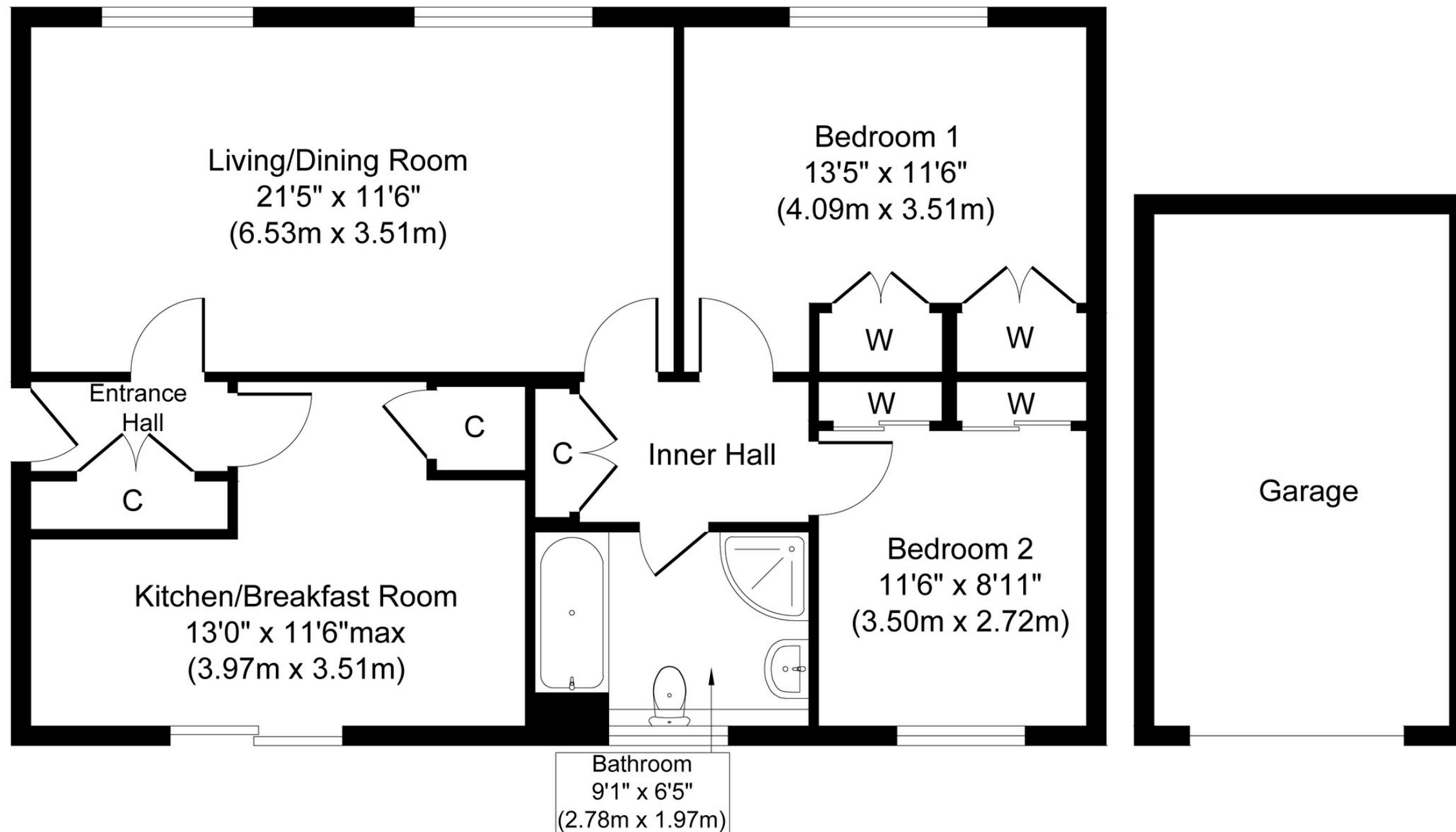

**Ground Floor**  
**Approximate Floor Area**  
**820 sq. ft**  
**(76.21 sq. m)**

**Garage**

Whilst every attempt has been made to ensure the accuracy of the floor plan contained here, measurements of doors, windows, rooms and any other items are approximate and no responsibility is taken for any error, omission, or mis-statement. The measurements should not be relied upon for valuation, transaction and/or funding purposes. This plan is for illustrative purposes only and should be used as such by any prospective purchaser or tenant.

The services, systems and appliances shown have not been tested and no guarantee as to their operability or efficiency can be given.

Copyright V360 Ltd 2025 | [www.houseviz.com](http://www.houseviz.com)