

Need a Mortgage in principle
to make offers? Call us now
for quick assistance!
0121 775 0101



Do you need to sell?
Start your journey now!
Call us we can help.
01564 777 314



SCAN FOR MORE INFO
SIZE - 747 Sq.Ft
TENURE - Leasehold
SERVICE CHARGE - £3,805.68 pa
GROUND RENT - £495 pa
COUNCIL TAX - Solihull Metropolitan Borough Council - D.
BROADBAND - Upload Superfast 16Mbps
Download Superfast 70Mbps
MOBILE - EE Vodafone
EPC - B - 82
PARKING - Private Parking
FLOODRISK - Very Low
SERVICES - Mains
COVENANTS - N/A

Are you an investor
interested in expanding your
portfolio?
Call 01564 777 314 to provide your
investment criteria for alerts.

21 Arden Grange

1649 High Street, Knowle, B93 0LL
Offers in the region of £350,000

Nestled in the heart of Knowle, this exquisite first-floor apartment is designed exclusively for those aged over 60, offering a perfect blend of modern living and convenience. This property, built in 2014, is presented to the market with no upward chain, making it an enticing opportunity for prospective buyers. This apartment is not just a home; it is a lifestyle choice, offering comfort, security, and a vibrant community atmosphere.

FEATURES

- First Floor Apartment for the Over 60's with Lift Access
- No Upward Chain
- Fabulous Location on Knowle High Street
- Bright Lounge with Modern Kitchen
- Principal Double Bedroom with En-Suite Bathroom
- Second Versatile Bedroom
- Shower Room,
- Feature Curved Balcony
- Stunning Landscaped Communal Grounds
- Private Parking



SCAN TO **VIEW OUR**
WEEKLY FILMS &
SUBSCRIBE



Sneak Peeks

Every week, we unveil "Sneak Peeks," a feature showcasing exclusive properties before they hit Rightmove and other platforms.



The Landlord Club

Join our Landlord Club for weekly updates on legislation, market trends, and our Letting Director's 'Investment Pick of the Week' for optimal ROI.



HTSPMD

Tune into 'How's The Solihull Property Market Dom' weekly for a quick, insightful snapshot of the market.



The Mortgage Update

Get weekly insights and the best deals with our Mortgage Update, your shortcut to navigating the complex mortgage landscape confidently.

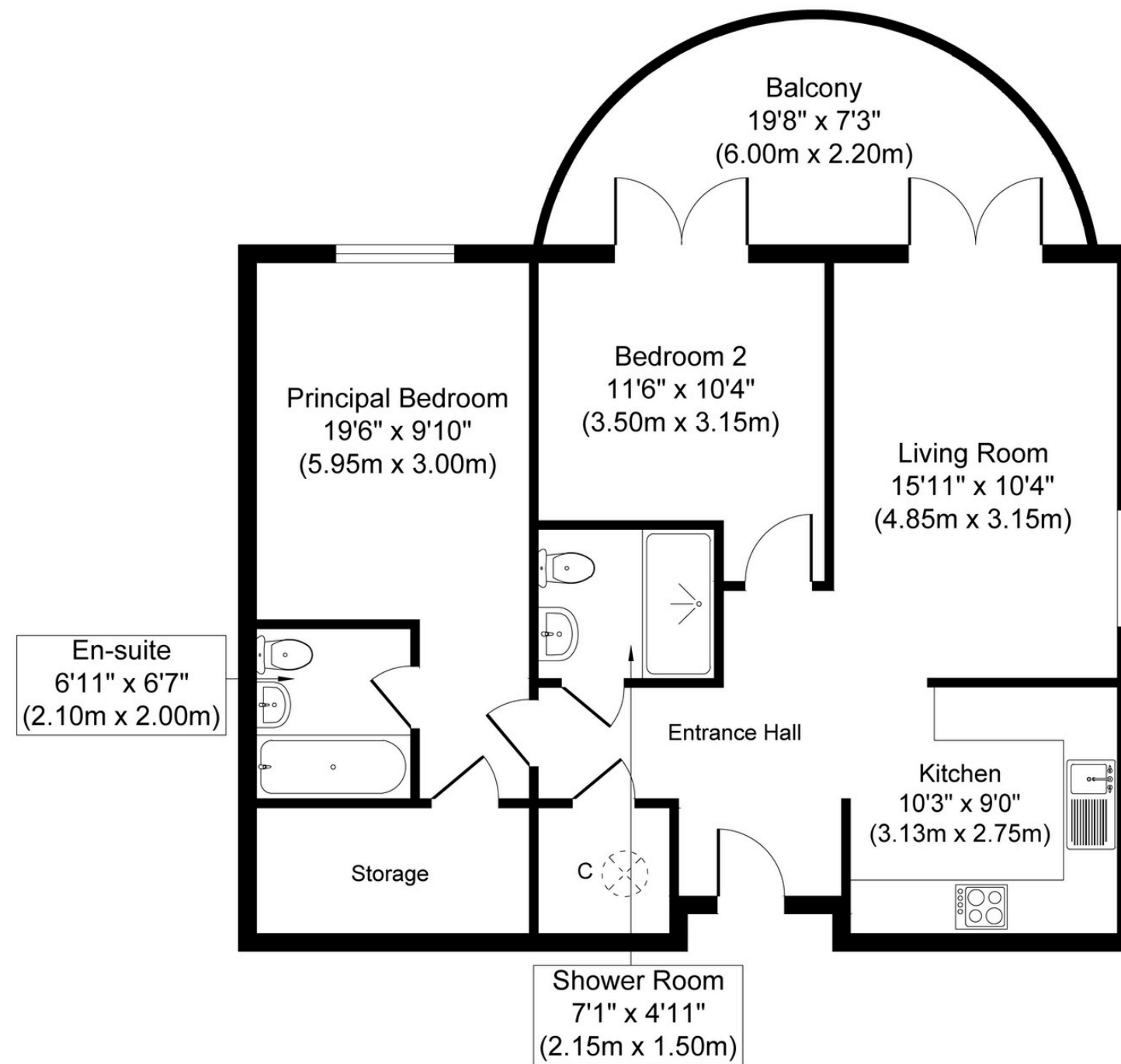

First Floor
Approximate Floor Area
747 sq. ft
(69.40 sq. m)

Whilst every attempt has been made to ensure the accuracy of the floor plan contained here, measurements of doors, windows, rooms and any other items are approximate and no responsibility is taken for any error, omission, or mis-statement. The measurements should not be relied upon for valuation, transaction and/or funding purposes. This plan is for illustrative purposes only and should be used as such by any prospective purchaser or tenant.

The services, systems and appliances shown have not been tested and no guarantee as to their operability or efficiency can be given.

Copyright V360 Ltd 2025 | www.houseviz.com