



**DM&Co.**  
— SALES & LETTINGS —

**65a Mill Lane  
Bentley Heath B93 8NN**

This Delightful First-Floor Maisonette Located In A Quiet Area  
Is Available From 9th September On An Unfurnished Basis.



## DETAILS

Your Text Here



## OUTSIDE

Your Text Here

## VIEWINGS

At short notice with DM & Co. Homes on  
0121 775 0101 or by email  
[lettings@dmandcohomes.co.uk](mailto:lettings@dmandcohomes.co.uk)





## GENERAL INFORMATION

Your Text Here



## OTHER SERVICES

DM & Co are pleased to offer the following services:-

**Residential Lettings:** If you are considering letting your property, please contact the office on 0121 775 0101.

**Mortgage Services:** If you would like advice on the best mortgages available, please contact us on 0121 775 0101.

Agents Note: Whilst every care has been taken to prepare these sales particulars, they are for guidance purposes only. All measurements are approximate and are for general guidance purposes only and whilst every care has been taken to ensure their accuracy, they should not be relied upon and potential buyers are advised to recheck the measurements.

FEATURES

- Well-Presented First Floor Maisonette
- Spacious Living Area
- Kitchen With Integrated Appliances
- One Double & One Single
- Modern Family Bathroom
- Garden Area & Single Garage
- Quiet Location
- Holding Deposit - £288.00
- Security Deposit - £1442.30
- Available 9th September On An Unfurnished Basis

SIZE

Total - sq ft

TENURE

Your Text Here

VIEWING

Book a viewing with Sole Agents DM & Co.  
Premium by phone or email:

📞 0121 775 0101

@ lettings@dmandcohomes.co.uk

Agents Note: Whilst every care has been taken to prepare these salesparticulars, they are for guidance purposes only. All measurements are approximate and are for general guidance purposes only and whilst every care has been taken to ensure their accuracy, they should not be relied upon and potential buyers are advised to recheck the measurements

Ground Floor  
Approx. 1.3 sq. metres (14.0 sq. feet)

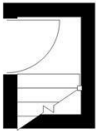

First Floor  
Approx. 58.4 sq. metres (628.8 sq. feet)

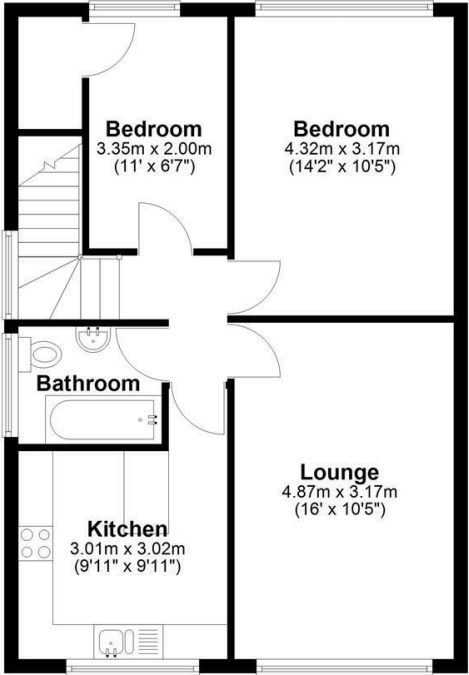

Total area: approx. 59.7 sq. metres (642.8 sq. feet)

This floor plan is for illustration purposes only, this is not intended to be a measured/scaled survey or comply with RICS guidelines. All measurements (including total floor area) openings, orientation and floor area are approximate. No details are guaranteed, they cannot be relied upon for any purpose and do not form part of any agreement. A party must rely upon its own inspection(s). No responsibility is taken for any error, omission, or mis-statement.  
Plan produced using PlanUp.

