



- PENTHOUSE APARTMENT
- OPEN PLAN LOUNGE/DINING ROOM
- ALLOCATED PARKING
- IMMACULATE PRESENTATION
- BALCONY WITH EXCELLENT VIEWS
- COMMUNAL GARDENS



**22 Brunell Close, London Road**  
Maidstone, ME16 0YW

**£219,500**

**NEW TO THE MARKET ... 2 BEDROOM 2RD FLOOR APARTMENT WITH ENSUITE AND BALCONY!**

**The Property**

The property features two double bedrooms . The master bedroom having an en-suite featuring a drench head shower, there is a fitted wardrobe. The open plan kitchen/living room is both spacious and filled with light. The kitchen features a range of luxury eye and floor level units with under unit lighting. There is an oven, hob & overhead, washing machine and dishwasher. The balcony with good views towards the North Downs. The family bathroom has a shower attachment The bedrooms are carpeted, the kitchen, bathroom & en-suite have ceramic tiling and the remainder of the apartment has wood effect flooring. Rarely available in an apartment is attic storage, and there are two storage cupboards in the hall way The property is heated by Gas fired Central Heating.

**The Location**

The property is within walking distance of the town centre with all it has to offer. Maidstone is renowned as a mecca for the shopping enthusiast, and if that is not enough Bluewater is only a 30 minute drive.

Lease - 115 Years

Ground Rent - £250 Per Annum

Service Charge - £450/£500 Per Annum

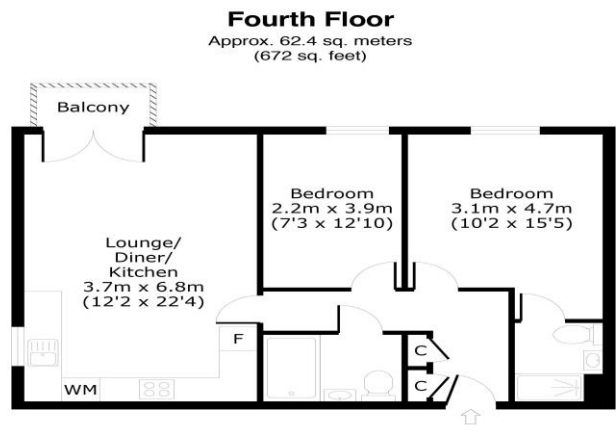
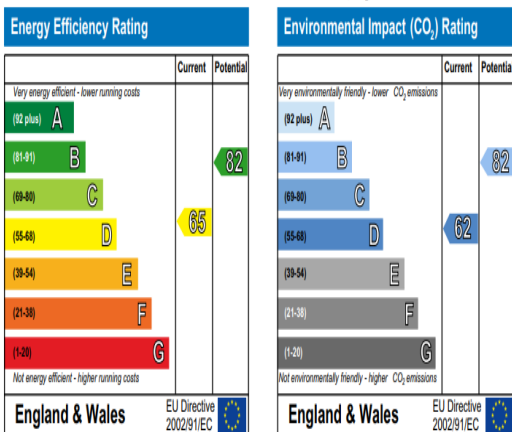

Total area: approx. 62.4 sq. meters (672 sq. feet)  
For illustration purposes only - not to scale