

AP MORGAN



Eachway, Rubery, Birmingham
£1,050 per month

Features:

- Refurbished mid-terraced house
- Sought after area
- Three bedrooms
- Spacious lounge
- Kitchen/diner
- Family bathroom
- Front and rear gardens
- On road parking

Description:

This recently refurbished, three-bedroom mid-terraced house is situated in the sought after area of Rubery, Birmingham. Ideal for those with families looking for a spacious home with amenities including shops, schools and parks conveniently located nearby.

Briefly comprising of an entrance hall, spacious lounge with understairs storage cupboard, open plan kitchen/diner, lobby with rear door leading into the garden, downstairs bathroom with bath and overhead shower, two double bedrooms with the master bedroom having a built in storage cupboard housing the boiler and finally a good sized single bedroom.

There is both a front and rear garden to the property with the rear being a very good size and having a side entry for ease of access from the front of the house.

On road parking is available along the front of the property.

Well positioned in Rubery, the property is ideal for well-regarded local schools and is within proximity to Rubery Town Centre, offering a range of high street shops, restaurants and takeaways. Rubery is approximately 10 miles from Birmingham City Centre and provides easy access for commutes via the M5 and M42.



Details:

Lounge 13'11" x 12'5" (4.24m x 3.78m)

Kitchen/Diner 15'11" x 8'2" (4.85m x 2.5m)

Bedroom One 15'11" x 10'9" (4.85m x 3.28m)

Bedroom Two 11'7" x 8'2" (3.53m x 2.5m)

Bedroom Three 8'4" x 7'5" (2.54m x 2.26m)

Bathroom 7'2" x 5'7" (2.18m x 1.7m)

Lobby 7'7" x 6'1" (2.3m x 1.85m)

EPC Rating: C

Council Tax Band: B (tbc by solicitors).

Tenure: To be advised (tbc by solicitors).

For more information or to arrange a viewing, please call us on 01384 319 400.



How can we help you?

Need a mortgage?

We recommend Wiser Mortgage Advice. They will search the market for you to ensure you get the right lender and mortgage deal. They typically achieve mortgage offers much more quickly than if you were dealing with lenders directly. The initial appointment is free and without obligation. Call us on 01384 319 400, or visit their website for more information: www.wisermortgageadvice.co.uk

Property to sell?

If you need to sell a property in order to buy, you ideally need to be on the market at least (and preferably Sold STC) before viewing, otherwise you may lose out to other buyers when the right property comes along. In these circumstances we can get your property 'live' quickly. Just book a free valuation and we will visit your property and discuss your needs.

Need a solicitor?

A good solicitor can save you literally weeks of time in the buying/selling process, reducing the stress levels of all involved. We will instruct a reputable firm that is competitive on cost and very reliable. Just ask for a quote.

Need a removal company and storage?

A professional removal company takes the stress out of moving, knowing that your belongings are safe and insured far outweighs any small savings by trying to do it yourself or using a man-and-a-van service. We work closely with and recommend Cube Removals as the leading local firm. For peace of mind and a reliable service call them on 0800 193 0000 or visit their website, cuberemovals.co.uk, to arrange a survey.

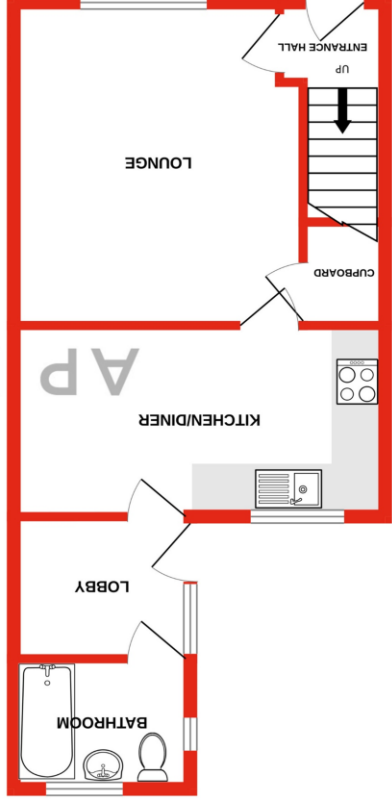

GROUND FLOOR (40.8 sq.m.) approx.

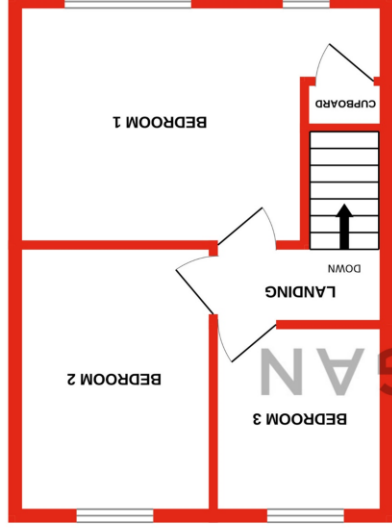

1ST FLOOR (32.6 sq.m.) approx.

Every attempt has been made to ensure the accuracy of the floorplan contained here. Measurements of doors, windows, rooms and other items are approximate and no responsibility is taken for any error or omission or mis-statement. This plan is illustrative purposes only and should be used as such by any prospective purchaser. The services, systems and appliances shown have not been tested and no guarantee as to their operability or efficiency can be given. Made with Metropix e2024

No statement in these details is to be relied upon as representation of fact, and purchasers should satisfy themselves by inspection or otherwise as to the accuracy of the statements contained within. These details do not constitute any part of any offer or contract. AP Morgan and their employees and agents do not have any authority to give any warranty or representation whatsoever in respect of this property. These details and all statements herein are provided without any responsibility on the part of AP Morgan or the vendors. Equipment: AP Morgan has not tested the equipment or central heating system mentioned in these particulars and the purchasers are advised to satisfy themselves as to the working order and condition. Measurements: Great care is taken when measuring, but measurements should not be relied upon for ordering carpets, equipment, etc. The Laws of Copyright protect this material. AP Morgan is the Owner of the copyright. This property sheet forms part of our database and is protected by the database right and copyright laws. No unauthorised copying or distribution without permission.