

AP MORGAN



Great Stone Road, Birmingham, West
Offers in the region of £215,000

Features:

- Refurbished semi-detached house
- Two double bedrooms
- Spacious lounge/dining room
- Convenient sized kitchen and separate utility
- Bathroom
- Large rear garden
- Two car driveway
- EPC- D

Description:

This recently refurbished two-bedroom semi-detached house is located on a sought-after road in Northfield, Birmingham. Ideal for first time buyers looking for a house that's ready to move into with a stylish décor and amenities including shops, schools and public transport links all located nearby.

Upon approach to the property there is multi-car driveway with a side entry providing access into the utility room which is also a sheltered walkway into the rear garden.

Moving inside, the property briefly comprises of a welcoming entrance porch and hallway, spacious and open plan lounge/diner with bay window and rear door for access into the garden, convenient sized kitchen with integrated oven and hob as well as side door into the utility room, first floor landing, two double bedrooms with the master bedroom benefiting from a built in airing/storage cupboard, finally a convenient sized bathroom with bath and shower mixer.

The rear garden is a very good size comprising of a spacious patio and decking area ideal for outdoor furnishings as well as a large lawn with shed at the rear for additional storage space.

This property boasts an excellent location in Northfield, within proximity of Northfield train station. Nearby Northfield town centre features a wide range of local amenities and shops. The property is also conveniently positioned for travel via road and rail to Birmingham city centre, the Queen Elizabeth Hospital, and the University of Birmingham. The property is in catchment for several well regarded primary and secondary schools, including St



Laurence Primary and the outstanding rated secondary schools Kings Norton Girls and St Thomas Aquinas.

Details:

Porch

Hallway

Lounge/diner 21'2" x 9'11" (max) (6.45m x 3.02m (max))

Kitchen 9' x 6'4" (2.74m x 1.93m)

Utility Room 16'10" x 3'9" (5.13m x 1.14m)

Landing

Bedroom One 12'8" x 12'7" (3.86m x 3.84m)

Bedroom Two 9'6" x 7'11" (2.9m x 2.41m)

Bathroom 6'9" x 5'10" (2.06m x 1.78m)

EPC Rating: D

Council Tax Band: B (tbc by solicitors).

Tenure: Freehold (tbc by solicitors).

For more information or to arrange a viewing, please call us on 0121 827 6827.



How can we help you?

Need a mortgage?

We recommend Wiser Mortgage Advice. They will search the market for you to ensure you get the right lender and mortgage deal. They typically achieve mortgage offers much more quickly than if you were dealing with lenders directly. The initial appointment is free and without obligation. Call us on 0121 827 6827, or visit their website for more information: www.wisermortgageadvice.co.uk

Property to sell?

If you need to sell a property in order to buy, you ideally need to be on the market at least (and preferably Sold STC) before viewing, otherwise you may lose out to other buyers when the right property comes along. In these circumstances we can get your property 'live' quickly. Just book a free valuation and we will visit your property and discuss your needs.

Need a solicitor?

A good solicitor can save you literally weeks of time in the buying/selling process, reducing the stress levels of all involved. We will instruct a reputable firm that is competitive on cost and very reliable. Just ask for a quote.

Identity Checks

Estate Agents are required by law to conduct anti-money laundering checks on all those buying a property. We have partnered with a third party supplier to undertake these who will contact you once you have had an offer accepted on a property you wish to buy. The cost of these checks is £39 + VAT per buyer and this is a non-refundable fee. These charges cover the cost of obtaining relevant data, any manual checks and monitoring which might be required. This fee will need to be paid and the checks completed in advance of the issuing of a memorandum of sale on the property you would like to buy.

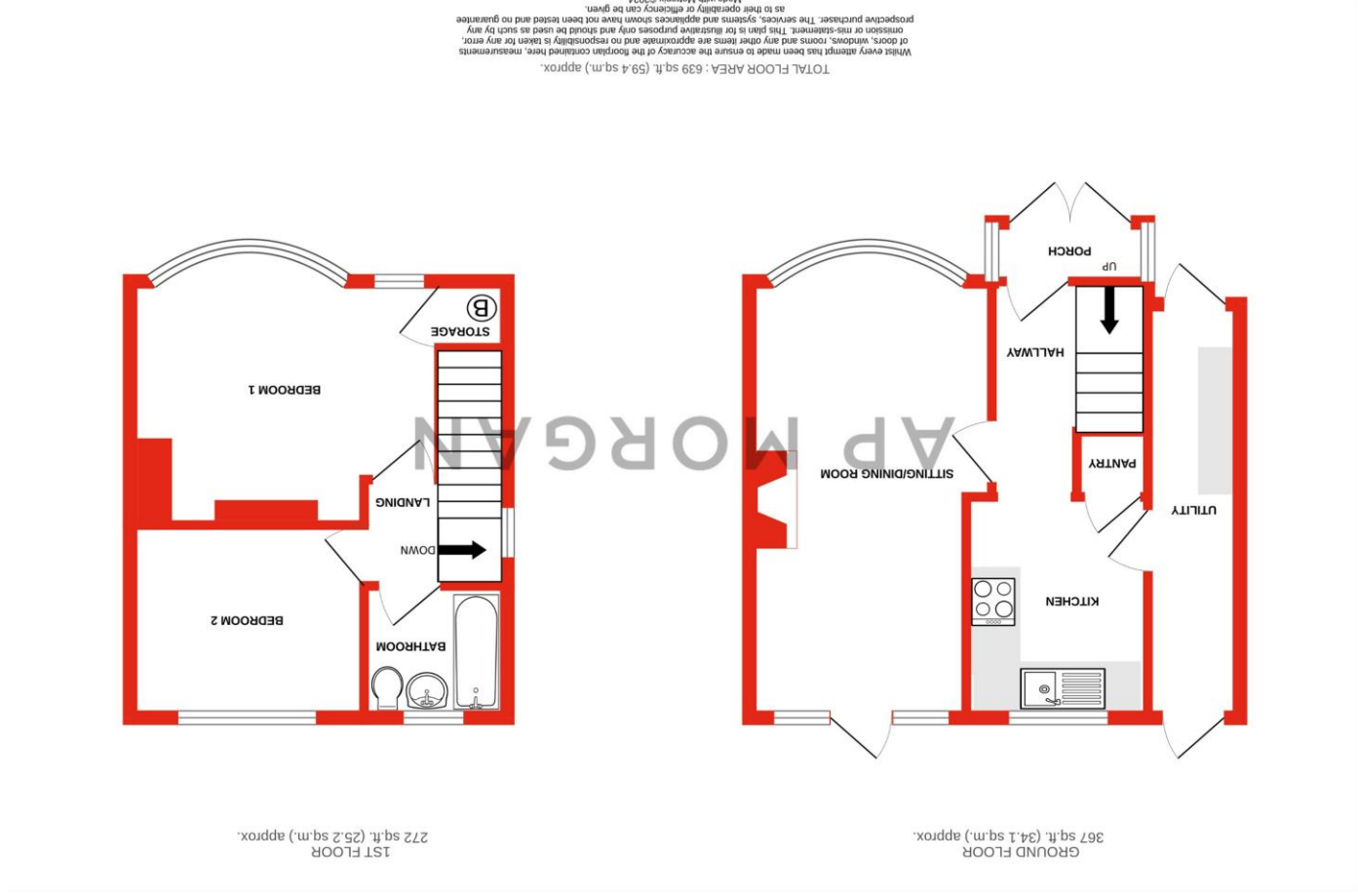

No statement in these details is to be relied upon as representation of fact, and purchasers should satisfy themselves by inspection or otherwise as to the accuracy of the statements contained within. These details do not constitute any part of any offer or contract. AP Morgan and their employees and agents do not have any warranty or representation whatsoever in respect of this property. These details and all statements herein are provided without any responsibility on the part of AP Morgan or the vendors. Equipment: AP Morgan has not tested the equipment or central heating system mentioned in these particulars and the purchasers are advised to satisfy themselves as to the working order and condition. Measurements: Great care is taken when measuring, but measurements should not be relied upon for ordering carpets, equipment, etc. The Laws of Copyright protect this material. AP Morgan is the Owner of the copyright. This property sheet forms part of our database and is protected by the database right and copyright laws. No unauthorised copying or distribution without permission.