



Flat 38, Uplands House, Four Ashes Road, Cryers Hill, High Wycombe, HP15 6DY

Asking Price | £1,300

Property Features

- Panoramic Views of Hughenden Valley
- Grade II Listed Building
- Open Plan Living Room/Kitchen
- One Bedroom
- Modern Shower Room
- Set within 18 acres of Landscaped Grounds
- Allocated Parking Set within Secure Gates
- Furnished
- Climate Control App
- Available Late March

Full Description

This splendid one bedroom first floor apartment is situated within the modern section of this Grade II Listed development and is nestled in an idyllic area of natural beauty in Four Ashes, High Wycombe.

Set within 18 acres of stunning landscaped grounds, the Uplands House Development consists of a historic Victorian Country House which was originally built over 150 years ago with a later, modern addition to the development which was used as a conference centre and hotel by the De Vere group.

This apartment has an expansive light filled kitchen/living room with views of the landscaped gardens and valley beyond. The fitted Italian designed kitchen features quartz worktops, storage cupboards and open shelving.

The apartment boasts a generously sized bedroom with panoramic windows overlooking the gardens below. The high specification shower room is of Italian design.

This executive apartment is set behind security gates with CCTV and comes with an allocated parking and access to the beautifully maintained 18 acres of landscaped communal grounds which include lawned areas and woodland pathways. This unique feature allows residents to immerse themselves in the tranquillity of their natural surroundings, providing a haven of peace and serenity.

Council Tax Band B





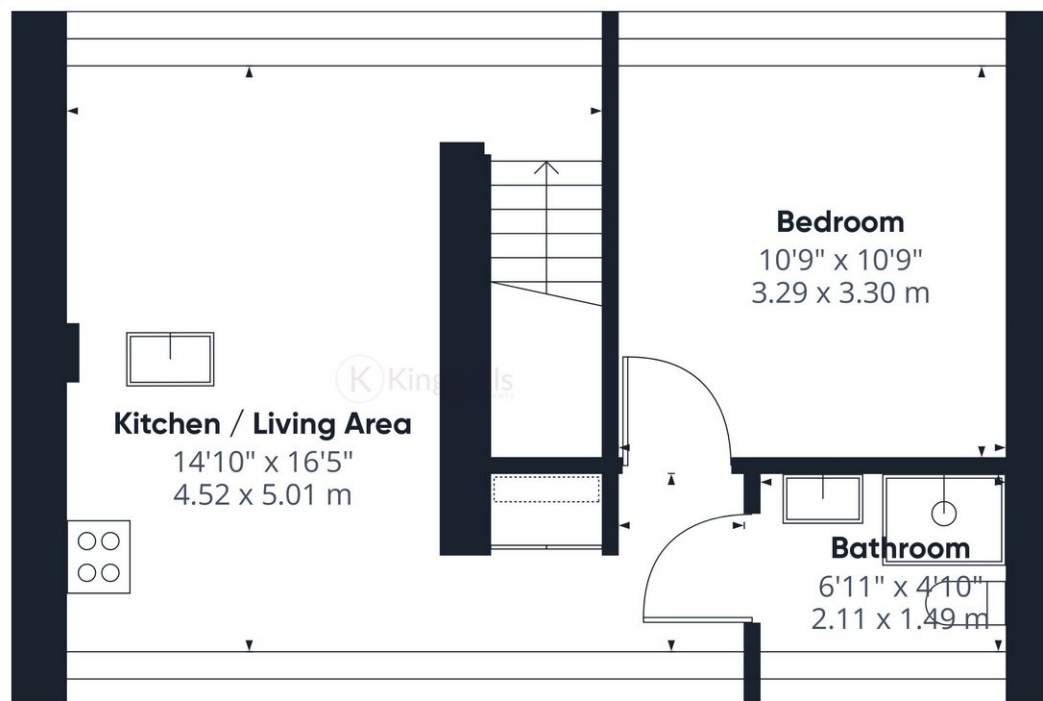

Floor 1

Approximate total area⁽¹⁾
374.08 ft²
34.75 m²

(1) Excluding balconies and terraces

While every attempt has been made to ensure accuracy, all measurements are approximate, not to scale. This floor plan is for illustrative purposes only.

GIRAFFE360