



Property Features

- Character Cottage
- Well Presented and Re-modernised
- Bay Fronted Living Room with Feature Fireplace
- 3 Bedrooms
- Downstairs bathroom
- Dining room
- On Street Parking
- Private Enclosed South Facing Rear Garden
- Ideally Located in Picturesque Wooburn Green
- EPC 64D / Council Tax D

Full Description

This character three-bedroom terraced cottage is situated in the charming village of Wooburn Green, ideally located between the towns of Beaconsfield and High Wycombe in Buckinghamshire. The property boasts traditional charm and character making it the perfect home for those seeking a quiet and peaceful escape from the hustle and bustle of city life. No onward chain.

Upon entering the property, you are greeted by a welcoming spacious living room with a beautiful feature fireplace and plenty of natural light flooding in through the large sash windows. The dining room is equally impressive, offering ample space for entertaining guests. The kitchen is located to the rear of the house with access to the garden and also offers a downstairs bathroom.

Upstairs, there are three bedrooms, two of the rooms are double rooms with a further bedroom located directly off of the 2nd bedroom. Outside, the property has a picturesque south facing cottage garden, which is beautifully landscaped, providing a private space for outdoor dining and relaxation.

Wooburn Green is a charming village in the heart of Buckinghamshire, offering a variety of local shops and amenities, including a post office, local convenience store, doctor's surgery, and pharmacy. There are also several excellent restaurants and pubs in the nearby area, offering great food and drink. The nearby towns of Beaconsfield and High Wycombe both offer excellent transport links to London and beyond, with regular trains to London Marylebone in just 30 minutes.

Beaconsfield is a bustling and vibrant town known with numerous restaurants, cafes and pubs with a range of specialty shops, boutiques, cafes and restaurants, showcasing the best of modern luxury and fashion trends. Nearby High Wycombe is home to a variety of high street shops, cinemas, and cultural attractions, including the Wycombe Swan Theatre and the Hughenden Manor National Trust property.

Overall, this property represents an excellent opportunity to purchase a stunning home in an idyllic village setting, with easy access to the bustling towns of Beaconsfield and High Wycombe and beyond.





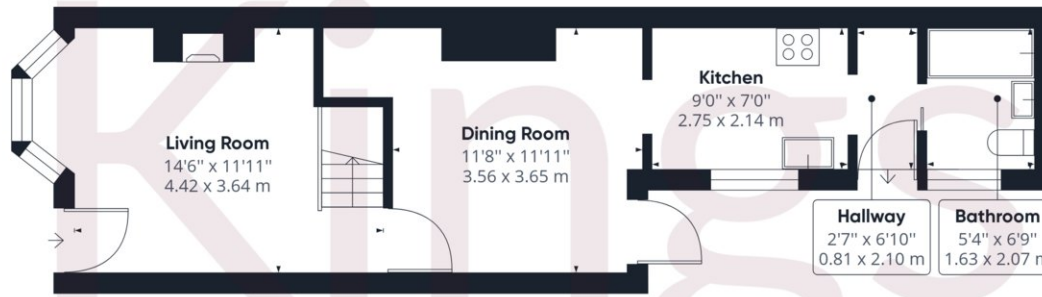

Ground Floor

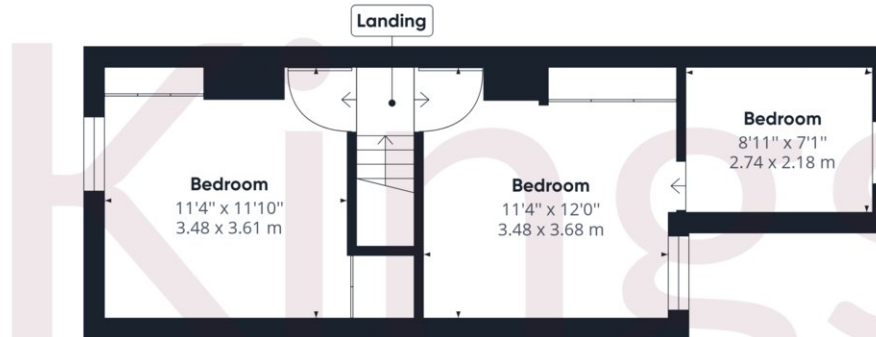

Floor 1

Approximate total area⁽¹⁾

779.01 ft²

72.37 m²

(1) Excluding balconies and terraces

While every attempt has been made to ensure accuracy, all measurements are approximate, not to scale. This floor plan is for illustrative purposes only.

GIRAFFE360