



Sportsman Cottage, Speen Road, North Dean, High Wycombe, HP14 4NL

Asking Price | £425,000

Property Features

- Beautiful Grade II Listed Cottage
- Located in Sought After Village
- Living Room with Cosy Fireplace
- Fitted Kitchen and Dining Room
- Downstairs WC/Cloakroom
- 2 Bedrooms to the First Floor
- Newly fitted and Upgraded Bathroom
- Gardens with views over Allotments and Open Countryside
- Off Road Parking
- EPC Exempt / Council Tax Band D

Full Description

A charming Grade II listed Buckinghamshire cottage located in one of the areas most sought after villages, North Dean. This beautiful period property has been extended over recent years to create the perfect cosy home and has views from the garden over allotments and open countryside.

Accommodation

Living room with multi fuel burning fireplace and wood flooring, dining room with understairs 'Dog Room', a light and bright fitted kitchen with built in appliances and wooden work tops. From the kitchen there is a stable door leading to the side passageway which in turn leads to the garden. To the first floor there are 2 bedrooms with the main bedroom overlooking the front. The bathroom has recently been replaced and upgraded with underfloor heating. From the landing there is a loft ladder that leads to the fully boarded and carpeted loft which is ideal to create a further useable space. Planning permission has been granted (Buckinghamshire Council - Wycombe Area Ref No 15/07634/LBC).

Outside

The rear garden is off set to the house but has lovely views over allotments and open countryside with garden shed and log store. Part of the garden is currently being used to house chickens.

To the front there is parking for one car, however there is informal parking at the village hall.

EPC Exempt









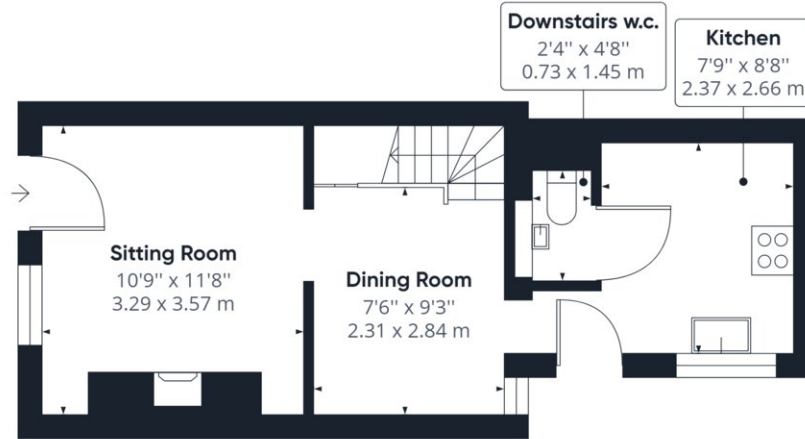

Ground Floor

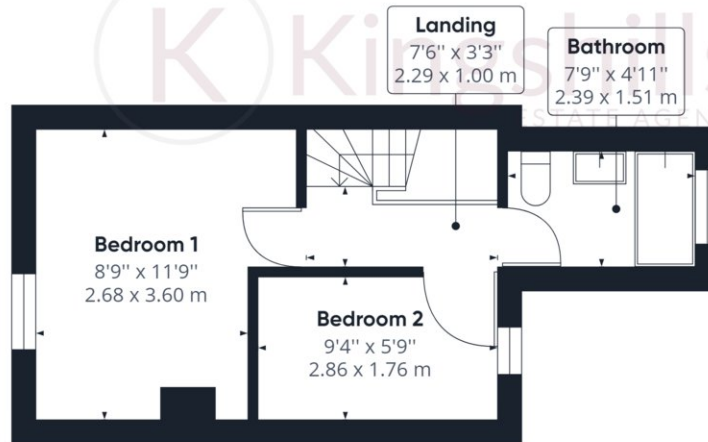

Floor 1

Approximate total area⁽¹⁾

537.92 ft²
49.97 m²

(1) Excluding balconies and terraces

While every attempt has been made to ensure accuracy, all measurements are approximate, not to scale. This floor plan is for illustrative purposes only.

GIRAFFE360