



Property Features

- Modern 'Attic Style' Apartment
- Panoramic Views of High Wycombe
- Vaulted Ceilings and Exposed Beams
- 2 Double Bedrooms
- 2 Bathrooms (1 Ensuite)
- Living Area with Balcony
- Modern Kitchen with Appliances
- Entry Phone System and Gas Rads
- Allocated Parking
- EPC 79C / Council Tax Band C

Full Description

Welcome to 15 River Court, High Wycombe - a distinctive top-floor 2 bedroom 'attic style' apartment that seamlessly blends modern living with historic charm. This unique residence, converted in 2018 by a renowned local developer, stands out as one of only two apartments in the building with vaulted ceilings and exposed beams, offering a character-filled living experience.

Step into the heart of this home, where a modern open-plan living room, kitchen, and breakfast room await. The kitchen area boasts fitted appliances, ensuring both style and functionality along with a large walk in pantry. Enjoy the beauty of high ceilings and ample natural light as you entertain or relax in this welcoming space. Double glass doors lead to a generous balcony, providing a perfect vantage point for panoramic views over High Wycombe.

The two double bedrooms are thoughtfully designed, each featuring fitted storage units that combine practicality with elegance with bedroom 2 benefiting from mezzanine storage. The main bedroom further indulges its occupants with a luxurious en-suite, offering a private retreat within the apartment. A second modern bathroom serves the rest of the living space, providing convenience for residents and guests alike.

Security is a priority, and the property features a reliable Entry Phone System, offering peace of mind to residents. Allocated parking adds a practical touch, ensuring a hassle-free arrival home. The apartment is equipped with gas radiator heating, providing efficient warmth throughout the colder months.

Discover the perfect blend of contemporary design and historic charm at 15 River Court. With its unique features, spacious layout, and stunning views, this apartment offers a one-of-a-kind living experience in the heart of High Wycombe.

This apartment at 15 River Court is not just a home; it's a lifestyle choice that combines the best of modern living with the charm of a historic town.





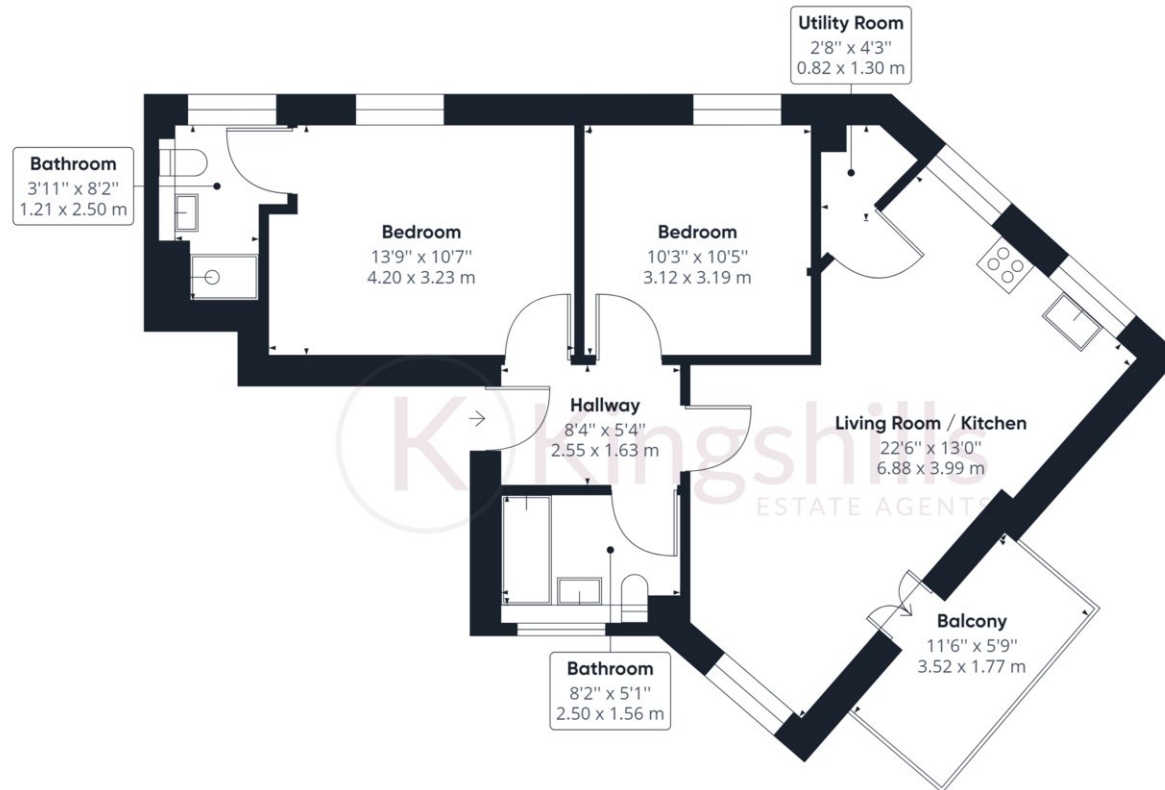

Approximate total area⁽¹⁾

686.46 ft²
63.77 m²

(1) Excluding balconies and terraces

While every attempt has been made to ensure accuracy, all measurements are approximate, not to scale. This floor plan is for illustrative purposes only.

GIRAFFE360