



The Mount, 50 Amersham Hill, High Wycombe, Buckinghamshire, HP13 6PQ

Guide Price | £1,000,000

Property Features

- Iconic Detached Family Home
- Said to be built in the 1930's
- 4/5 Bedrooms
- Ensuite to Principal Bedroom
- Stunning Dual Aspect Living Room
- Kitchen/Breakfast Room
- Separate Dining Room
- Enclosed Gardens with Outside Office
- Ample Parking plus Garage
- Awaiting EPC / Council Tax Band E

Full Description

Welcome to The Mount, a distinguished property with a rich history dating back to the 1930s, when it served as a hospital in the heart of High Wycombe. Now transformed into a delightful detached home, this iconic building offers superb accommodation spread across three floors.

Upon entering, you are greeted by a stunning and inviting Entrance Hall, leading to all main living areas. The Drawing Room, featuring high ceilings and a magnificent fireplace, is double aspect with a bay window to the front and doors opening onto the rear decking area. The Dining Room boasts high ceilings, wooden flooring, and a 'see through' fireplace connecting to the Kitchen/Breakfast Room, equipped with modern appliances. Steps lead to the Scullery, Utility Room, and W.C.

The first floor hosts four generous bedrooms located off of a split staircase, with the Principal bedroom featuring an ensuite shower room and a circular dressing area. Bedrooms 2 and 3 come with fitted wardrobes, while Bedroom 4 has stairs leading to a charming loft room/bedroom 5 – perfect for a teenager. The split landing offers a modern bathroom and a study.

Outside, the rear garden is a haven, featuring a superb seating and decking area, space for a hot tub, and shed storage. A modern Log style cabin at the garden's rear serves as an ideal outside office or family room. The front of the property provides ample parking space for several cars, with a driveway leading to the garage.

The Mount is not just a home; it's an iconic structure in High Wycombe, and there's potential to extend further, subject to the usual permissions.

For those commuting, the property is conveniently located near High Wycombe Train Station. The station offers excellent connectivity to Marylebone, with frequent train services ensuring a quick and convenient commute.

High Wycombe is also home to prestigious private schools, including Wycombe Abbey and Godstowe School, known for their academic excellence and nurturing environments. Additionally, John Hampden and Royal Grammar School provide outstanding educational opportunities for students in the area. The proximity of these esteemed institutions adds to the overall appeal of The Mount, making it an ideal residence for families seeking both history and modern comfort in High Wycombe.









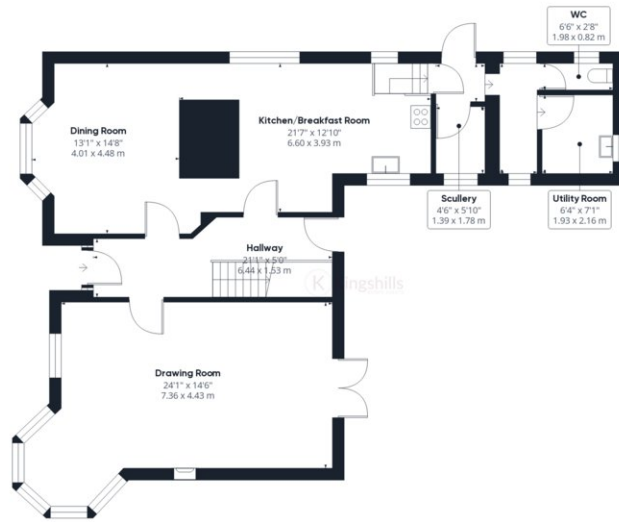

Ground Floor Building 1

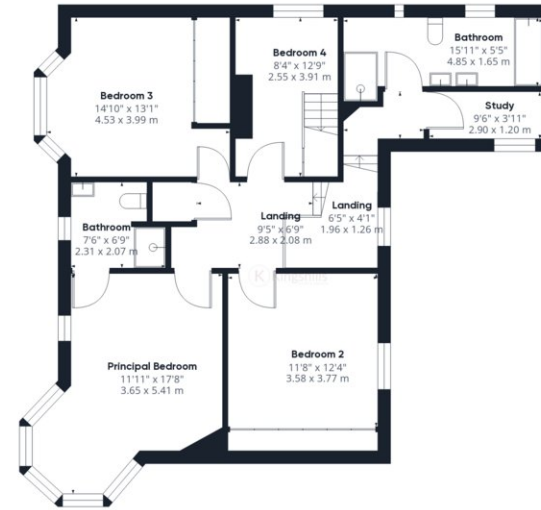

Floor 1 Building 1



Floor 2 Building 1



Ground Floor Building 2

Approximate total area[†]
2457.78 ft²
228.33 m²

Excluding balconies and terraces

While every attempt has been made to ensure accuracy, all measurements are approximate, not to scale. This floor plan is for illustrative purposes only.

GIRAFFE360