



Hawthorn Crescent, Hazlemere, High Wycombe, Buckinghamshire, HP15 7PJ

Asking Price | £400,000

## Property Features

---

- End of Terraced Home
- Vastly Improved by the current owners
- Catchment of highly regarded Schools
- Inviting Hallway and Living Room
- Kitchen/Breakfast Room
- 3 Bedrooms
- Refitted Bathroom
- Enclosed and Private rear Gardens
- Garage Located close by
- EPC 72 C / Council Tax Band D

## Full Description

---

Welcome to Hawthorn Crescent, located within the sought-after Manor Farm development in Hazlemere. This charming 3 bedroom end-of-terrace home presents an ideal opportunity for comfortable family living, boasting proximity to esteemed schools with essential amenities within walking distance.

As you step inside, you're greeted by a spacious hallway, setting the tone for the inviting ambiance that permeates throughout the residence. To the right, the inviting living room offers a cozy retreat for relaxation and entertainment, perfect for unwinding after a long day.

Continuing through the hallway, you'll discover the heart of the home - a newly fitted kitchen/breakfast room. This modern space is thoughtfully designed, providing ample room for culinary endeavors and casual dining experiences. Whether preparing meals for the family or hosting gatherings with friends, this area caters to your every need and with doors leading on to the rear garden.

Ascending to the first floor, you'll find three generously sized bedrooms, each offering comfortable accommodation. A well-appointed family bathroom completes this level, providing convenience and functionality for the entire household.

Stepping outside, the property boasts a generously sized enclosed garden, providing a serene outdoor retreat, play, or relaxation. The patio area offers the perfect spot for summer barbecues or simply enjoying the tranquil surroundings.

For added convenience, a garage is located within a nearby block, providing secure parking and additional storage space.

In summary, 22 Hawthorn Crescent presents an exceptional opportunity to acquire a beautifully improved home in a highly desirable location. Whether you're a growing family seeking proximity to schools and amenities or simply looking for a comfortable retreat to call your own, this property offers the perfect blend of style, comfort, and convenience. Don't miss your chance to make this your new home sweet home. Schedule your viewing today!







Ground Floor

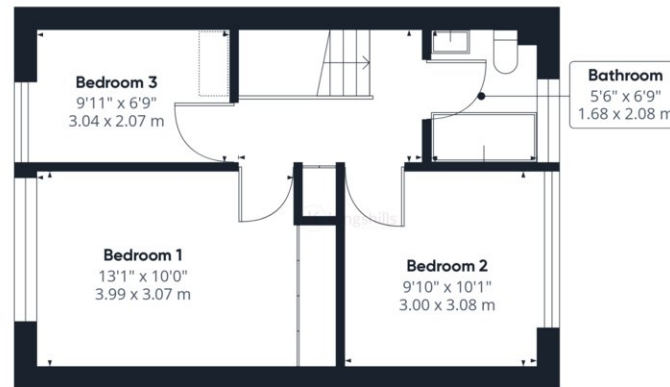

Floor 1

Approximate total area<sup>(1)</sup>  
852.76 ft<sup>2</sup>  
79.22 m<sup>2</sup>

(1) Excluding balconies and terraces

While every attempt has been made to ensure accuracy, all measurements are approximate, not to scale. This floor plan is for illustrative purposes only.

GIRAFFE360